

INSTRUCTION

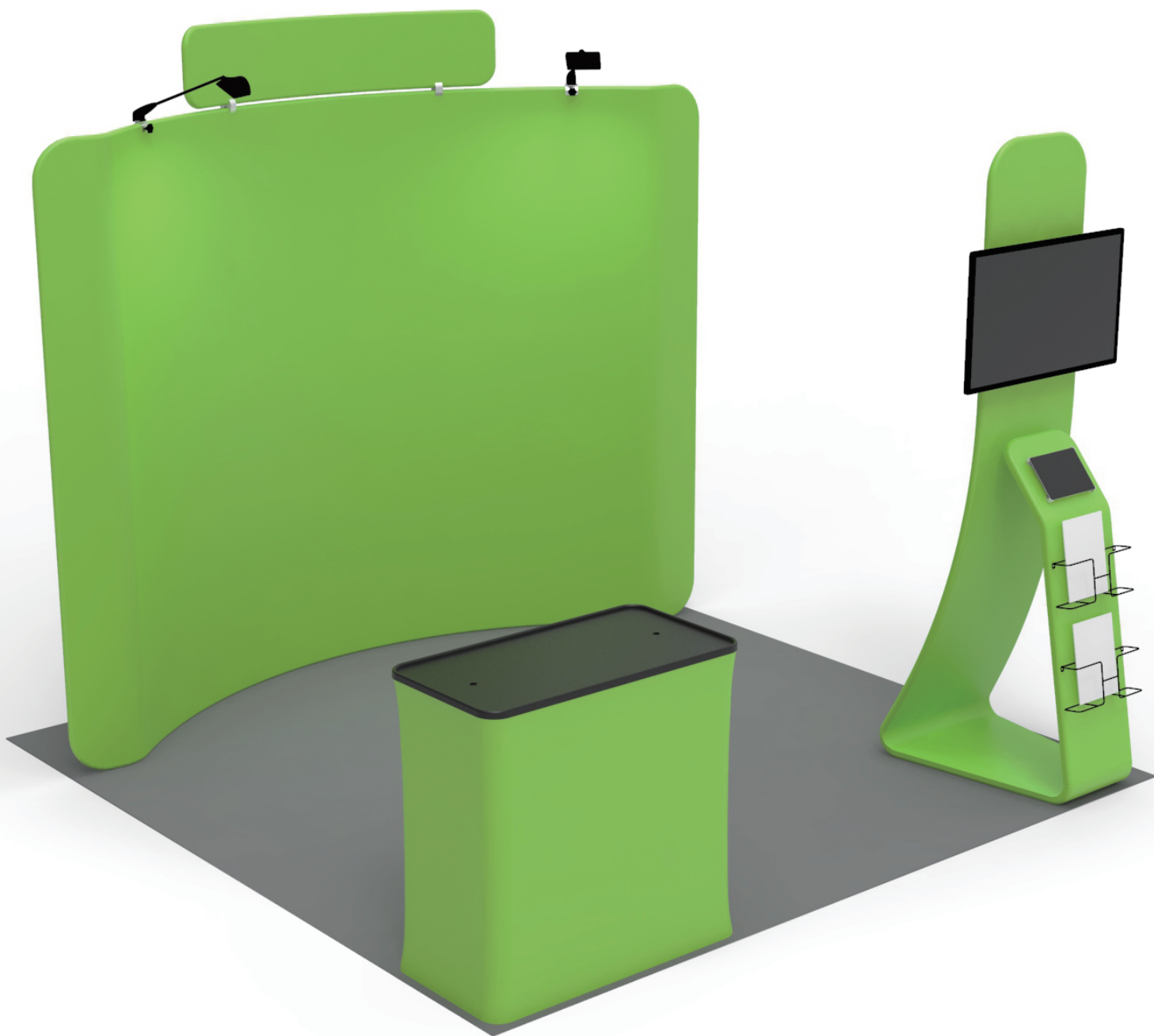

TF-SB-10X10-28

STEPS

(1) Hardware

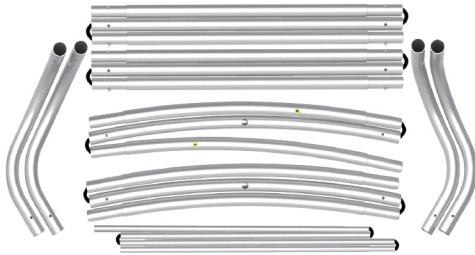

(2) Printed Graphic Fabric Banner (Optional)



STEP 01

Connect to make long poles according to labelings.

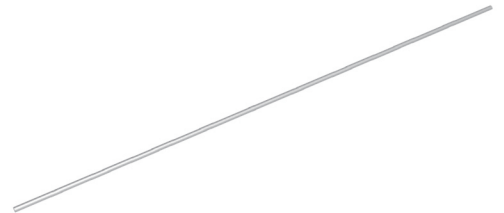
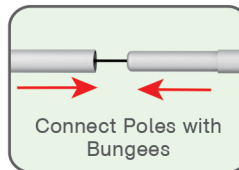
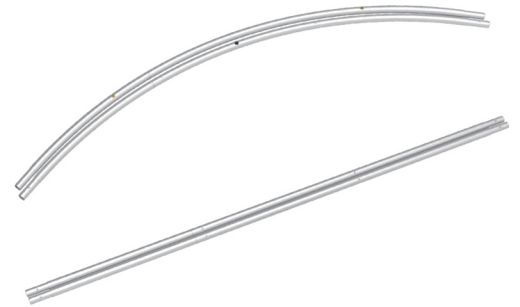
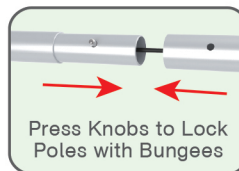
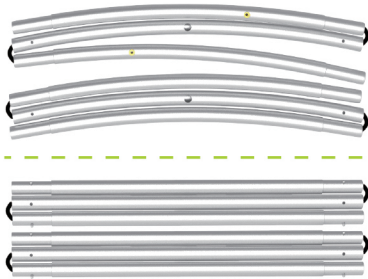

STEP 02

Connect long poles with corner poles according to labelings.

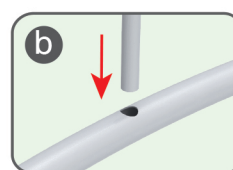
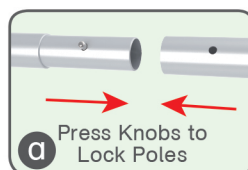
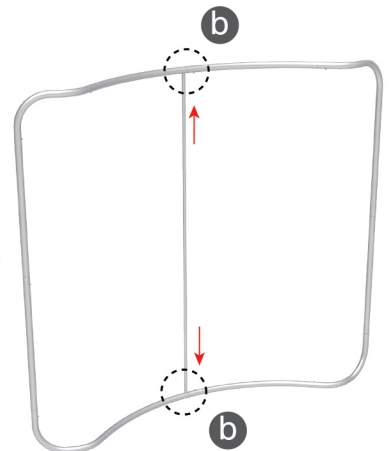
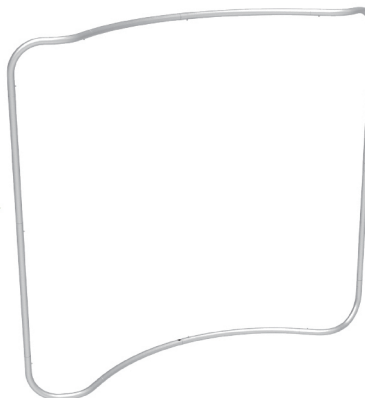
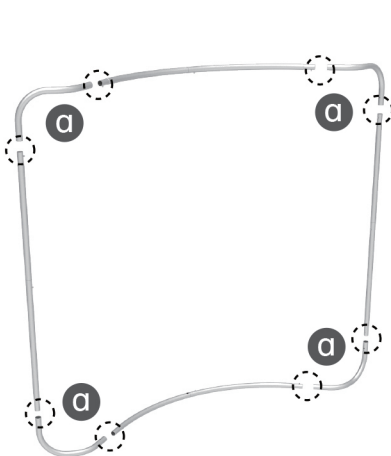

STEPS

STEP 03 Slide fabric banner on frame from top and zip up at bottom.

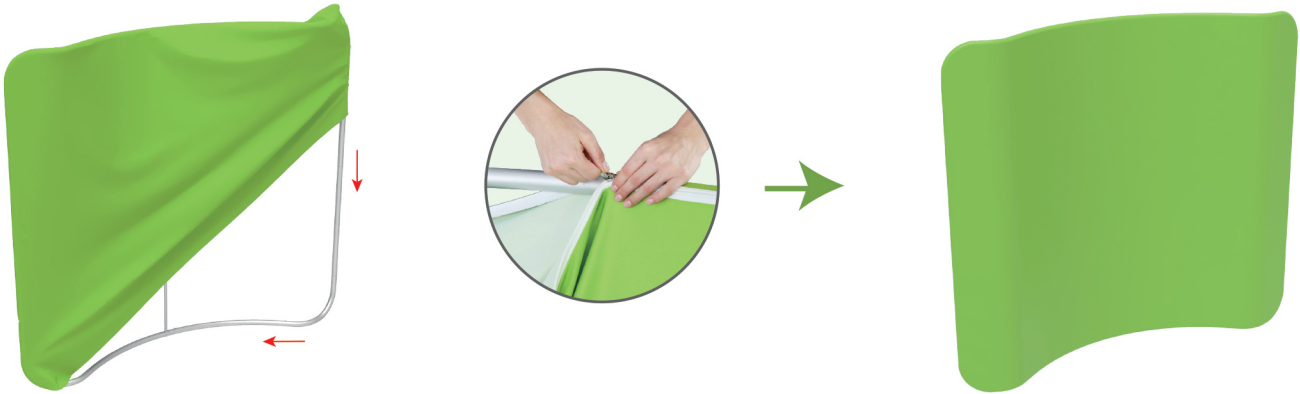

(1) Hardware

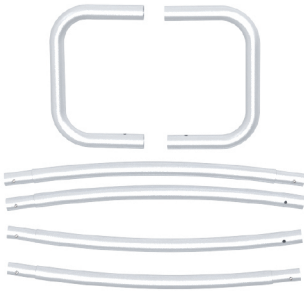

(2) Printed Graphic Fabric Banner (Optional)

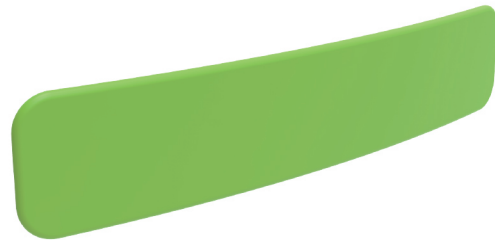

STEP 01 Connect poles according to labelings.

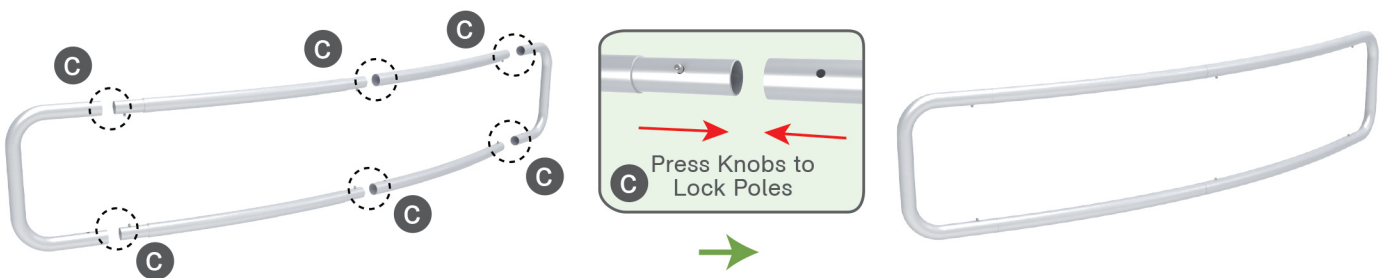

STEP 02 Slide fabric banner on frame from left and zip up at right.



★ One Tool (Hex Wrench) 

STEPS

Booth Set Assembly



(1) LED Light & Clip

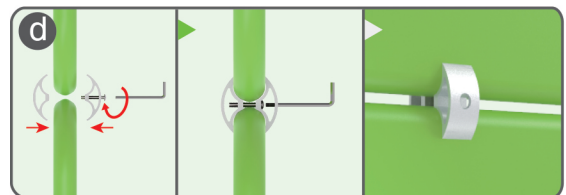
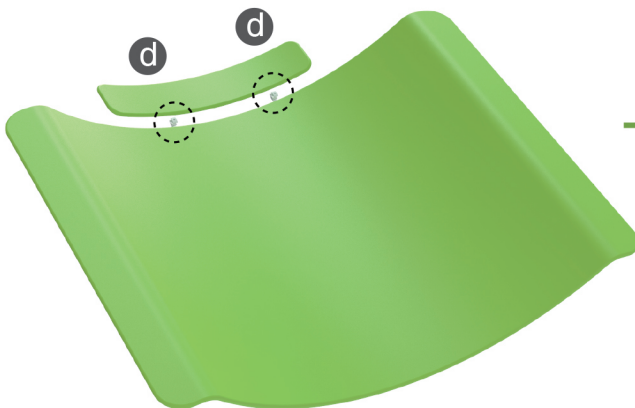
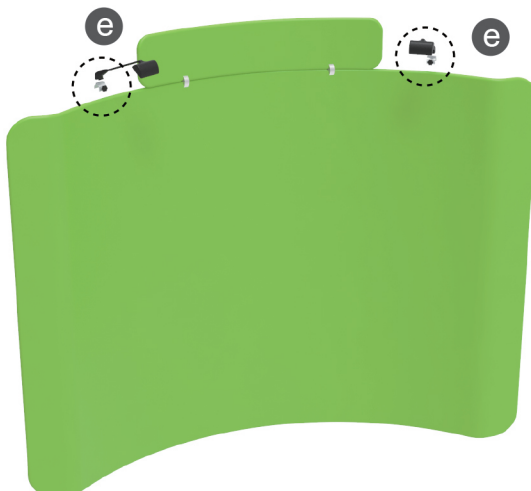
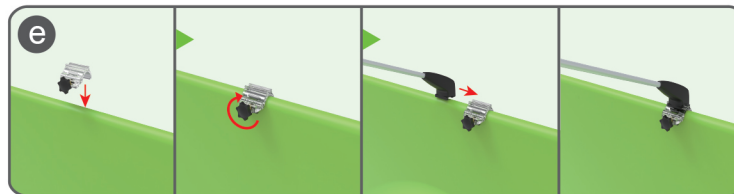

(2) 180° C-Shaped Clip

**STEP 01** Interconnect display stands with C-shaped clips.**STEP 05** Screw light clips at top of display stands, slide lights onto them and adjust their direction.

STEPS

(1) Durable Plastic Hard Case, Aluminum Support Poles



(2) Printed Graphic Fabric Banner



STEP 01

Put hard case's top into fabric banner.

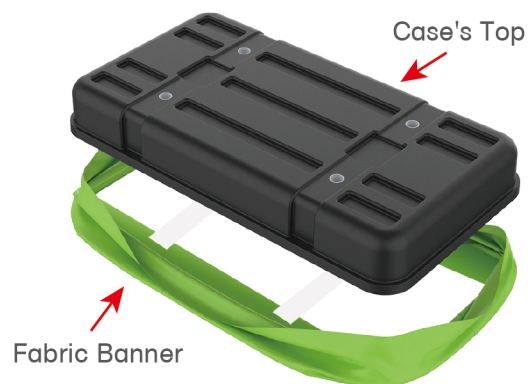

STEP 02

Insert support poles into hard case's top & bottom.

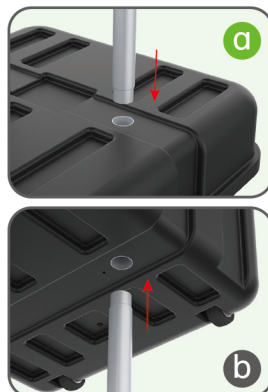
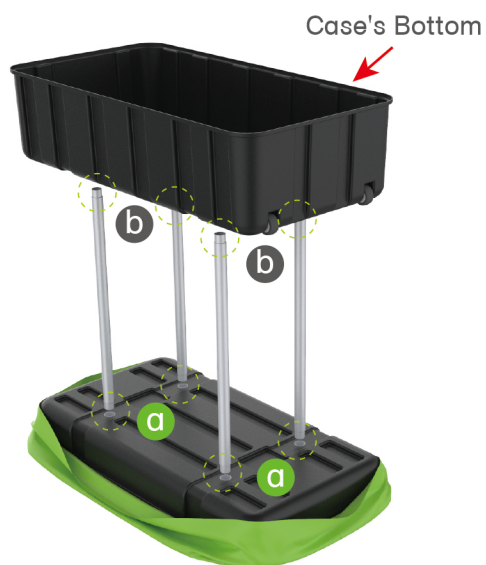

STEPS

STEP 04

Wrap fabric banner from bottom to top & twist it to be smooth, lay hard case's intermediate panel on podium's top.

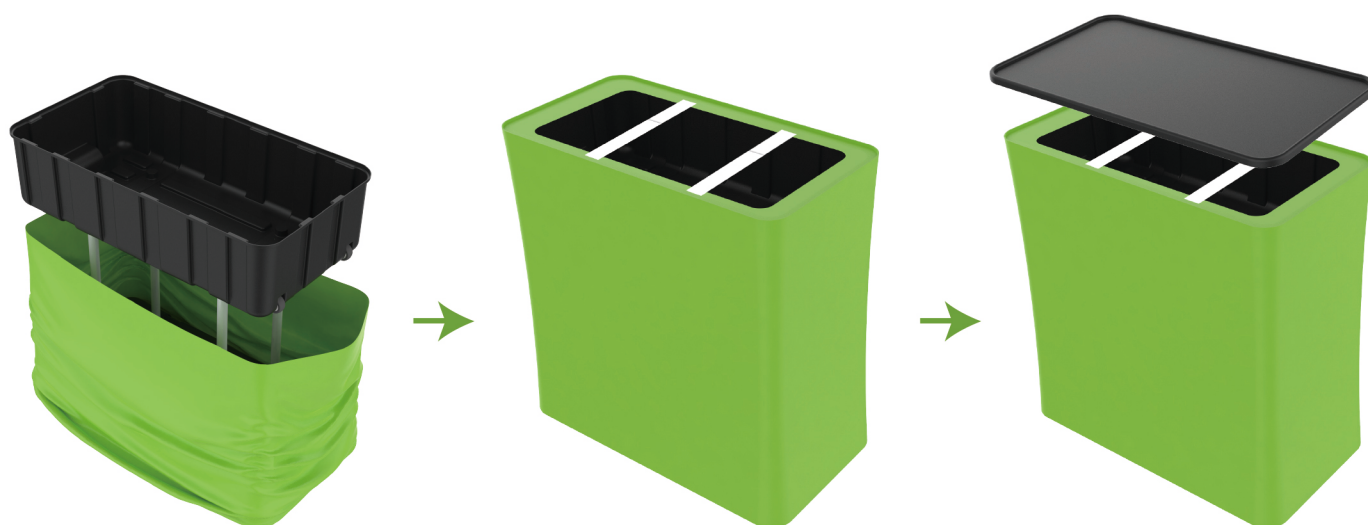

STEPS

(1) Hardware

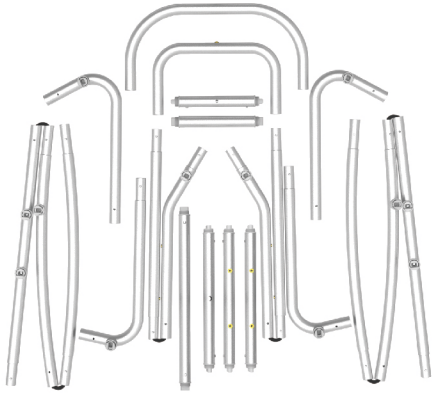

(2) Fabric banner



(3) TV mount x1 / Brochure rack x2 Tablet PC holder x1

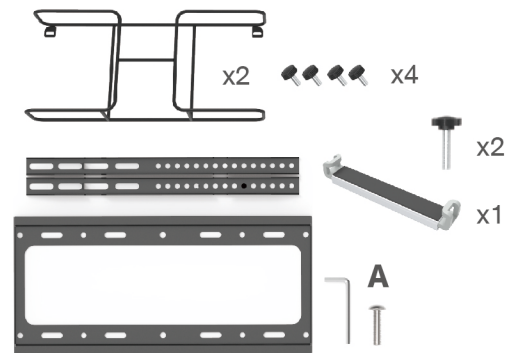

STEP 01

To connect the poles according to the labellings

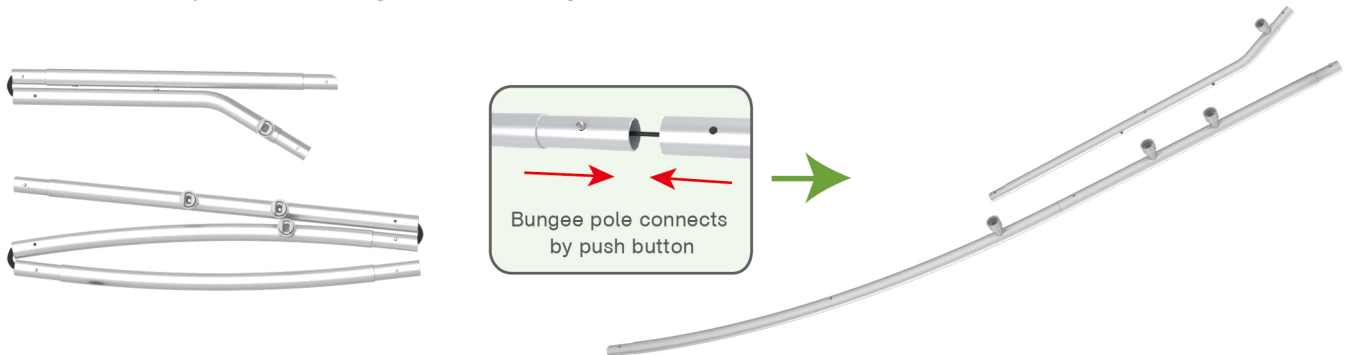

STEP 02

To use corner pieces to connect the poles to be display stand

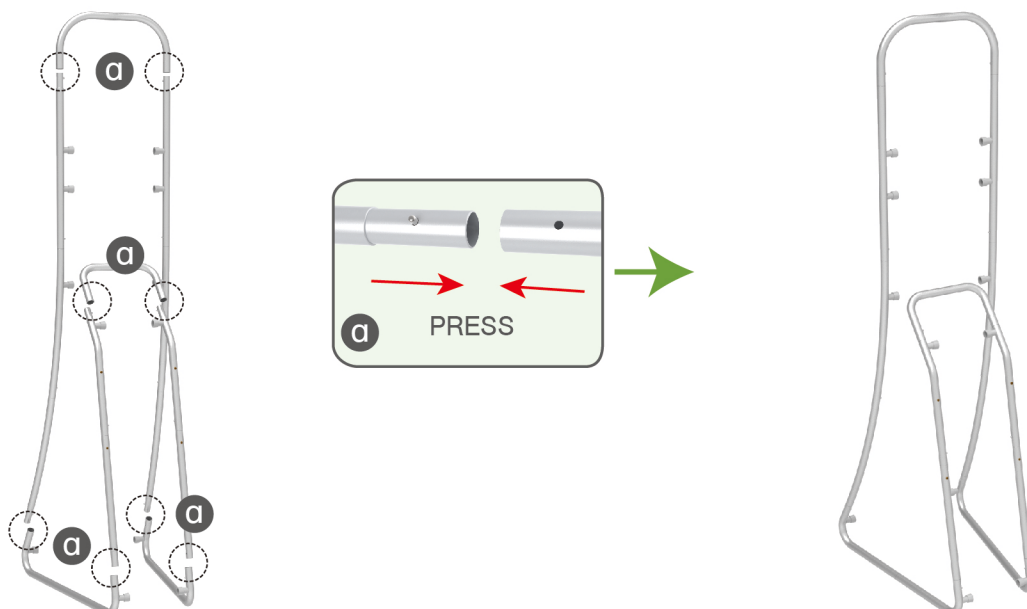

STEPS

STEP 03

To install the cross bar according to labellings

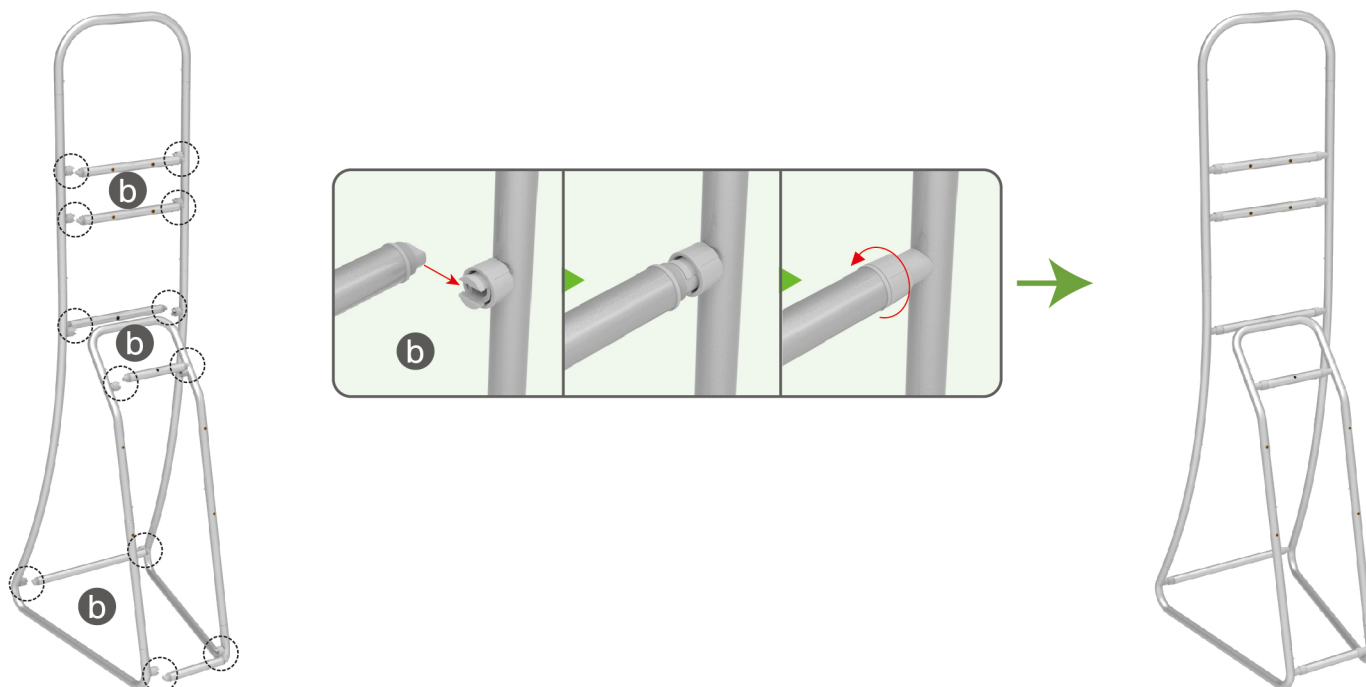

STEP 04

To wrap the fabric from ipad end to the top where the TV located and zip up, afterwards use big screw for fastening the whole unit

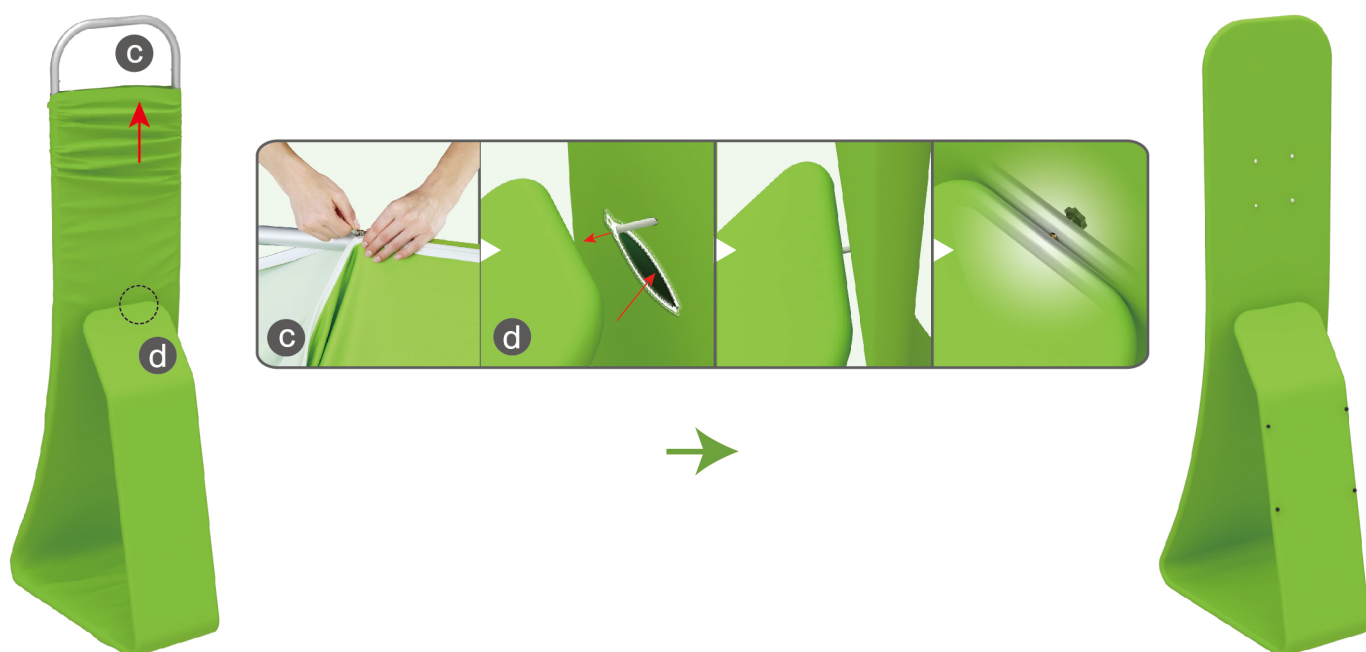

STEPS

STEP 04

Wrap fabric banner from front top and zip up at back top, screw to interconnect back middle cross bar with front top.

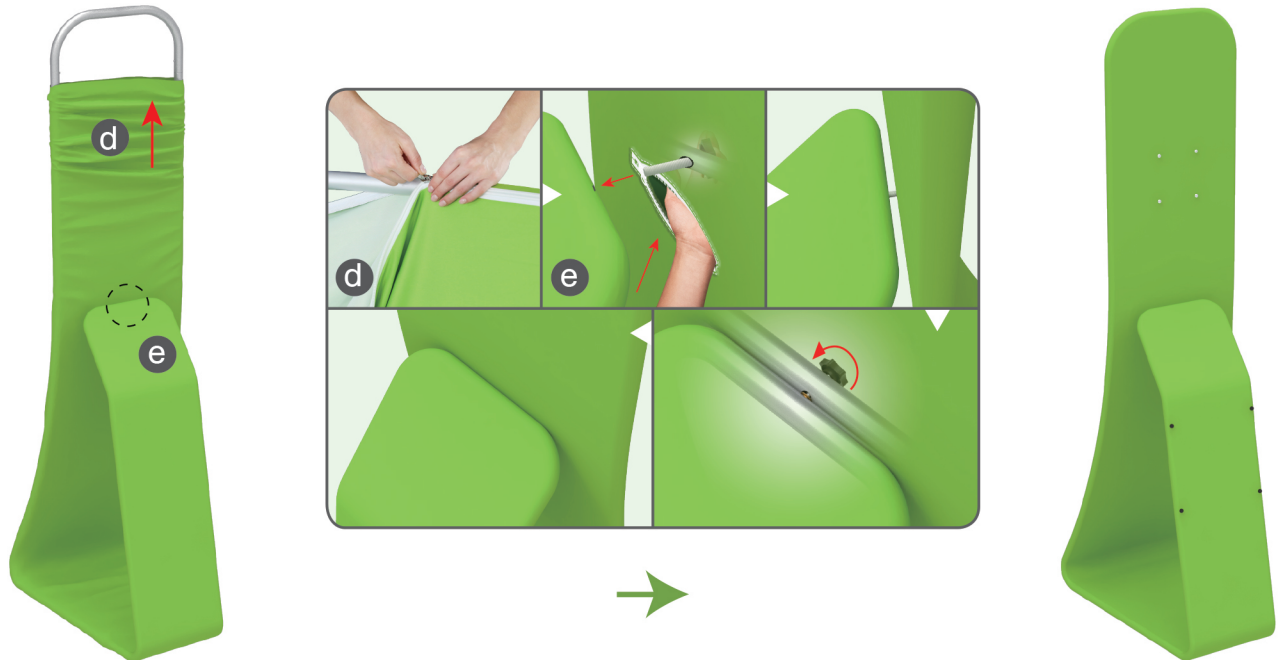

STEP 05

Screw TV mount onto display stand.

TV(Excluded,
Demo Only)

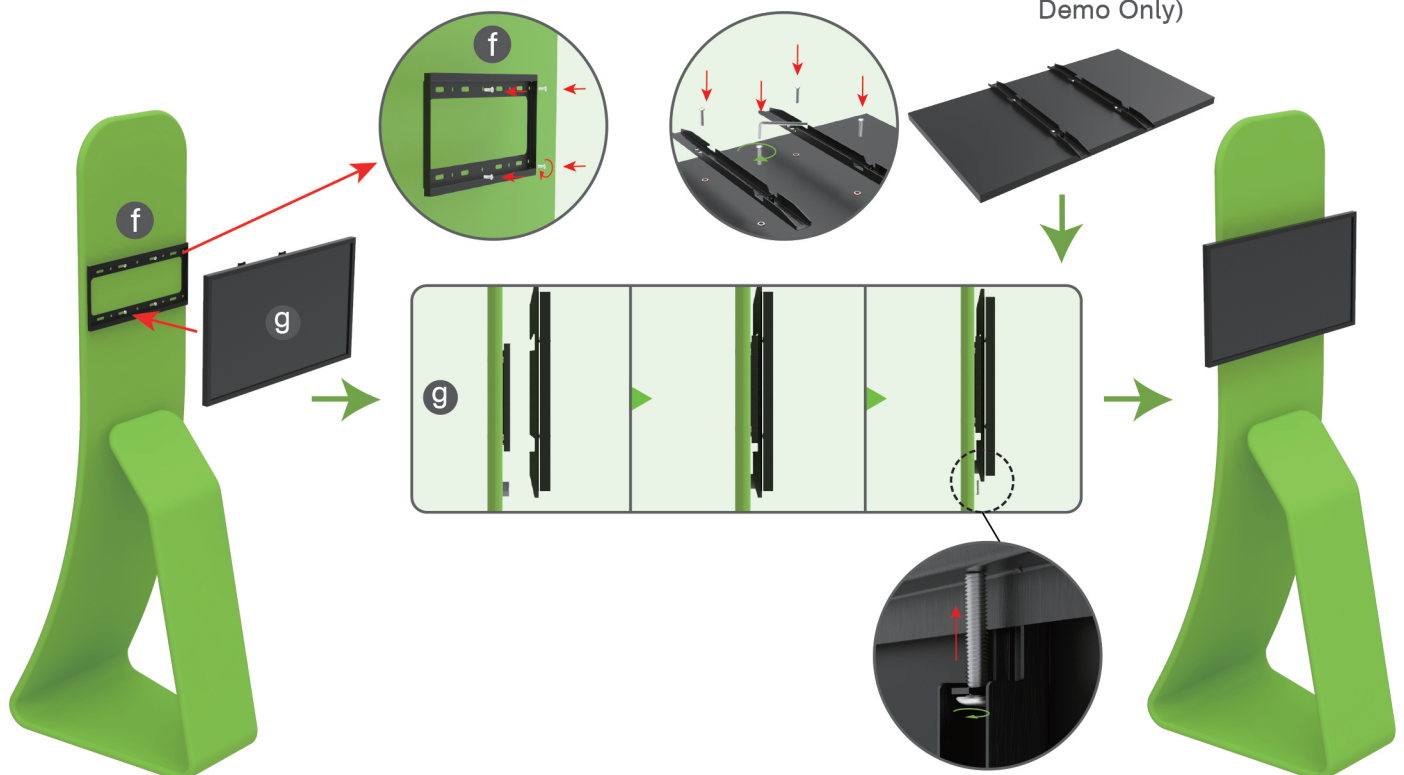

STEPS

STEP 07

To install 2 racks by screws in position

