

INSTRUCTION

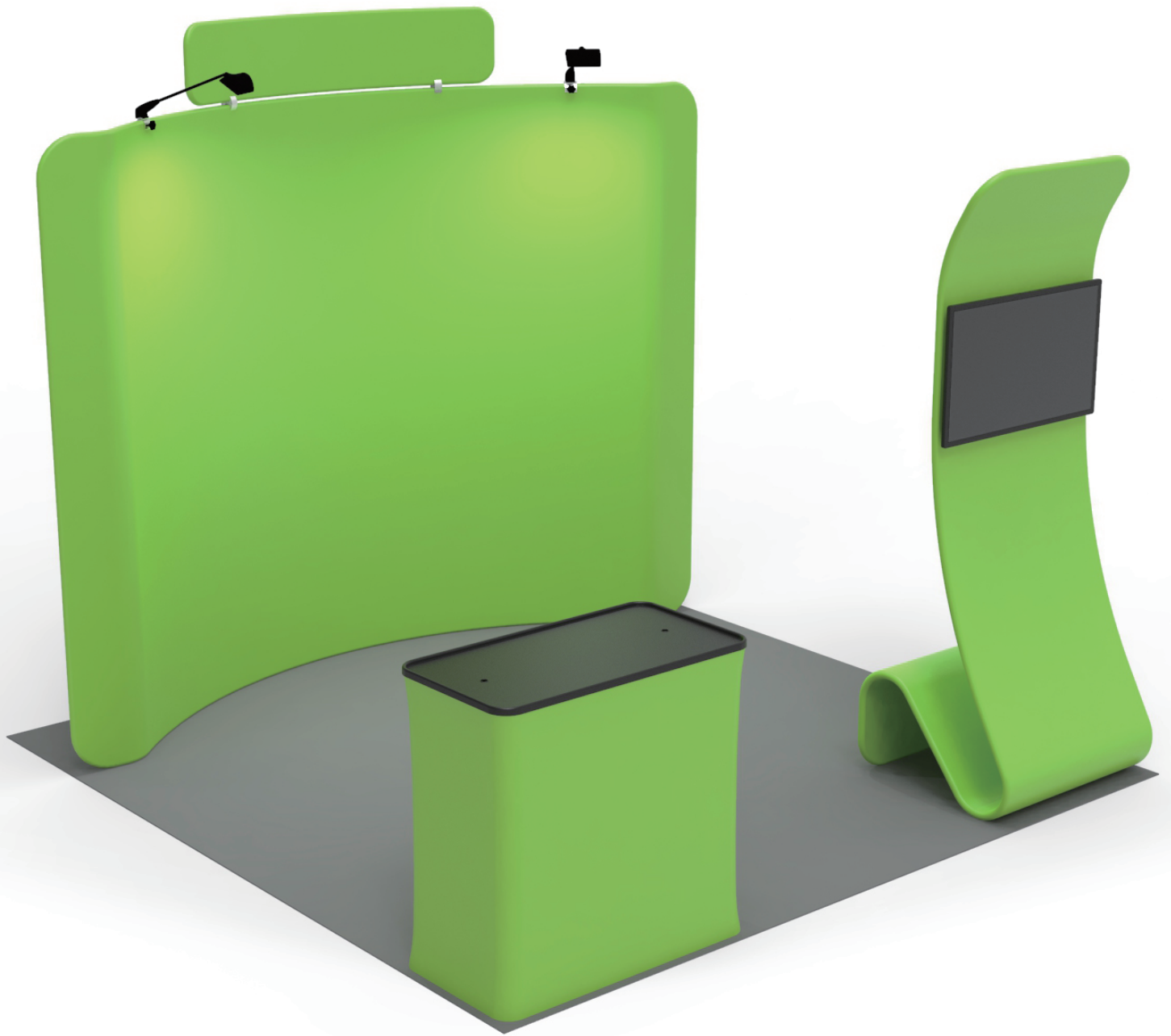

TF-SB-10X10-24

STEPS

(1) Hardware



(2) Printed Graphic Fabric Banner (Optional)



STEP 01

Connect to make long poles according to labelings.

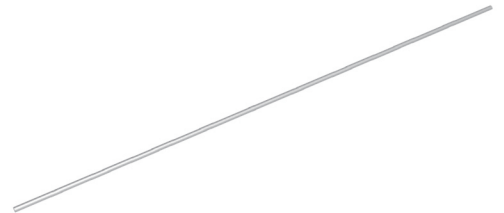
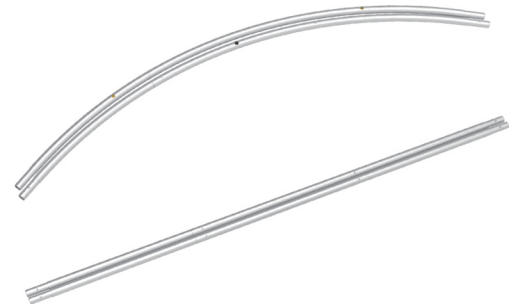
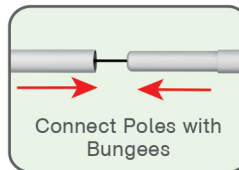
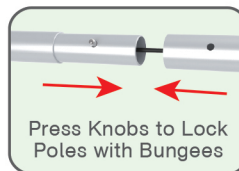
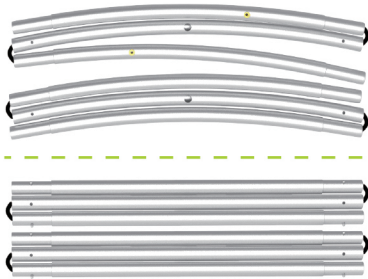

STEP 02

Connect long poles with corner poles according to labelings.

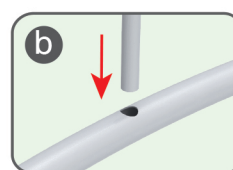
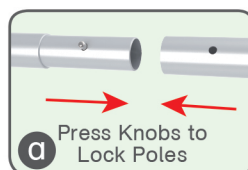
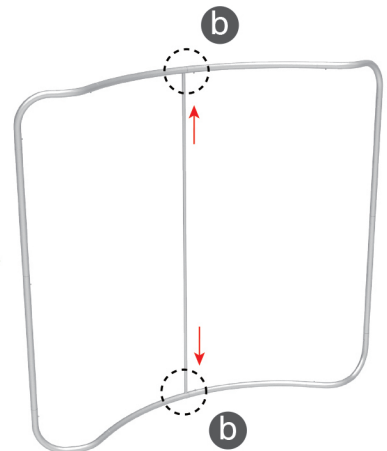
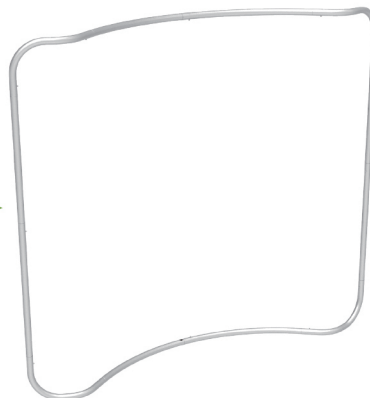
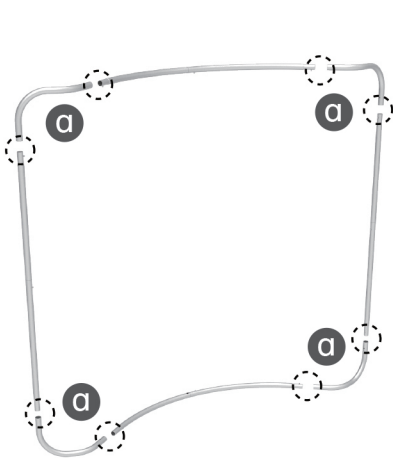

STEPS

STEP 03 Slide fabric banner on frame from top and zip up at bottom.

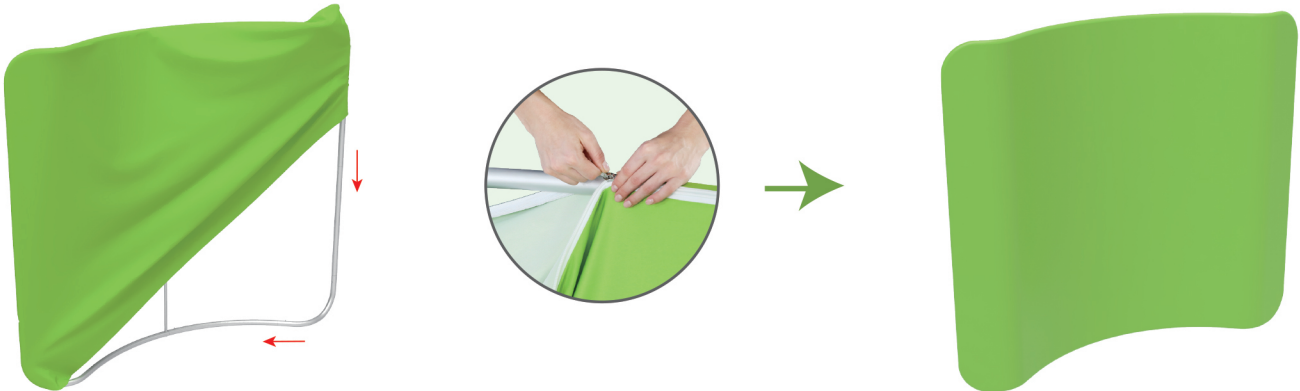

(1) Hardware



(2) Printed Graphic Fabric Banner (Optional)

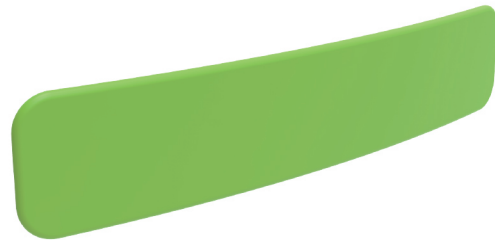

STEP 01 Connect poles according to labelings.

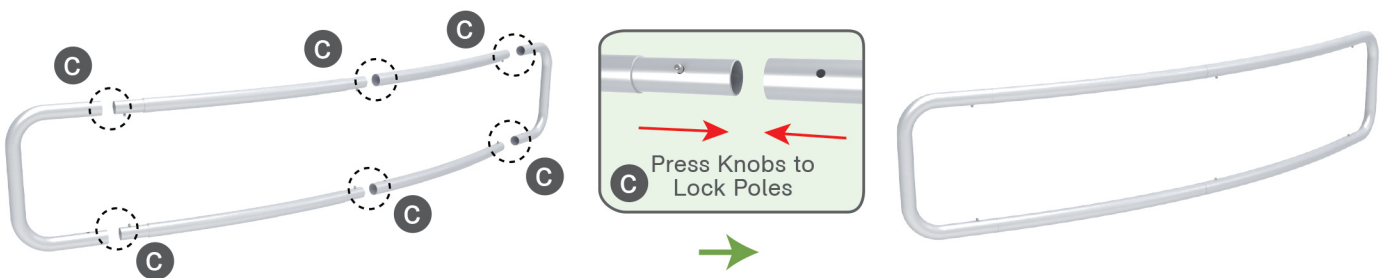

STEP 02 Slide fabric banner on frame from left and zip up at right.



★ One Tool (Hex Wrench) 

STEPS

Booth Set Assembly



(1) LED Light & Clip

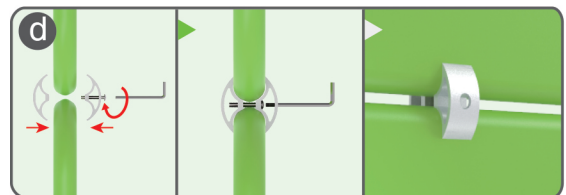
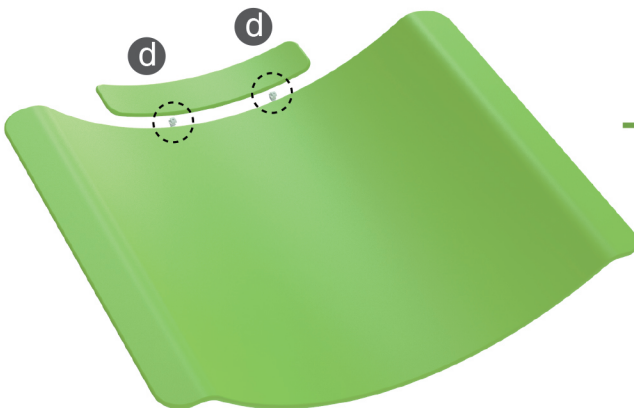
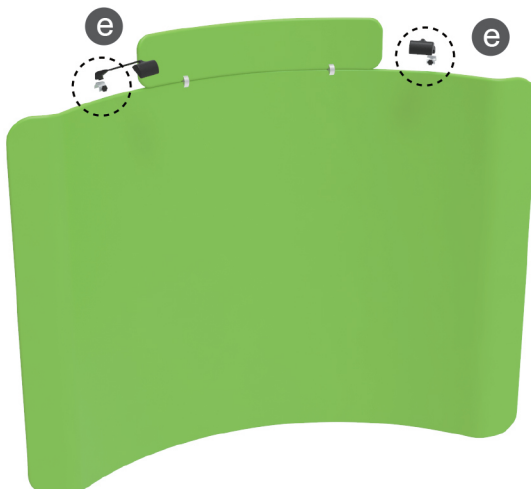
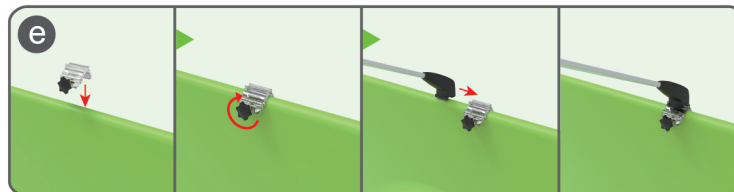

(2) 180° C-Shaped Clip

**STEP 01** Interconnect display stands with C-shaped clips.**STEP 05** Screw light clips at top of display stands, slide lights onto them and adjust their direction.

STEPS

(1) Durable Plastic Hard Case, Aluminum Support Poles



(2) Printed Graphic Fabric Banner



STEP 01

Put hard case's top into fabric banner.

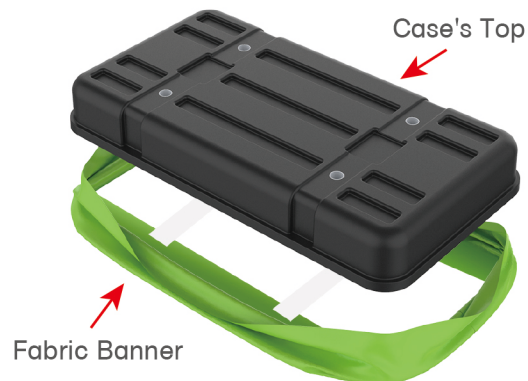

STEP 02

Insert support poles into hard case's top & bottom.

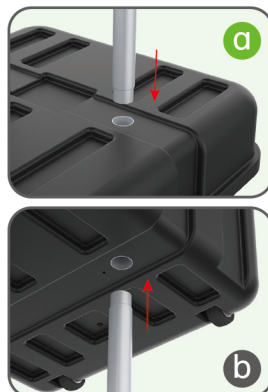
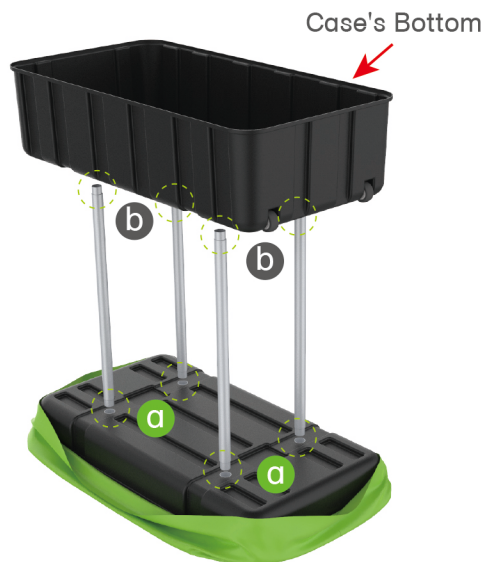

STEPS

STEP 04

Wrap fabric banner from bottom to top & twist it to be smooth, lay hard case's intermediate panel on podium's top.

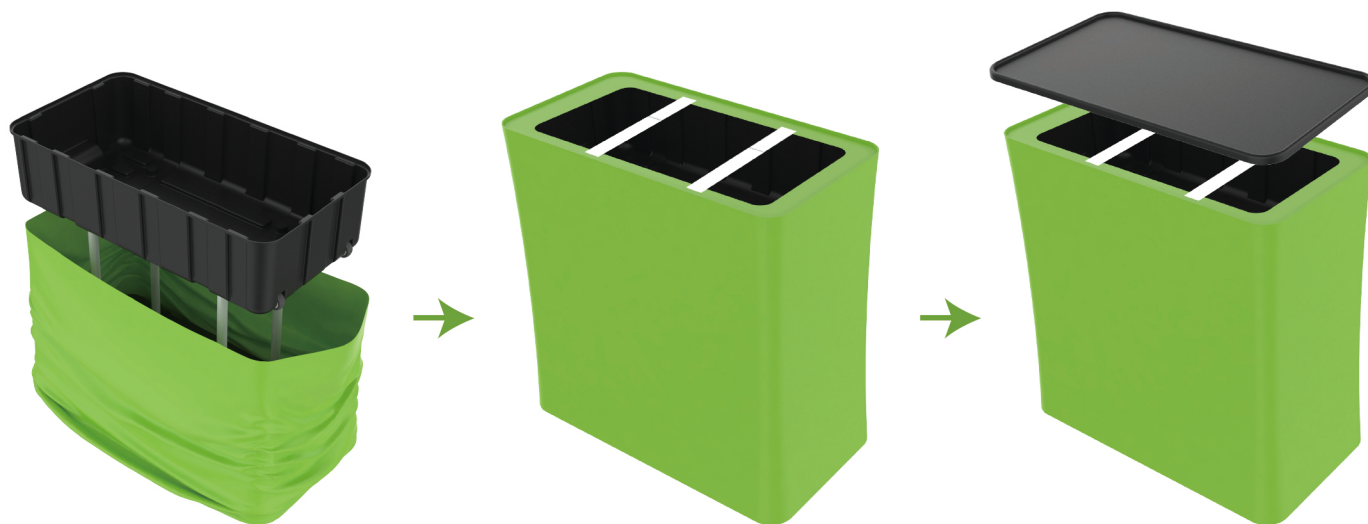

STEPS

(1) Hardware

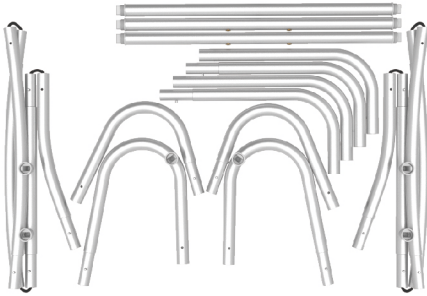

(2) Fabric banner



(3) TV mount

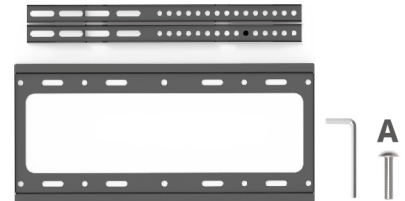

STEP 01 To connect the poles according to the labellings

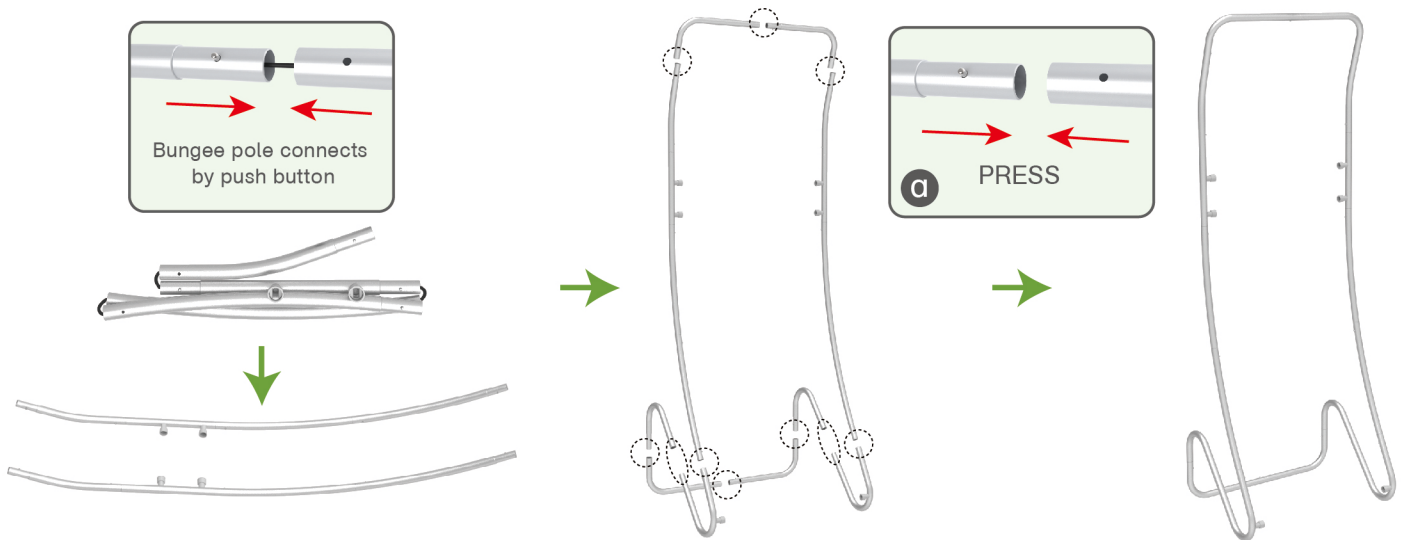

STEP 02 To install cross bar in position

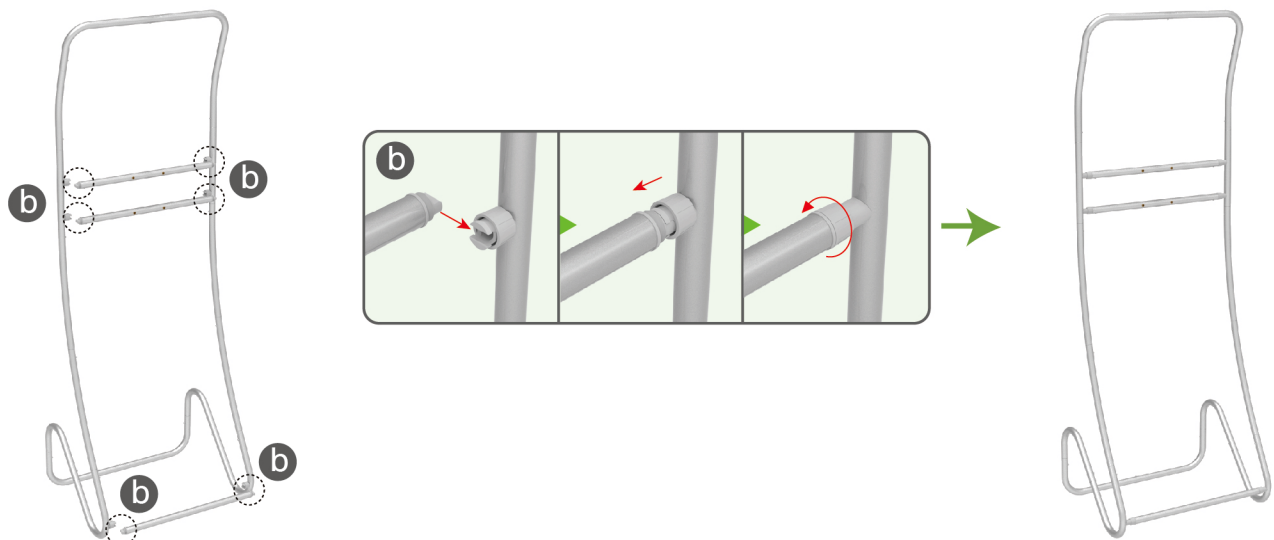

STEPS

STEP 03 To wrap the fabric from top to bottom and zip up

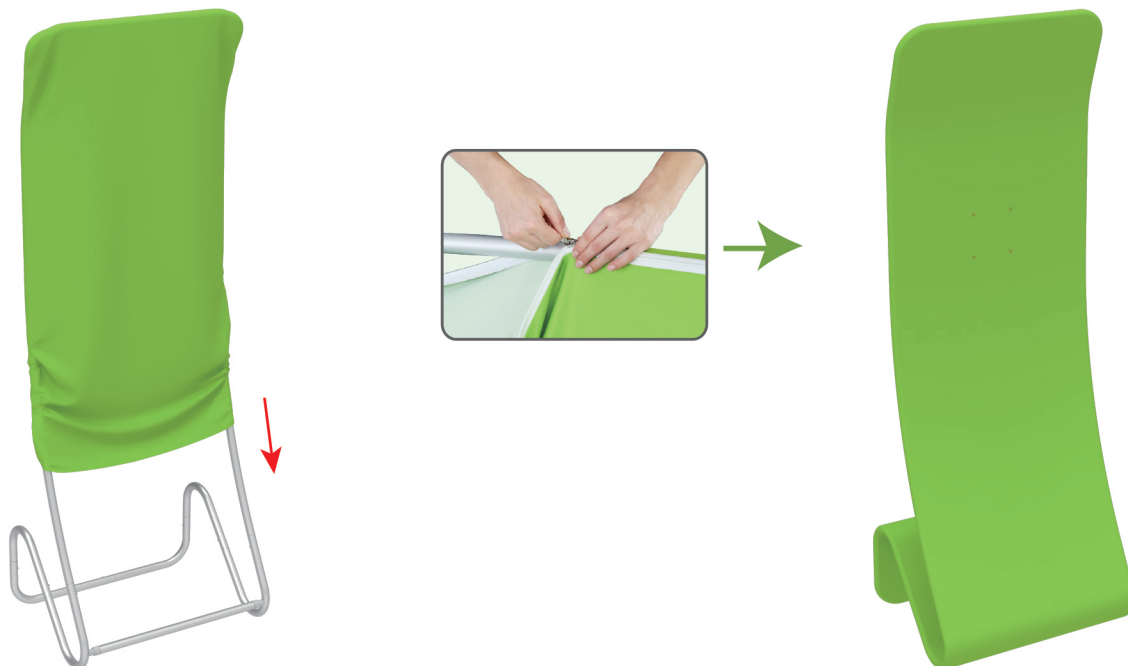

STEP 04 To install TV in position

