

INSTRUCTION

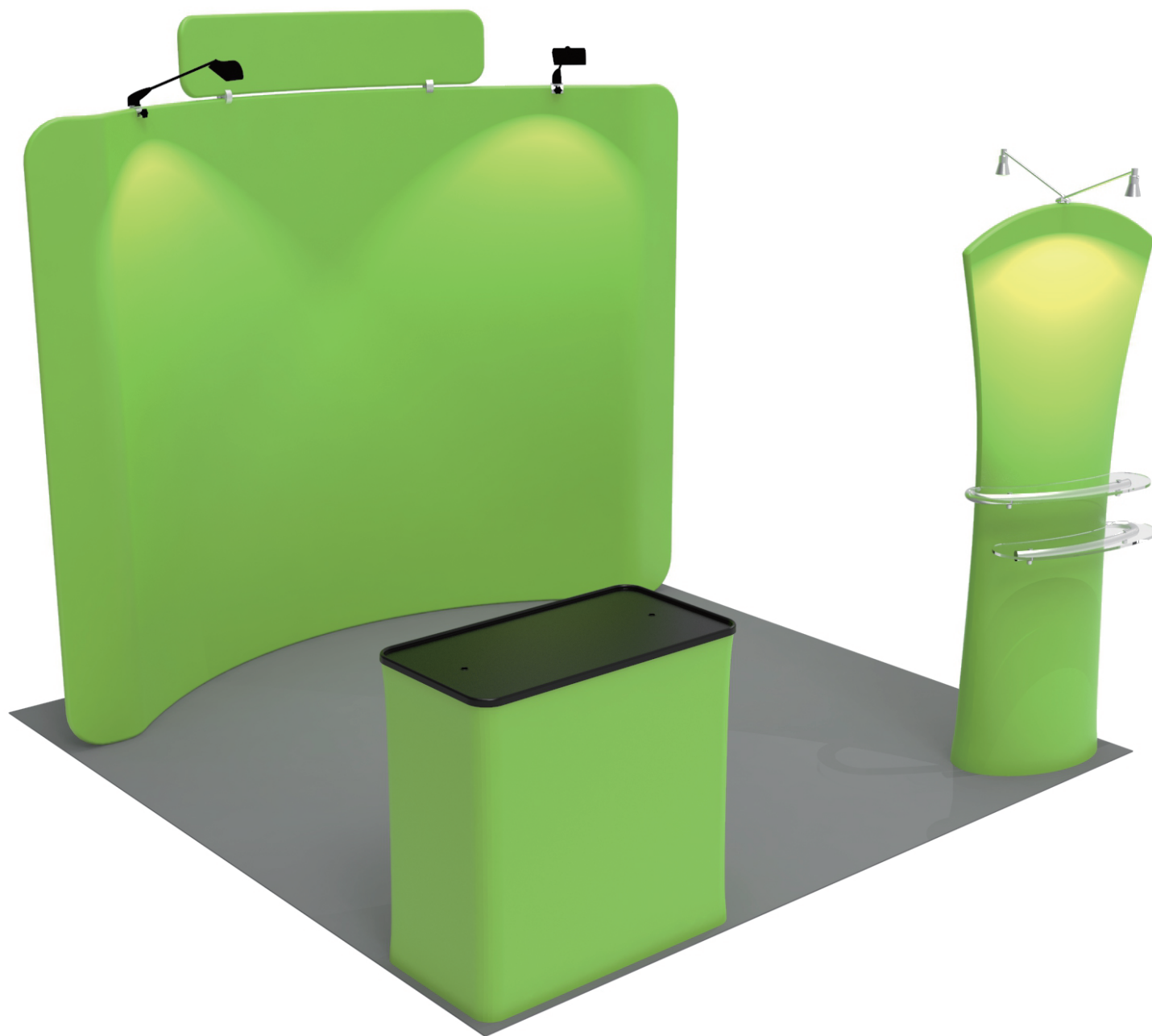

TF-SB-10X10-20

STEPS

(1) Hardware

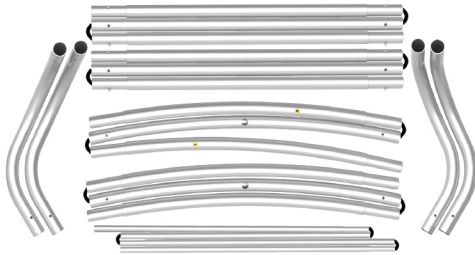

(2) Printed Graphic Fabric Banner (Optional)



STEP 01

Connect to make long poles according to labelings.

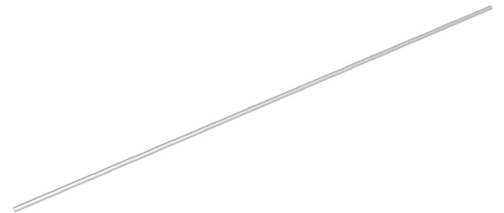
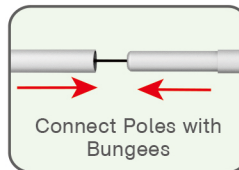
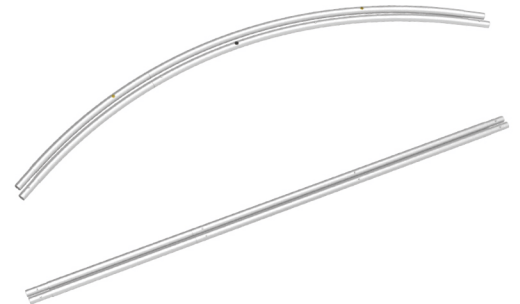
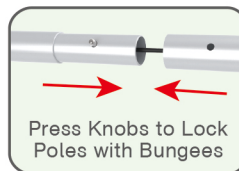
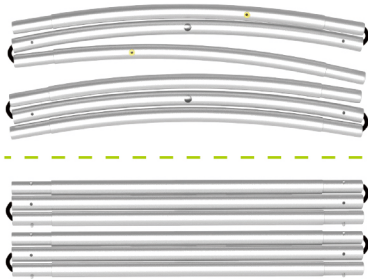

STEP 02

Connect long poles with corner poles according to labelings.

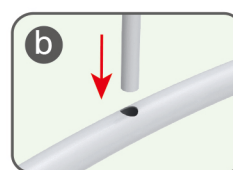
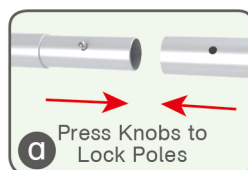
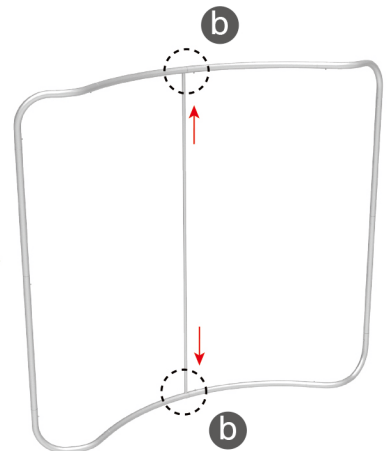
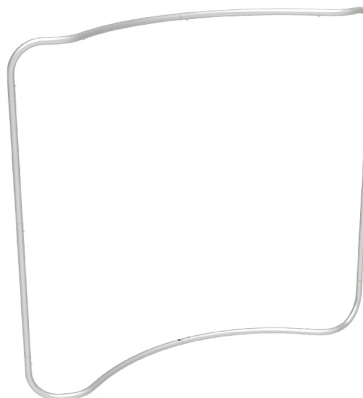
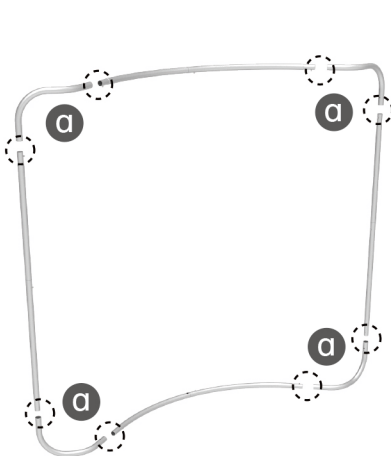

STEPS

STEP 03 Slide fabric banner on frame from top and zip up at bottom.

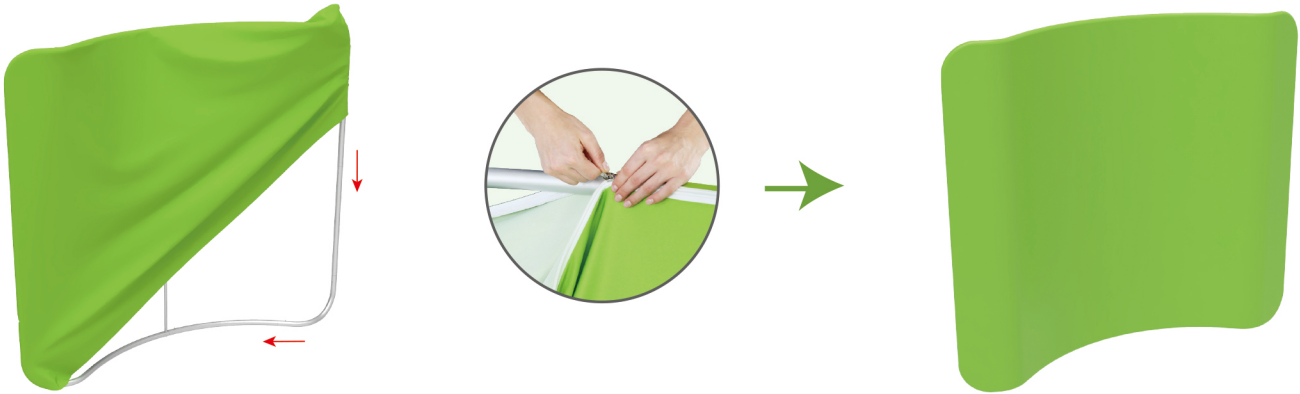

(1) Hardware

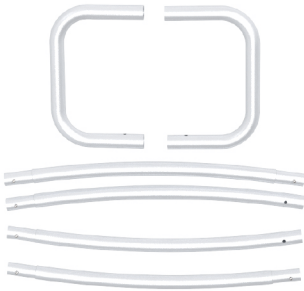

(2) Printed Graphic Fabric Banner (Optional)

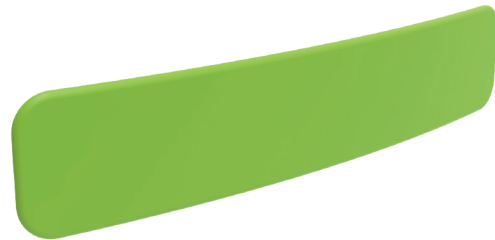

STEP 01 Connect poles according to labelings.

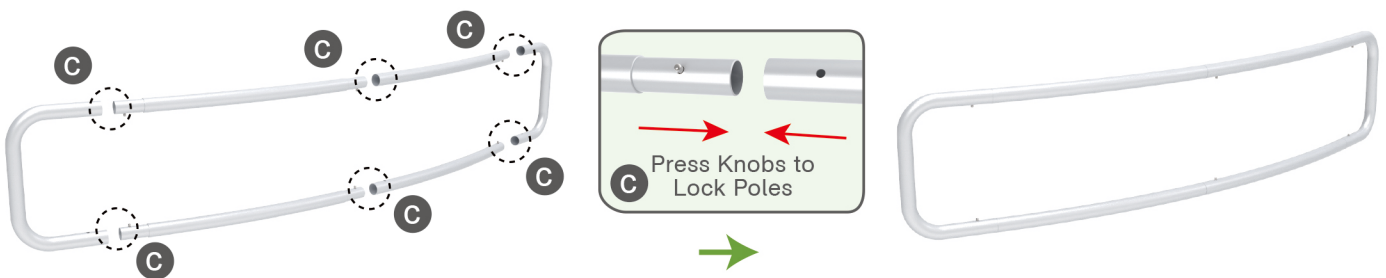

STEP 02 Slide fabric banner on frame from left and zip up at right.



STEPS

Booth Set Assembly



(1) LED Light & Clip

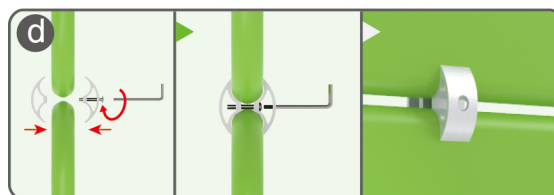
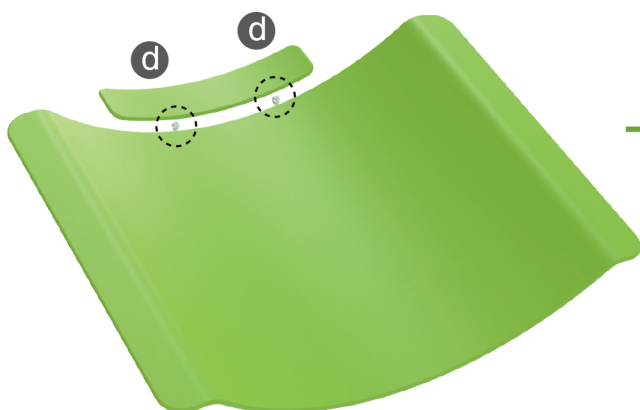
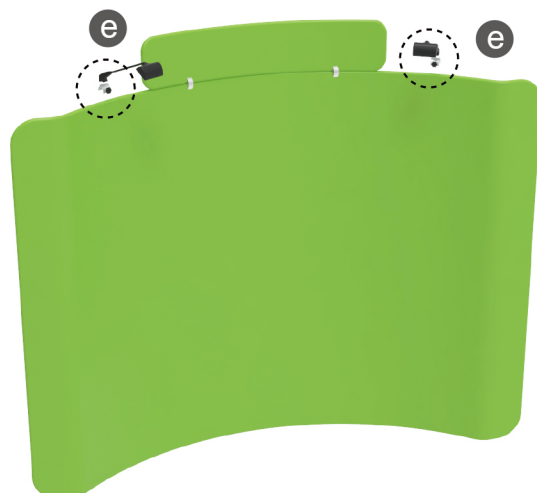
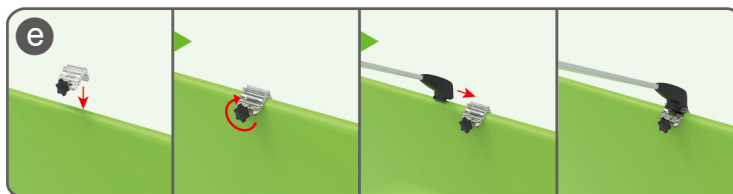

(2) 180° C-Shaped Clip

**STEP 01** Interconnect display stands with C-shaped clips.**STEP 05** Screw light clips at top of display stands, slide lights onto them and adjust their direction.

STEPS

(1) Durable Plastic Hard Case, Aluminum Support Poles



(2) Printed Graphic Fabric Banner



STEP 01

Put hard case's top into fabric banner.

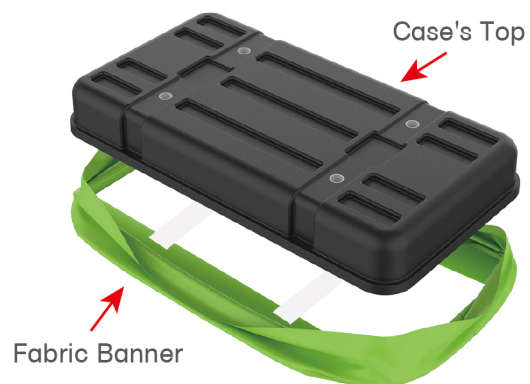

STEP 02

Insert support poles into hard case's top & bottom.

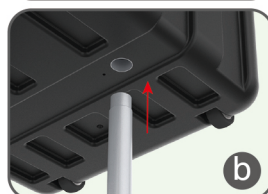
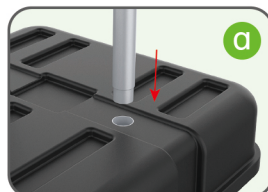
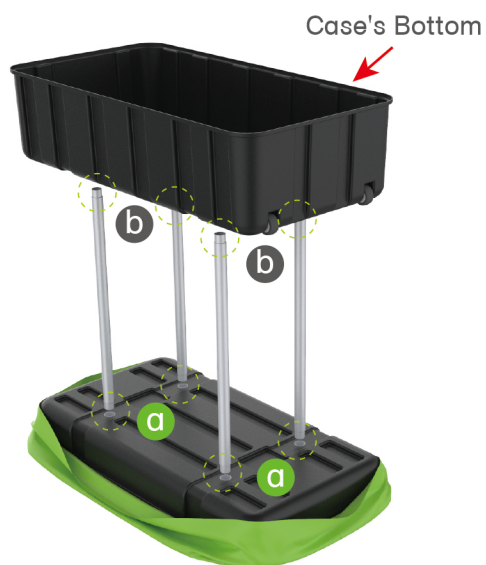

STEPS

STEP 04

Wrap fabric banner from bottom to top & twist it to be smooth, lay hard case's intermediate panel on podium's top.

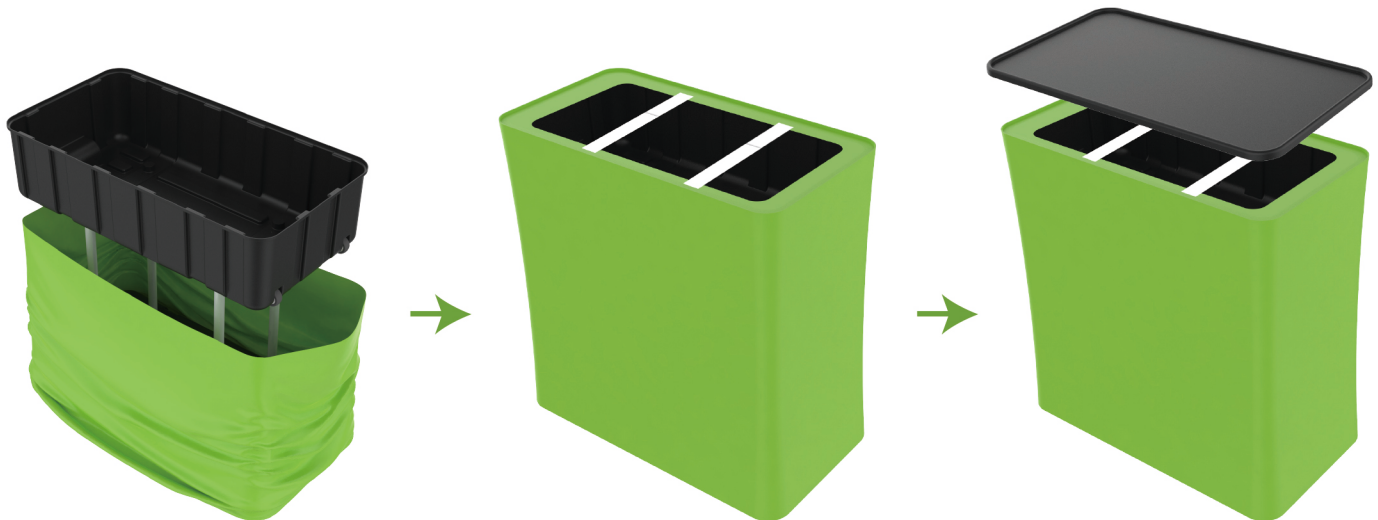

★ One Tool (Hex Wrench) **STEPS**

(1) Aluminum pole



(2) MDF panel

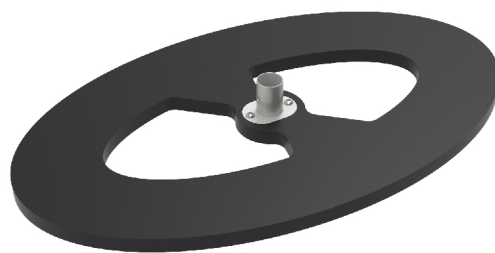

(3) Fabric banner



(4) Optional Accessory

**STEP 01**

To assemble the poles according to labelling

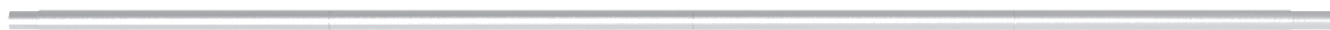
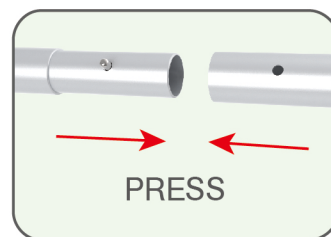

STEPS

STEP 02

To put the bottom MDF panel upside down and clip the fabric banner to the slot

To put the middle of fabric bottom into the middle of bottom panel slot and start the assembly



BOTTOM



PRESS

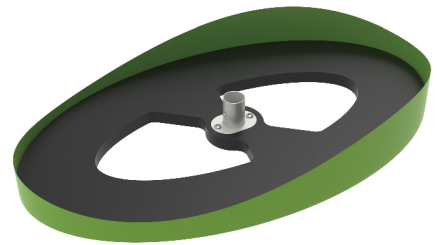

STEP 03

Insert the center pole into the base.

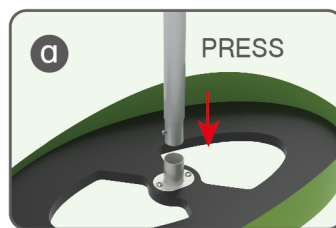

STEPS

STEP 04

Stretch the cloth cover upward and put it into the top bracket. Pull the zipper on both sides to the middle to expose the hole of the LED light on the top of the bracket

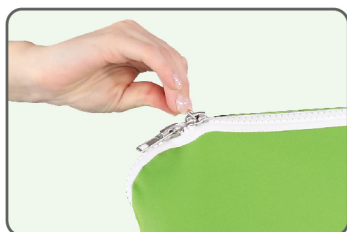
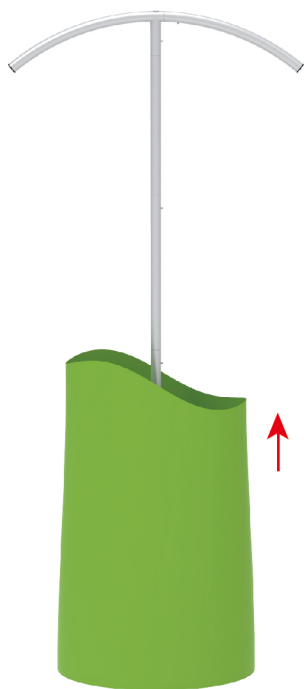

Zip up fabric graphic



STEP 05

Slide the shelves through the open slits in the graphic and connect them to their support sockets.

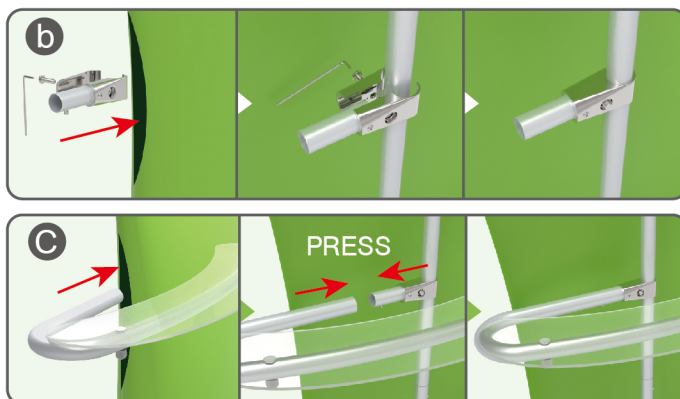
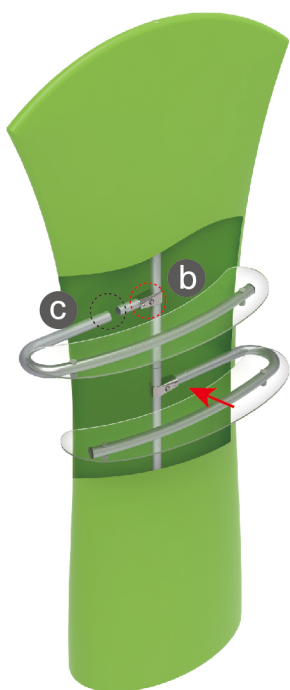

STEPS

STEP 06

Place the base of the light fitting in the hole in the middle of the profile.

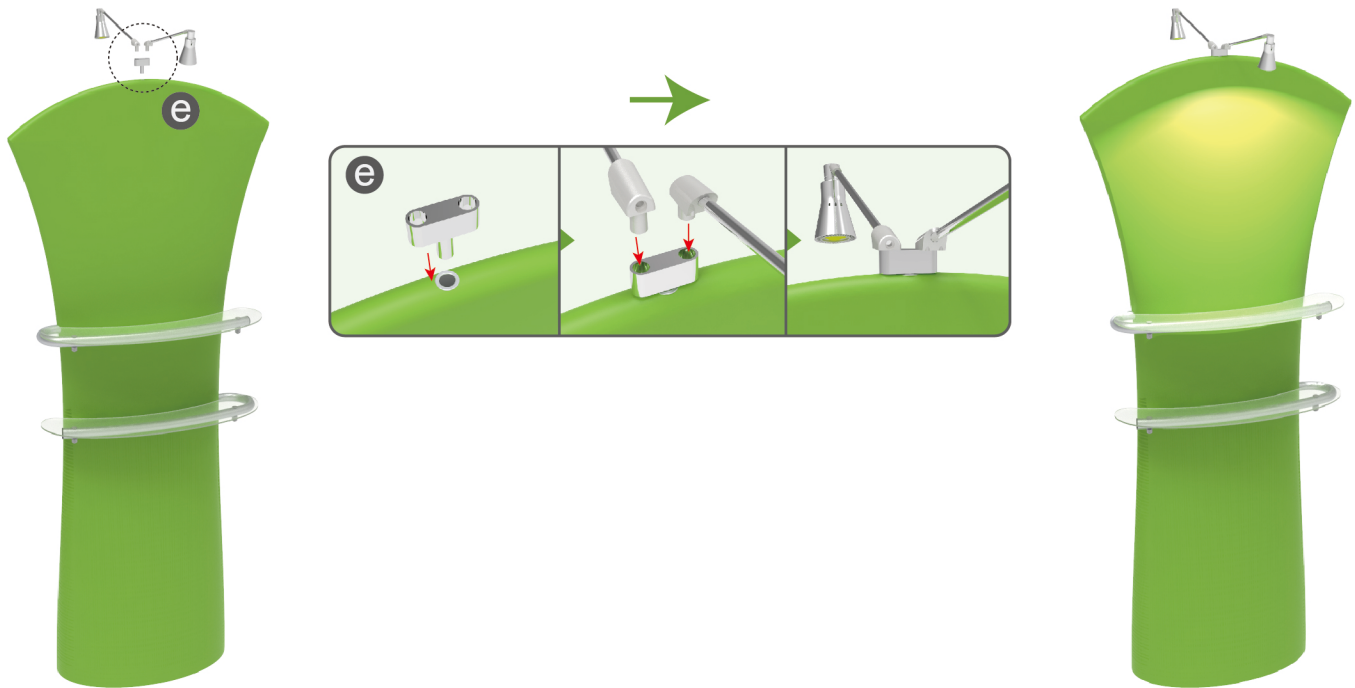

DT-W-01



DT-W-02



DT-W-03