

INSTRUCTION

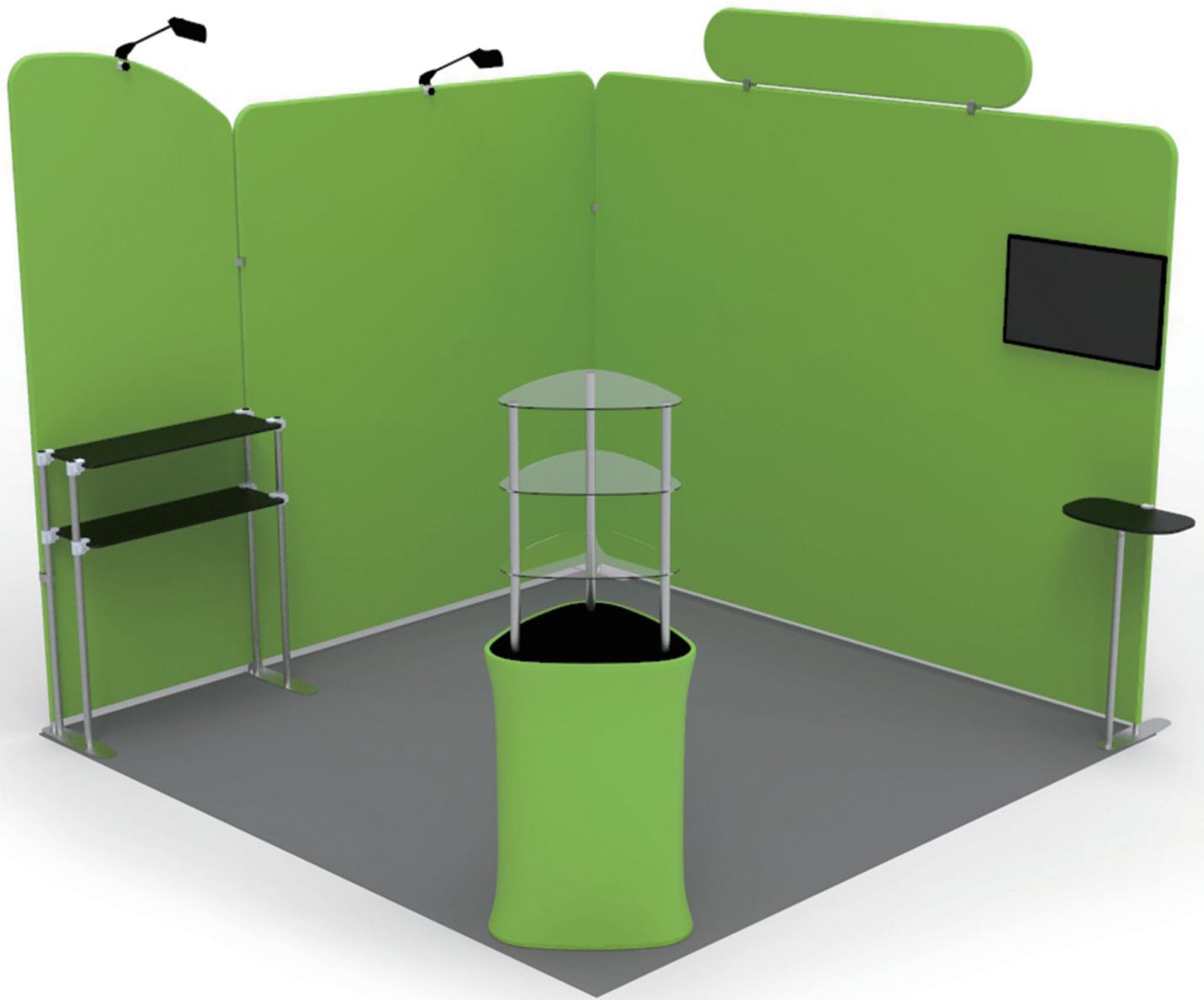

10X10FT-BOOTH-T

STEPS

(1) Hardware

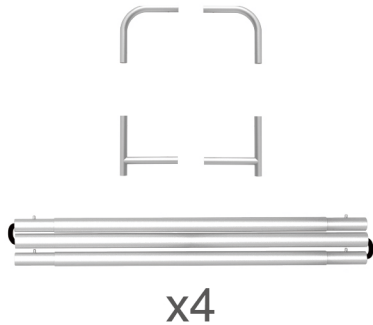

(2) Printed Graphic Fabric Banner (Optional)



STEP 01

Connect to make long poles according to labelings.

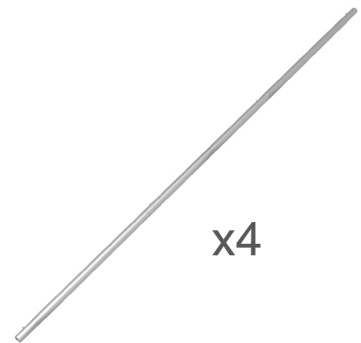
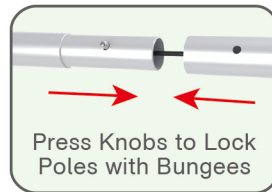
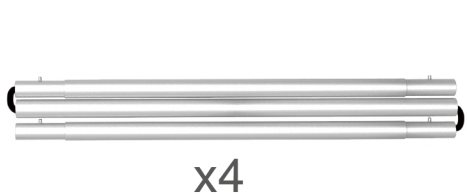

STEP 02

Connect long poles with corner poles according to labelings.

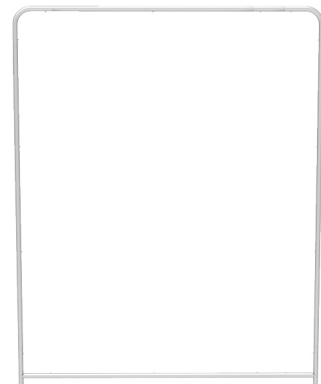
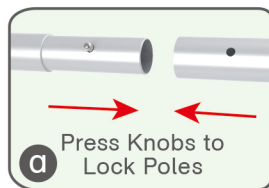
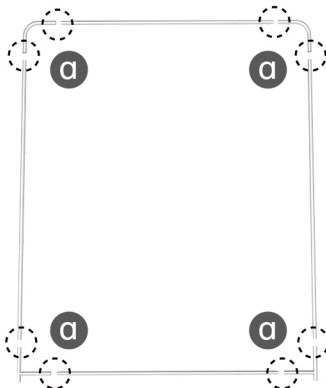

STEP 03

Slide fabric banner on frame from top and zip up at bottom.



Same Steps for Other Display Stands

STEPS

(1) Hardware



(2) Printed Graphic Fabric Banner (Optional)



STEP 01

Connect poles according to labelings.

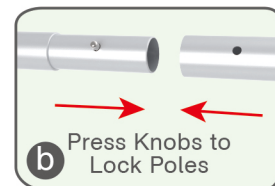
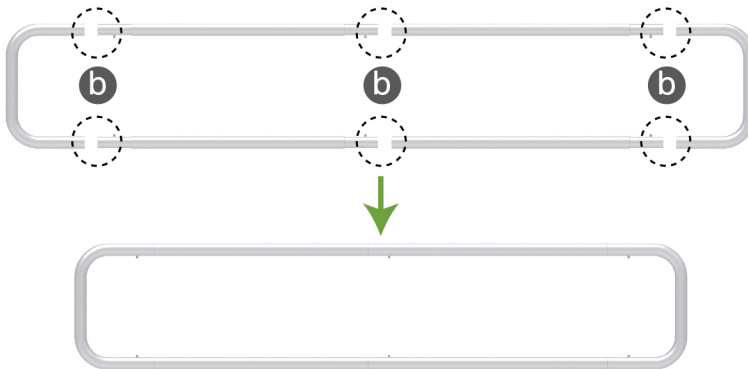

STEP 02

Slide fabric banner on frame from left and zip up at right.

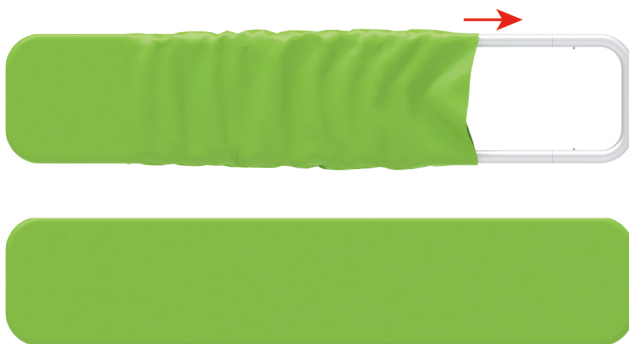

Booth Set Assembly



(1) Base

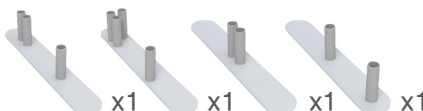

(2) 180° C-Shaped Clip & 90° C-Shaped Clip



(3) Shelving Board



(4) LED Light & Clip



(5) TV Mount

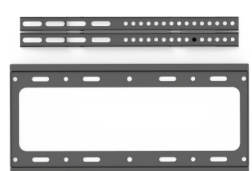

(6) MDF Board Table

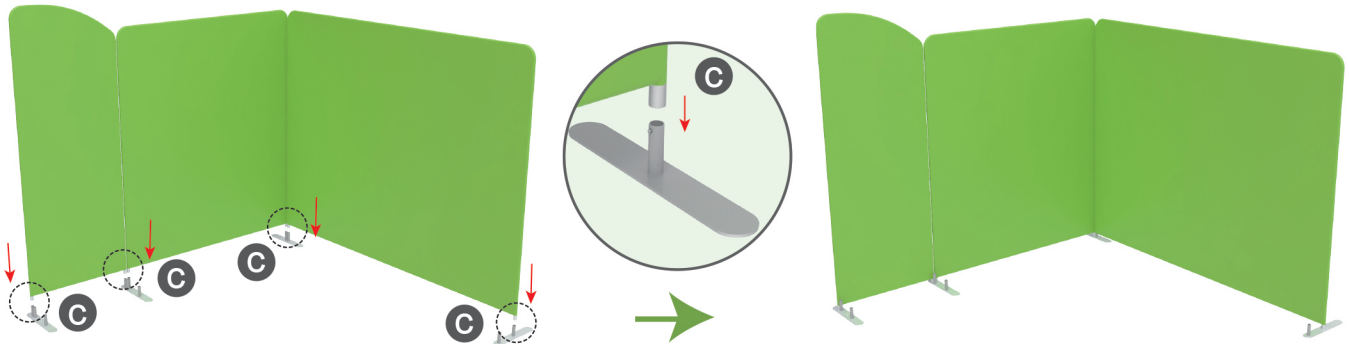
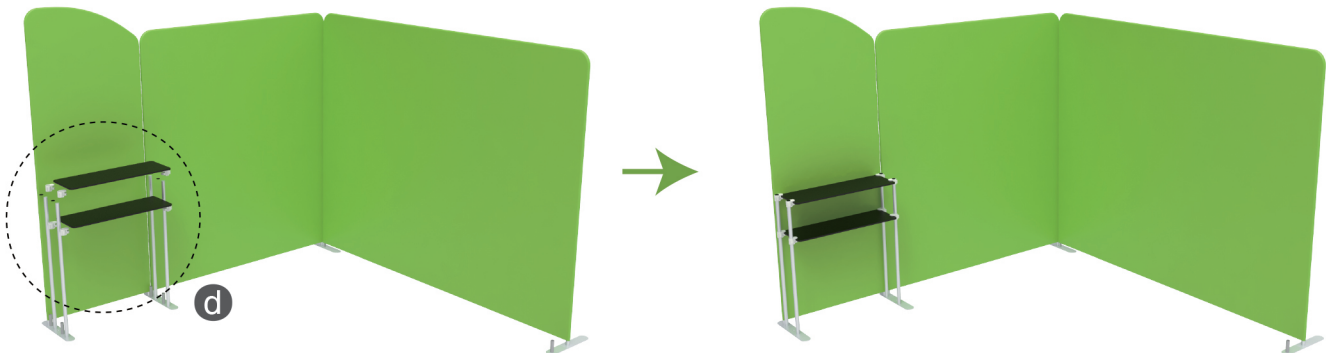
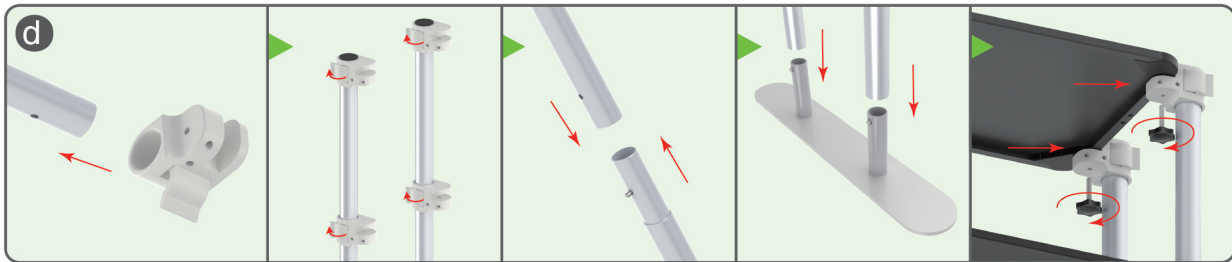
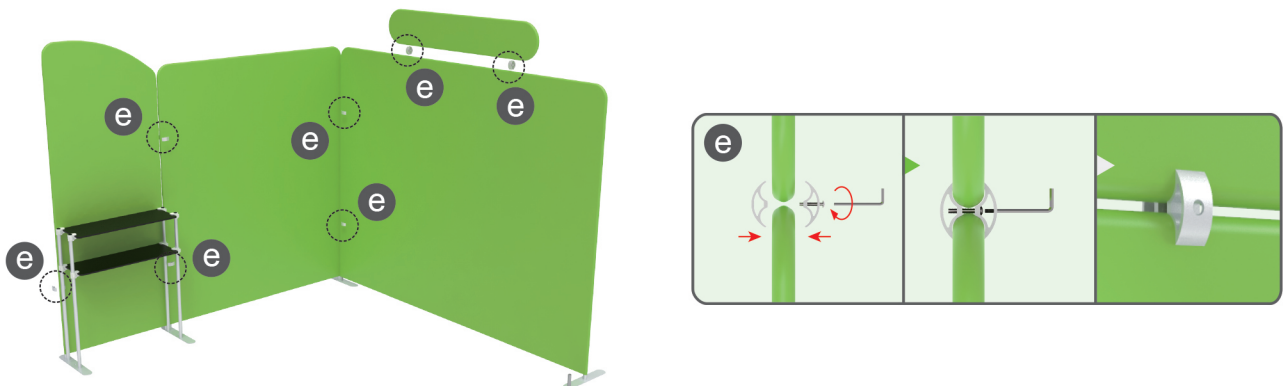

STEPS

STEP 01 Insert display stands onto feet by pressing their knobs.**STEP 02** Install shelving boards in position.**STEP 03** Interconnect display stands with C-shaped clips.

★ One Tool (Hex Wrench)

STEPS

(1) Straight Support Poles

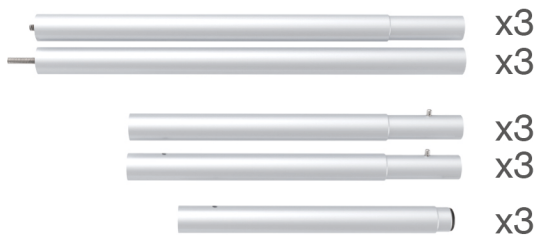

(2) Top MDF Board, Bottom MDF Board, Acrylic Boards

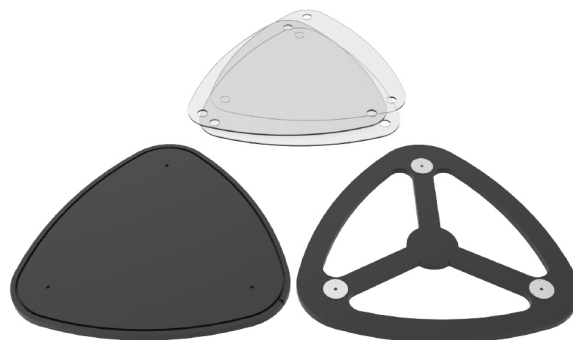

(3) Printed Graphic Fabric Banner



STEP 01

Connect straight support poles by pressing knobs to lock.

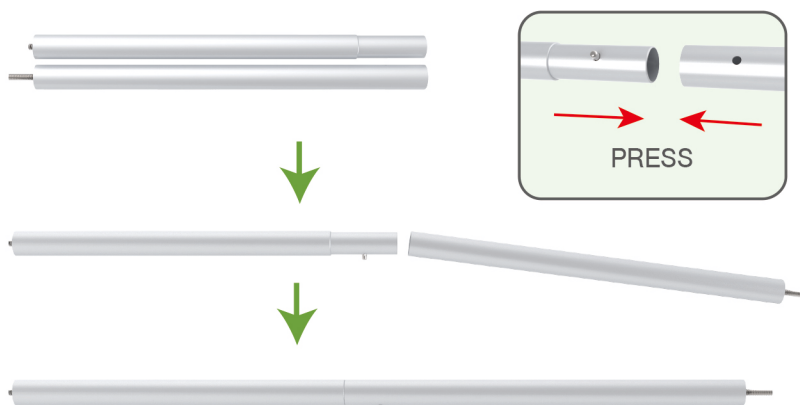

STEP 02

Insert fabric banner into bottom MDF board's slot and turn it over.



BOTTOM

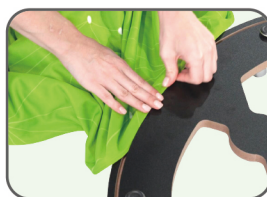

PRESS



STEPS

STEP 03

Screw straight support poles in bottom MDF board's threaded holes and place top MDF board on them.

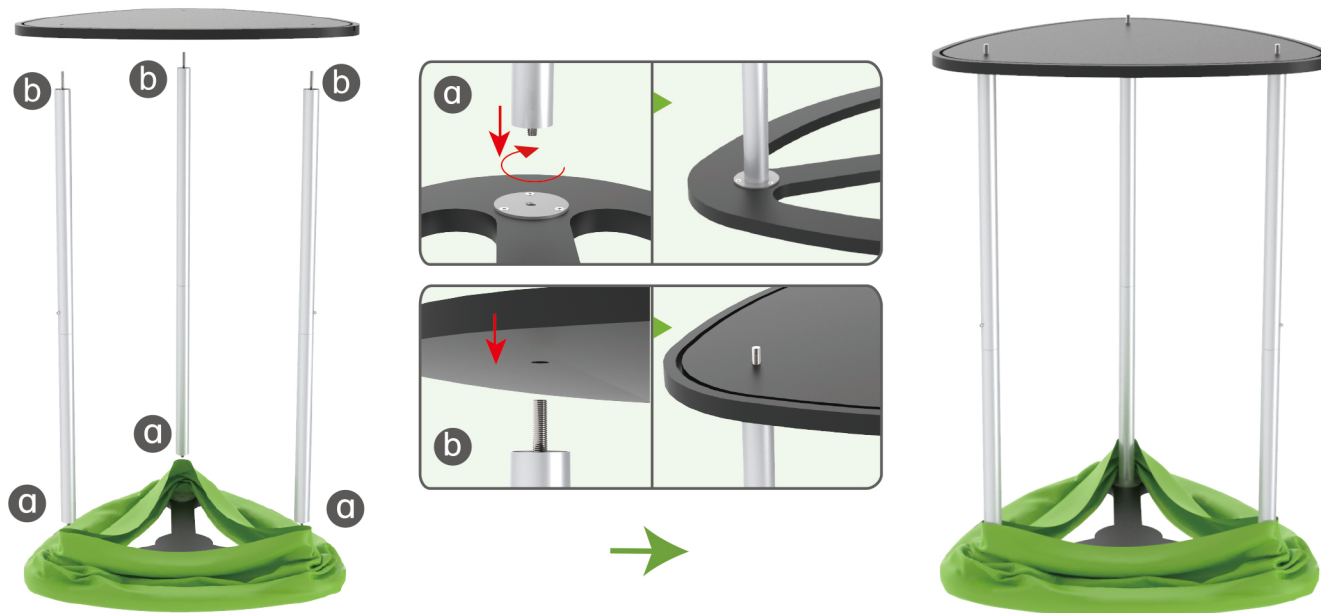

STEP 04

Pull fabric banner from bottom to top and insert into top MDF board's slot.



STEPS

STEP 05

Screw straight support poles with threaded holes filled onto nuts and place acrylic boards on them layer by layer.

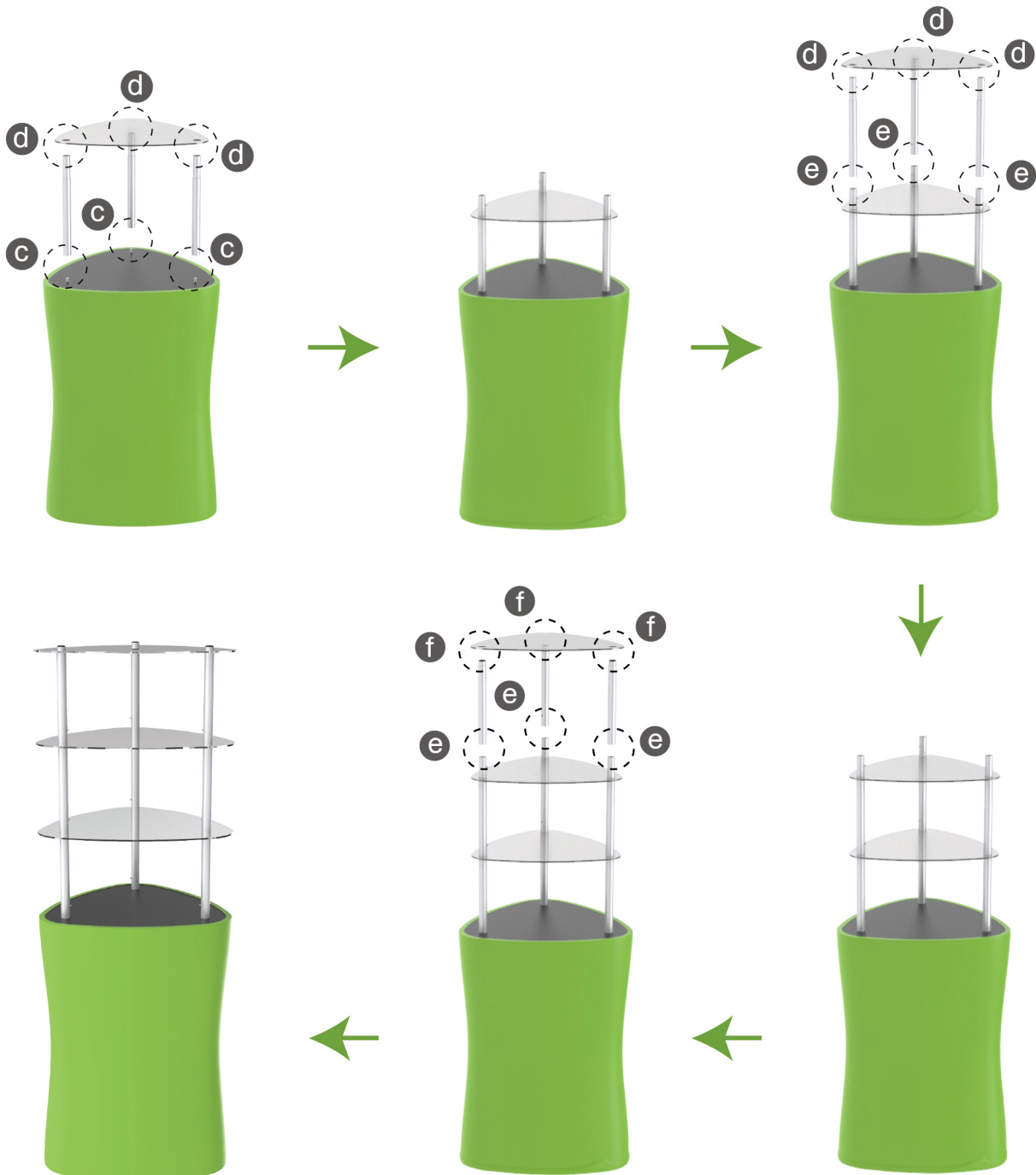
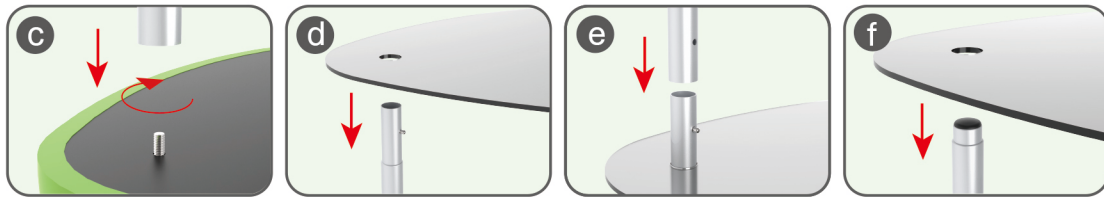

STEPS



DT-S-02



DT-S-01



DT-S-03