

# INSTRUCTION

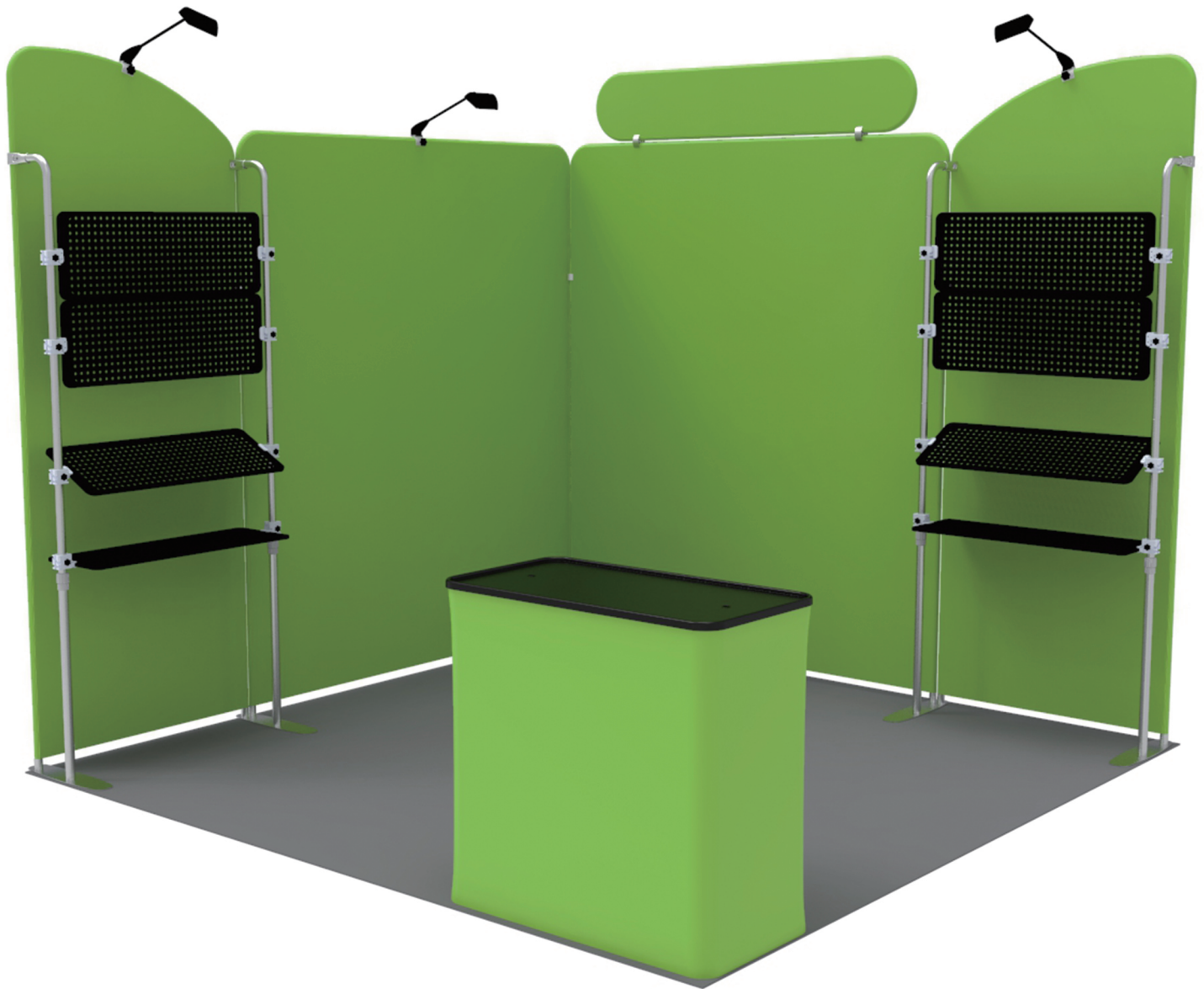

10X10FT-BOOTH-Q

## STEPS

(1) Hardware

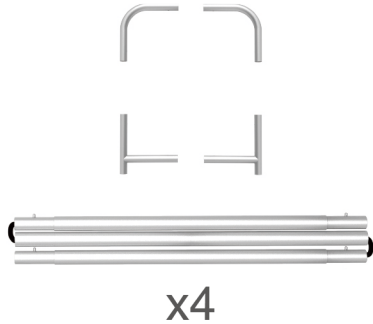

(2) Printed Graphic Fabric Banner (Optional)



## STEP 01

Connect to make long poles according to labelings.

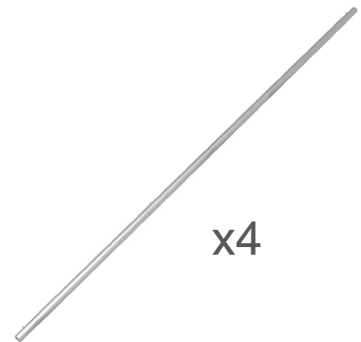
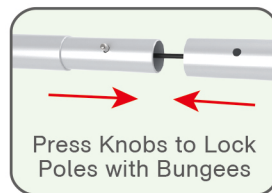
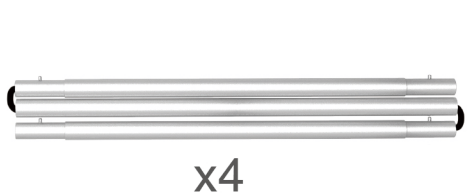

## STEP 02

Connect long poles with corner poles according to labelings.

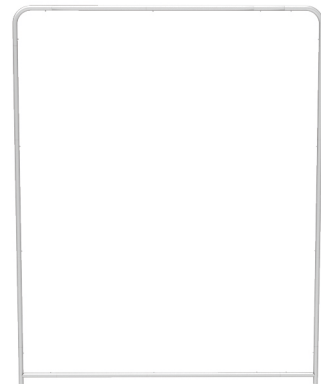
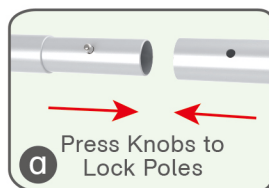
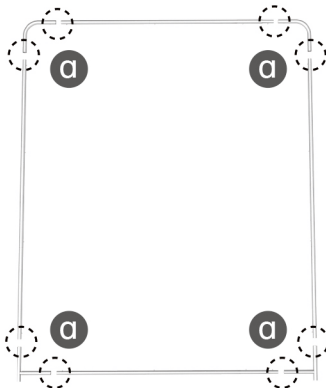

## STEP 03

Slide fabric banner on frame from top and zip up at bottom.



Same Steps for Other Display Stands

## STEPS

## (1) Hardware



## (2) Printed Graphic Fabric Banner (Optional)



## STEP 01

Connect poles according to labelings.

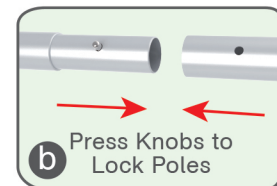
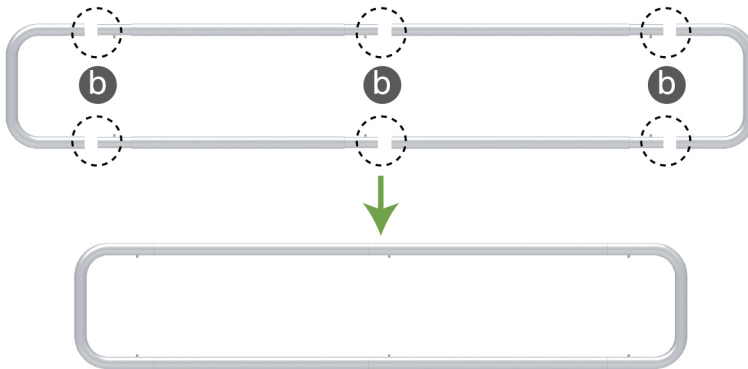

## STEP 02

Slide fabric banner on frame from left and zip up at right.

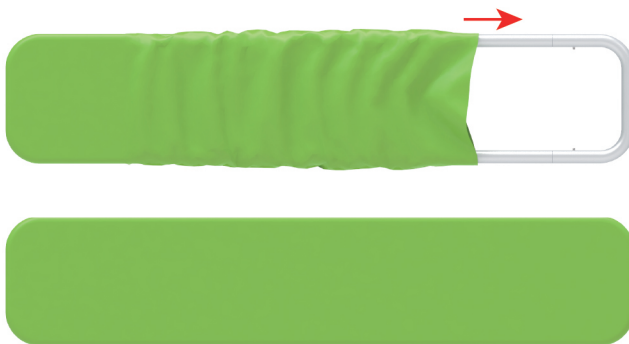

## Booth Set Assembly



## (2) Base

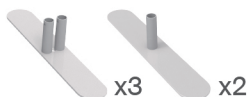

## (3) 180° C-Shaped Clip &amp; 90° C-Shaped Clip



## (1) Shelving Board

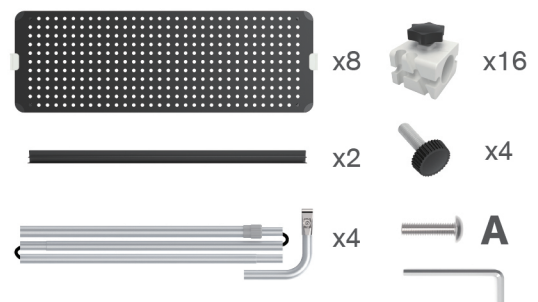

## (4) LED Light &amp; Clip



## STEPS

**STEP 01** Insert display stands onto feet by pressing their knobs.

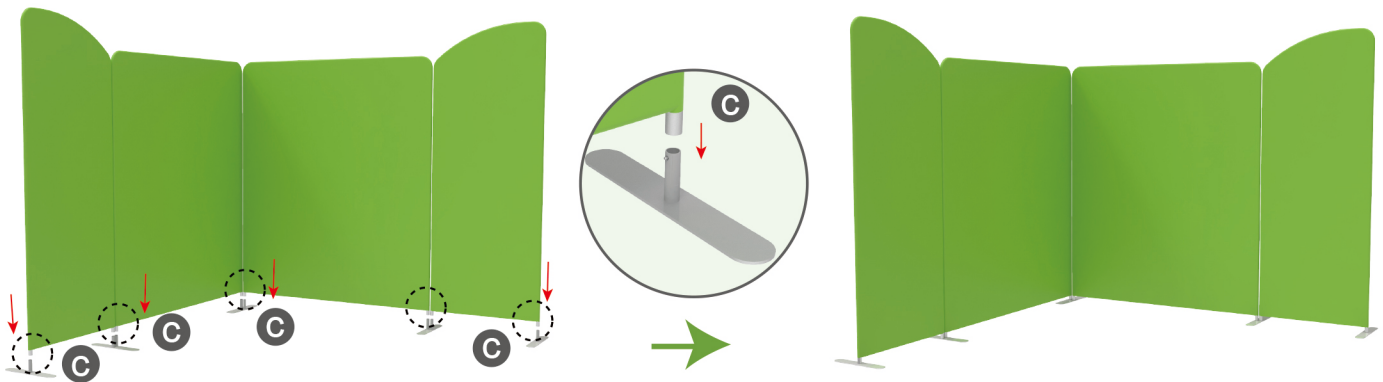

## STEP 02

Connect to make long poles according to labelings, slide three-way clips onto long poles, insert short curved poles onto their top by pressing their knobs.

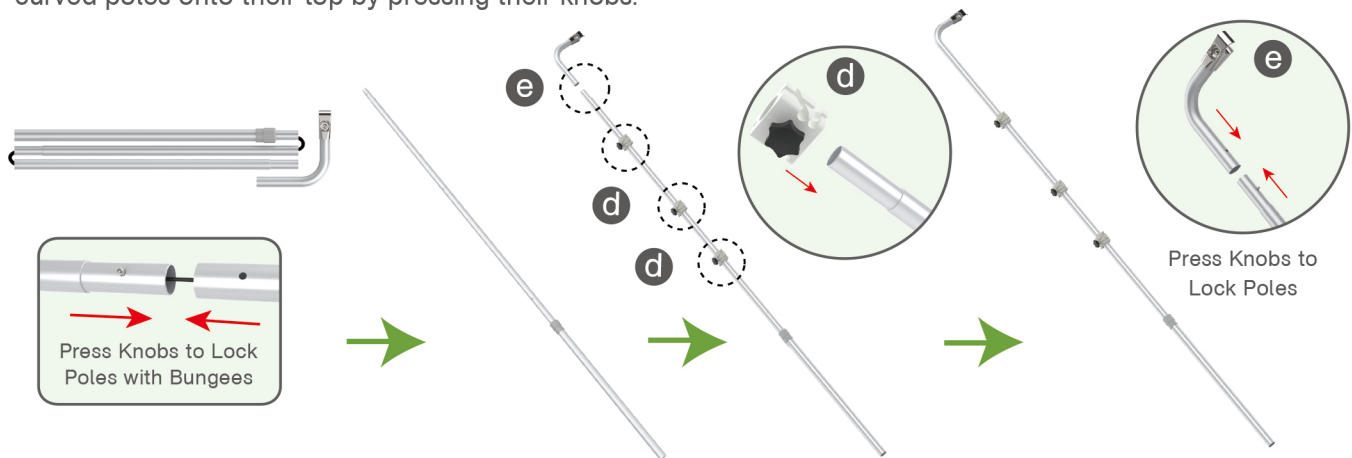

## STEP 03

Connect long poles and display stand with clamps, adjust their height properly as needed by loosening and tightening screws.

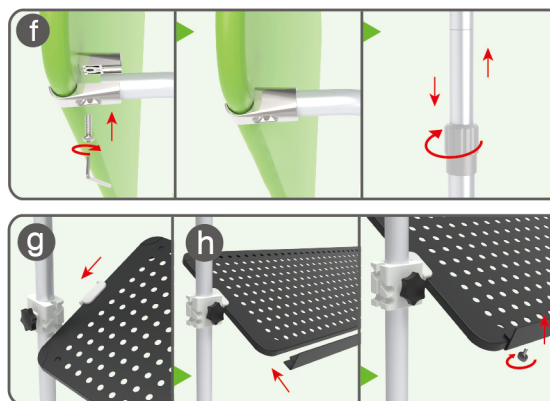
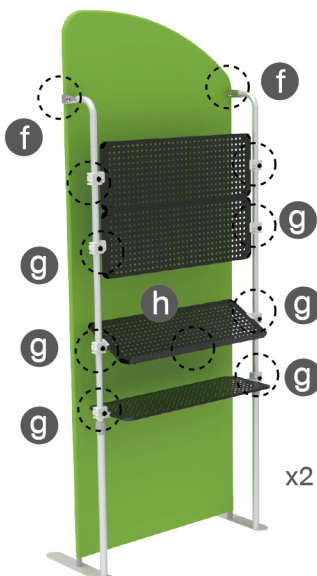

Clip into hanging boards based on directions of three-way clips & tightening with thumb screws, clip F-shaped bar onto hanging board with thumb screws.



## STEPS

**STEP 03** Interconnect display stands with C-shaped clips.

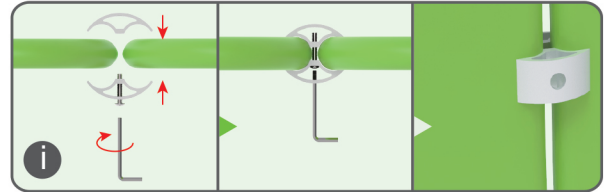
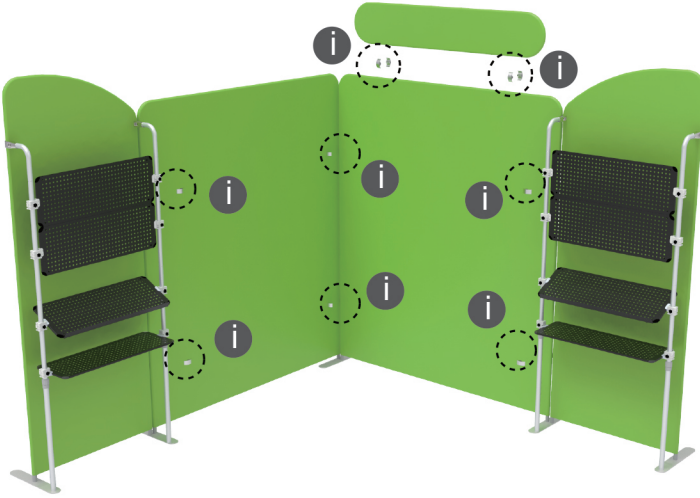

**STEP 05** Screw light clips at top of display stands, slide lights onto them and adjust their direction.

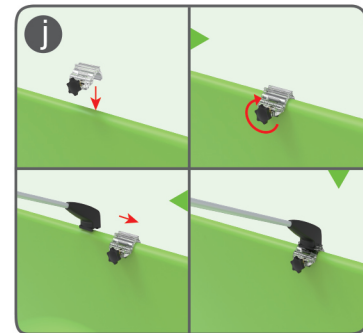
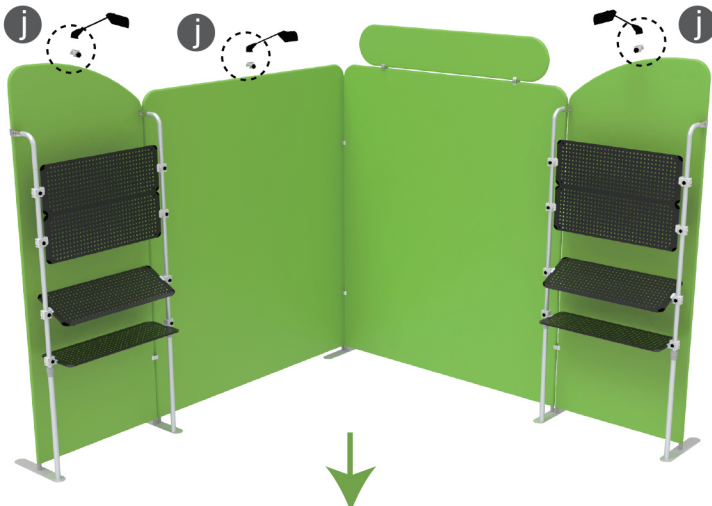

10X10FT-BOOTH-Q

## STEPS

(1) Durable Plastic Hard Case, Aluminum Support Poles



(2) Printed Graphic Fabric Banner



## STEP 01

Put hard case's top into fabric banner.

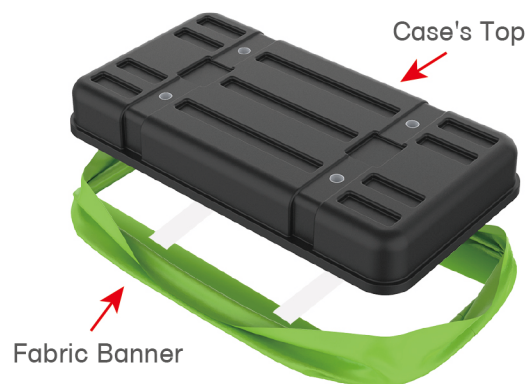

## STEP 02

Insert support poles into hard case's top &amp; bottom.

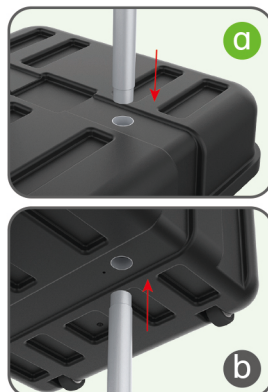
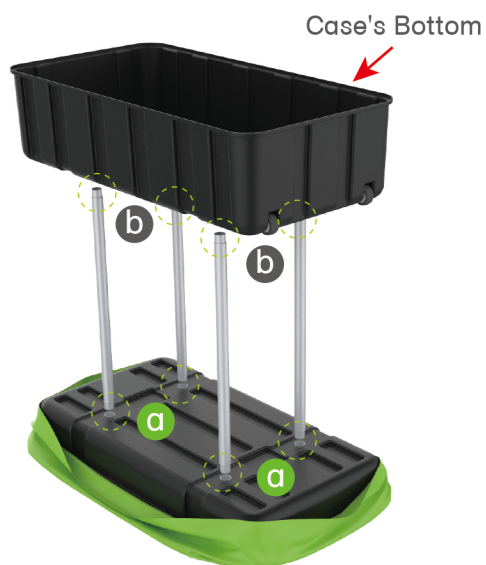

## STEPS

## STEP 04

Wrap fabric banner from bottom to top & twist it to be smooth, lay hard case's intermediate panel on podium's top.

