

# INSTRUCTION

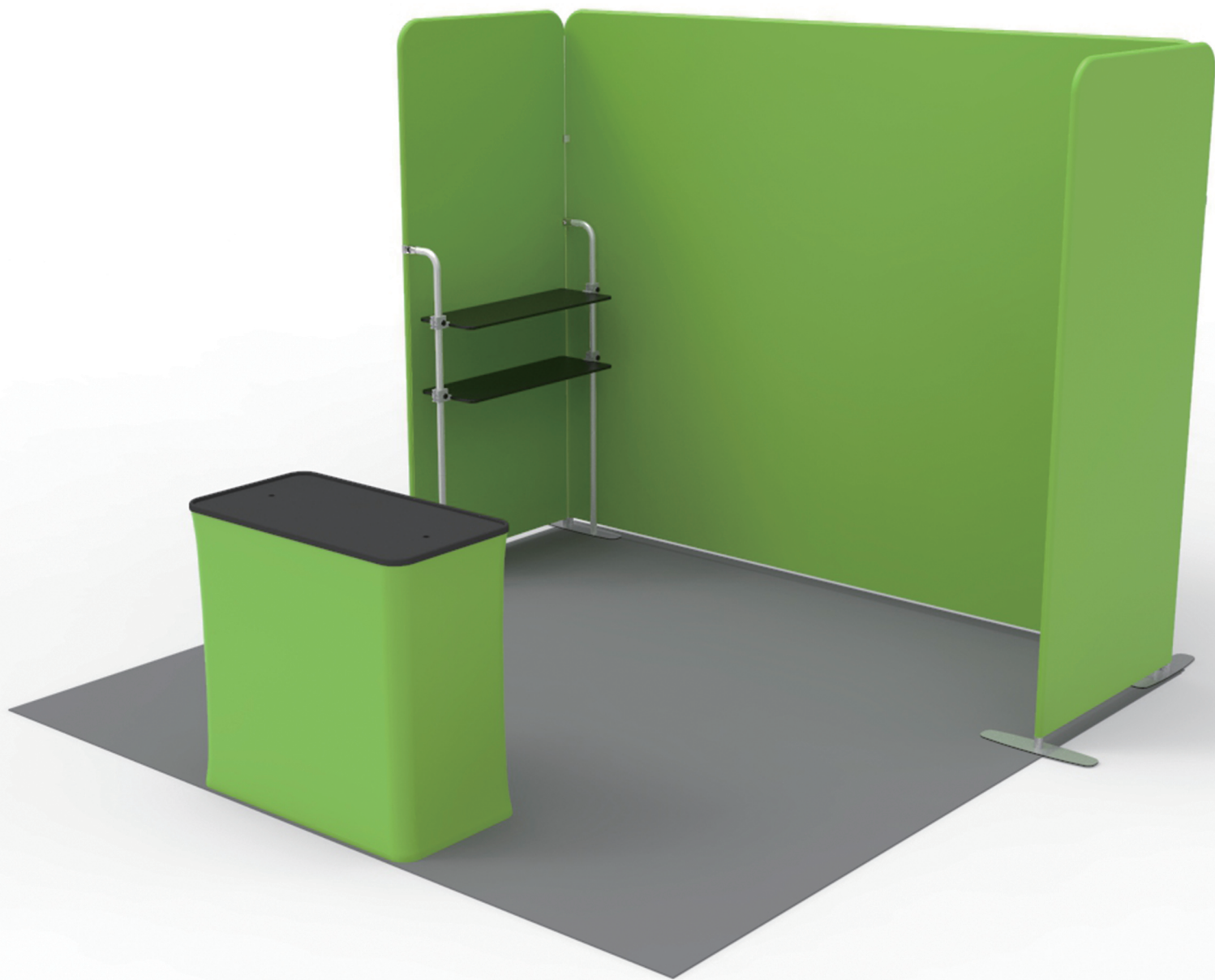

**10X10FT-BOOTH-P**

## STEPS

(1) Hardware

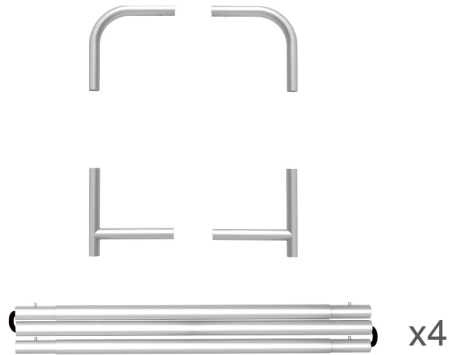

(2) Printed Graphic Fabric Banner (Optional)



## STEP 01

Connect to make long poles according to labelings.

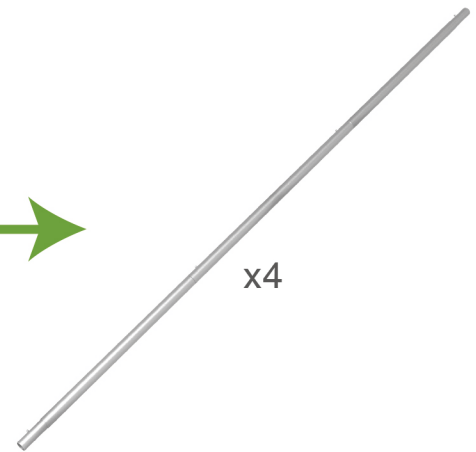
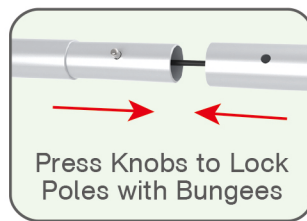
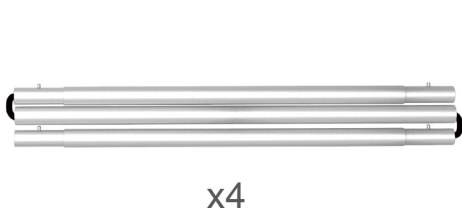

## STEP 02

Connect long poles with corner poles according to labelings.

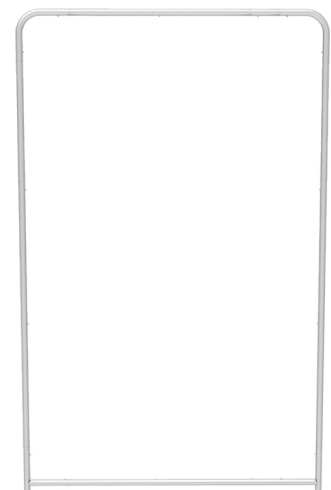
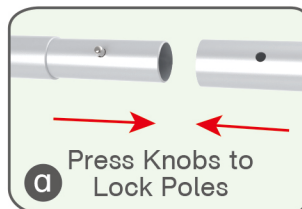
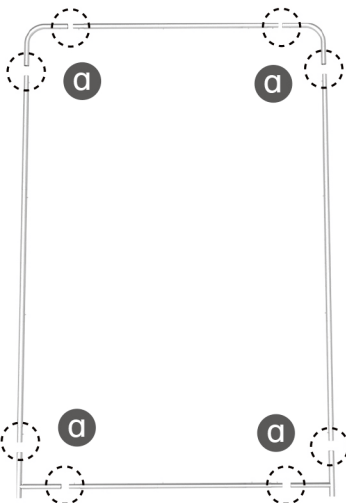

## STEPS

## STEP 03

Slide fabric banner on frame from top and zip up at bottom.

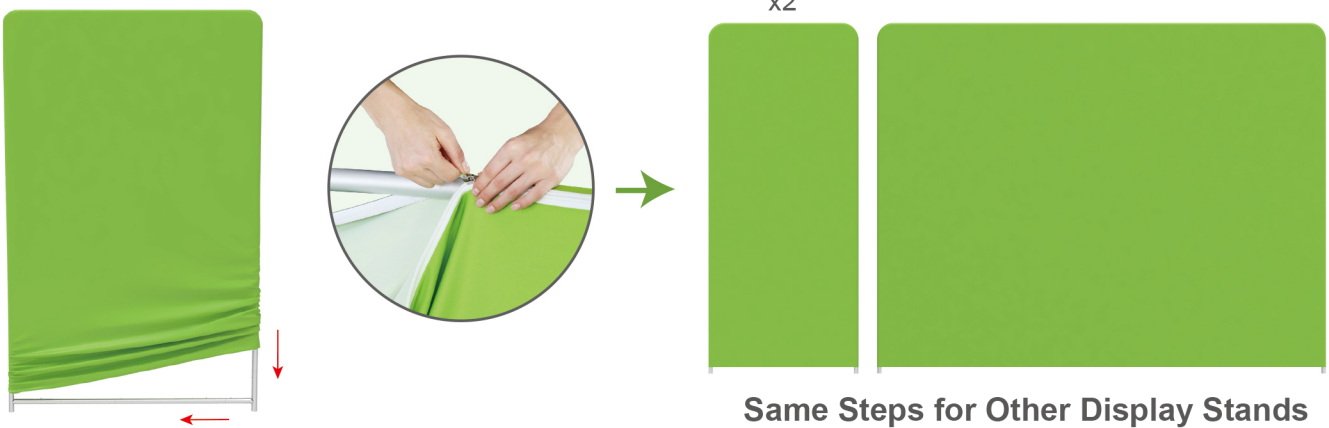

## Booth set assembly



(1) Base

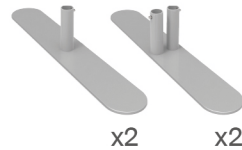

(2) 90° C-Shaped Clip



(3) Shelving Board

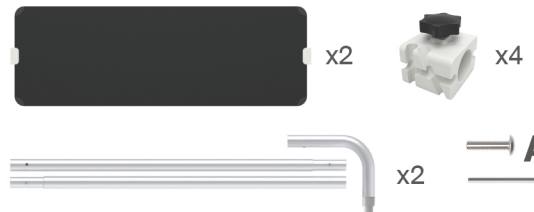

## STEP 01

Insert display stands onto feet by pressing their knobs.

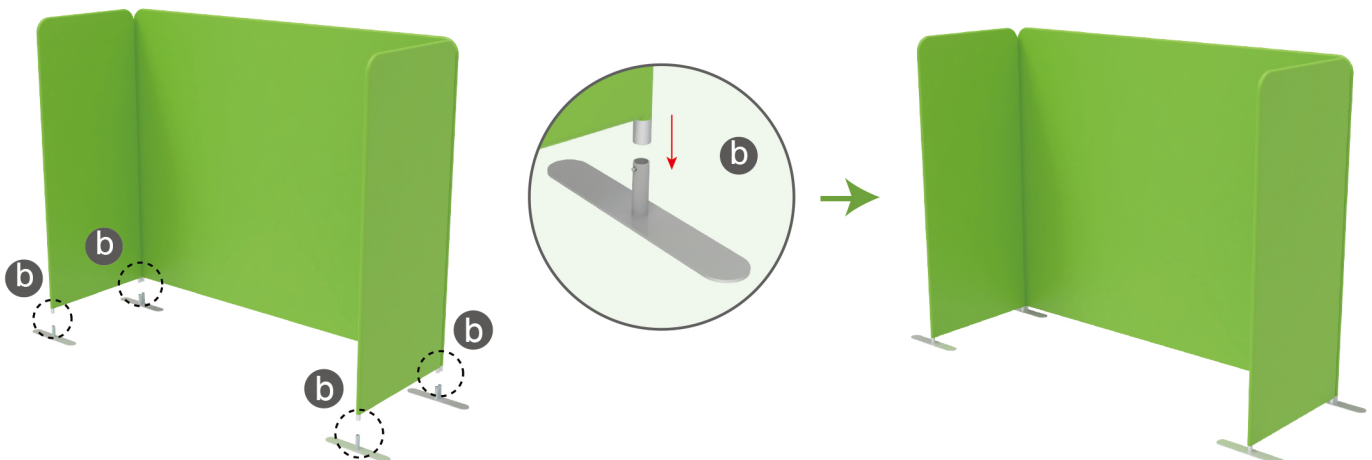

## STEPS

## STEP 02

Connect to make long poles according to labelings, slide three-way clips onto long poles, insert short curved poles onto their top by pressing their knobs.

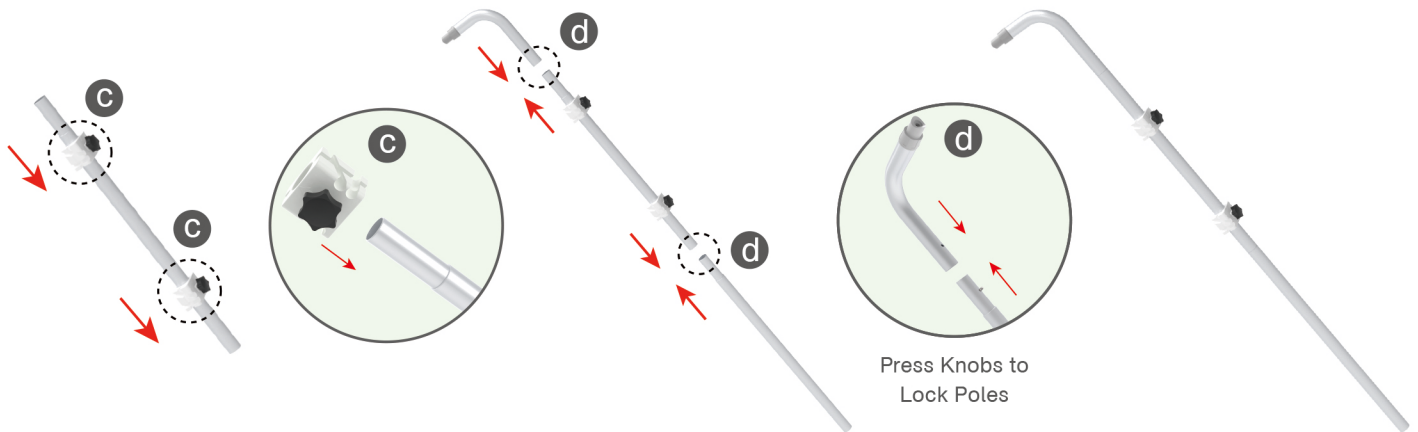

## STEP 03

Connect support poles onto frame, clip into hanging boards based on directions of three-way clips & tightening with thumb screws.

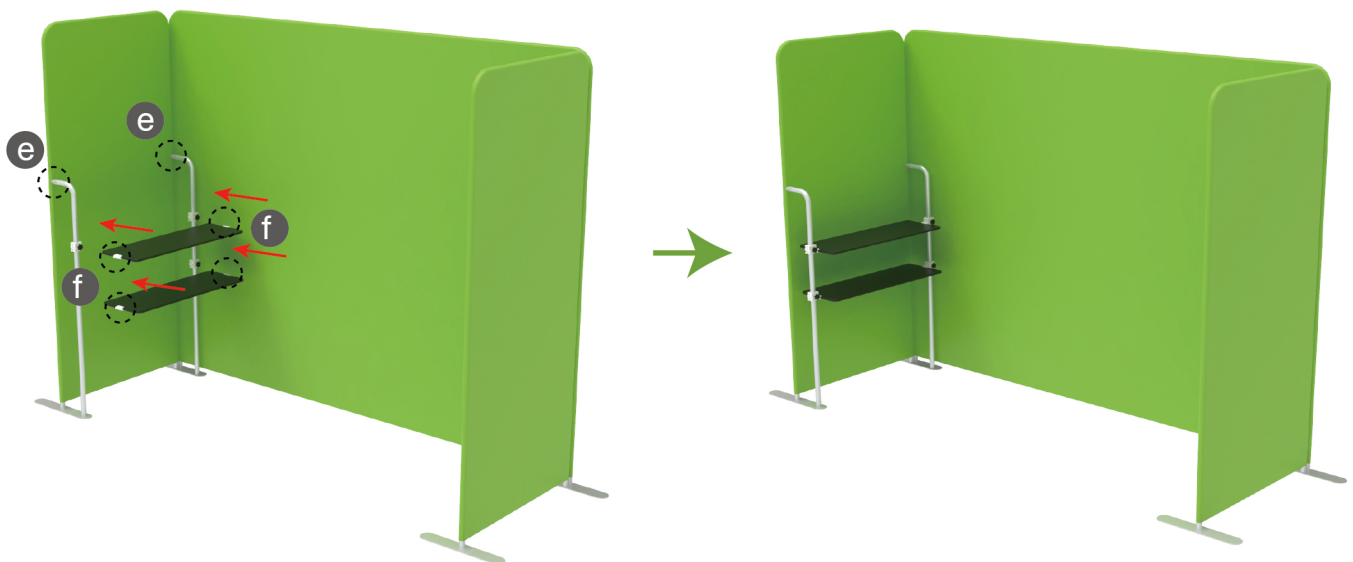
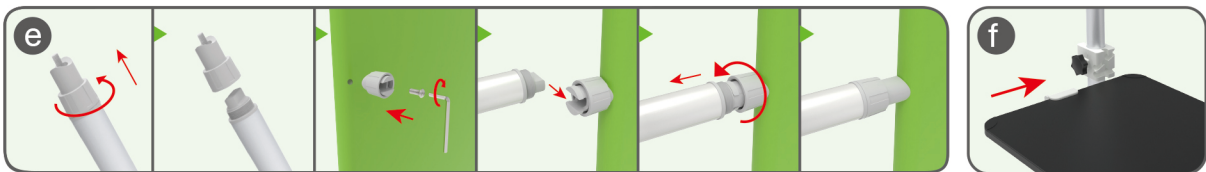



## STEPS

## STEP 04

Interconnect display stands with C-shaped clips.

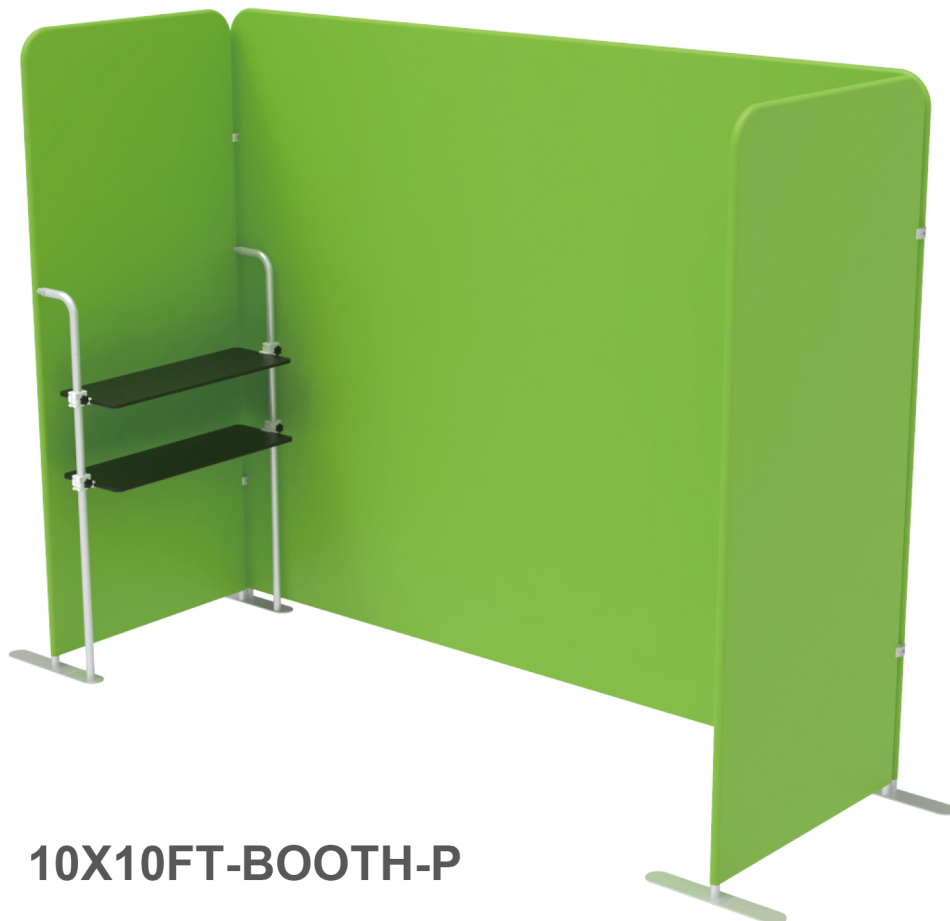
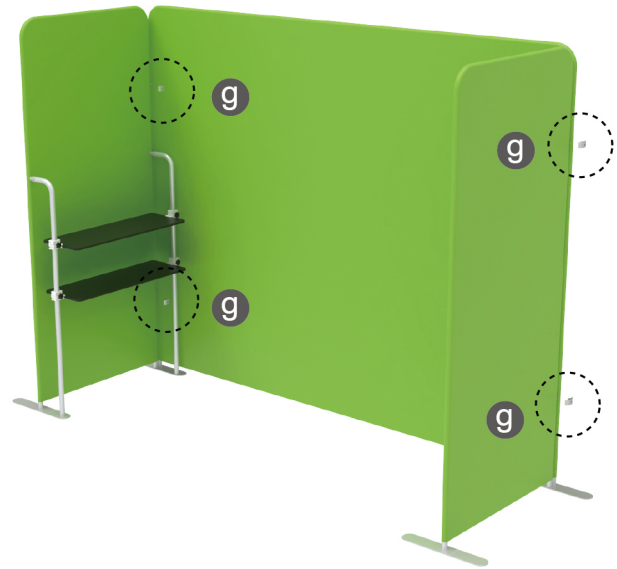
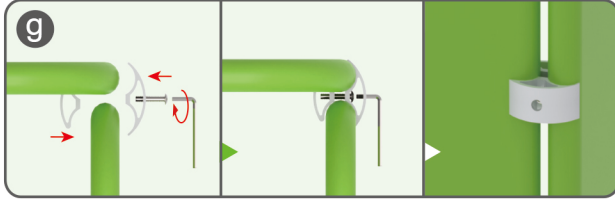

10X10FT-BOOTH-P

## STEPS

(1) Durable Plastic Hard Case, Aluminum Support Poles



(2) Printed Graphic Fabric Banner



## STEP 01

Put hard case's top into fabric banner.

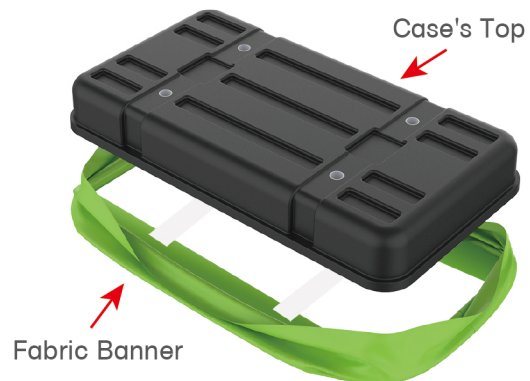

## STEP 02

Insert support poles into hard case's top &amp; bottom.

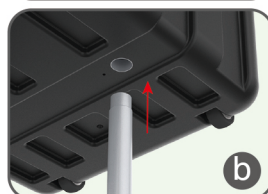
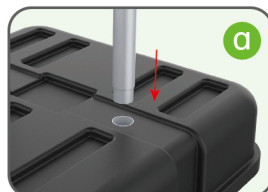
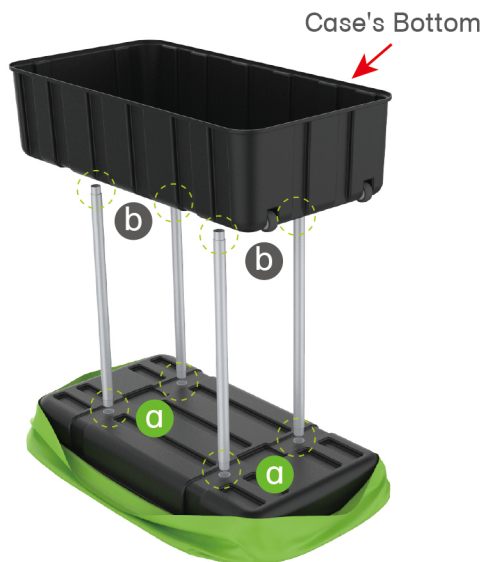

## STEPS

## STEP 04

Wrap fabric banner from bottom to top & twist it to be smooth, lay hard case's intermediate panel on podium's top.

