

# INSTRUCTION

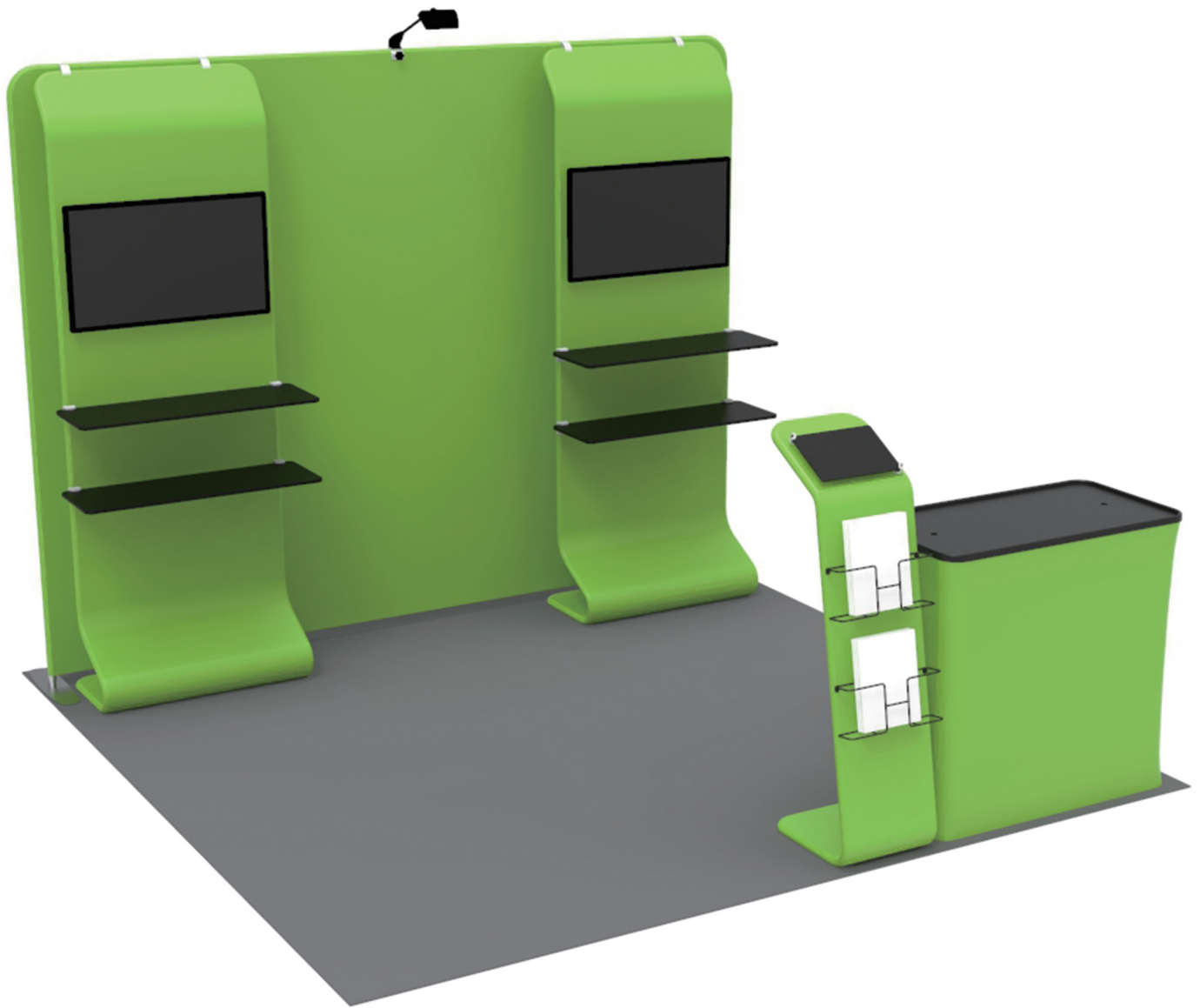

10X10FT-BOOTH-G

## STEPS

(1) Hardware

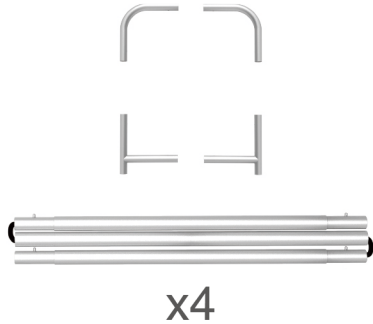

(2) Printed Graphic Fabric Banner (Optional)



## STEP 01

Connect to make long poles according to labelings.

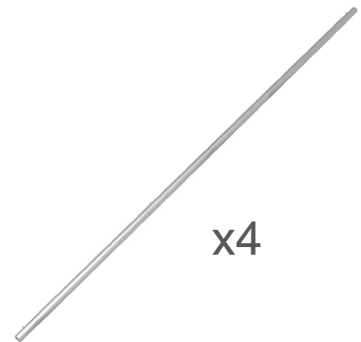
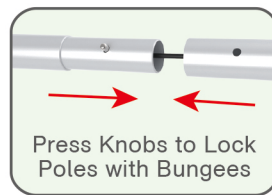
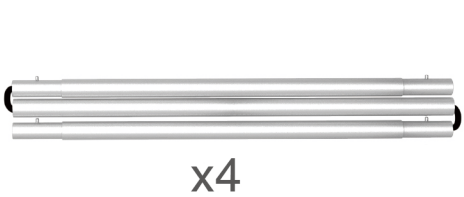

## STEP 02

Connect long poles with corner poles according to labelings.

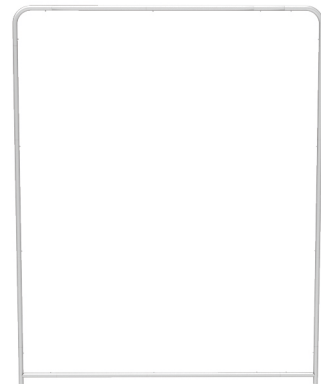
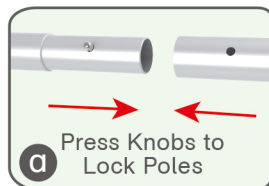
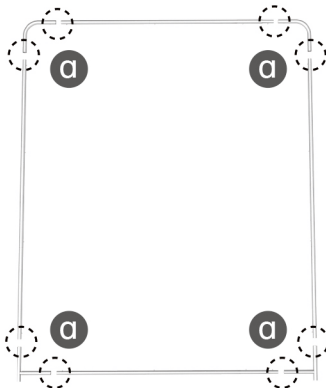

## STEP 03

Slide fabric banner on frame from top and zip up at bottom.



## STEPS

(1) Hardware

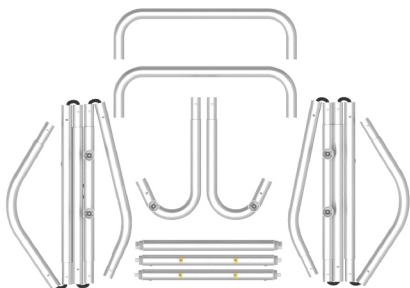

(2) Printed Graphic Fabric Banner (Optional)



## STEP 01

Connect to make long poles according to labelings.

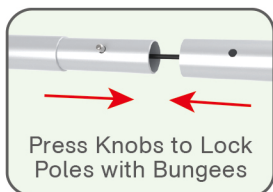

## STEP 02

Connect long poles with corner poles according to labelings.

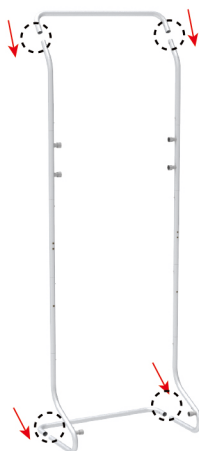
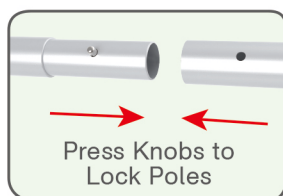
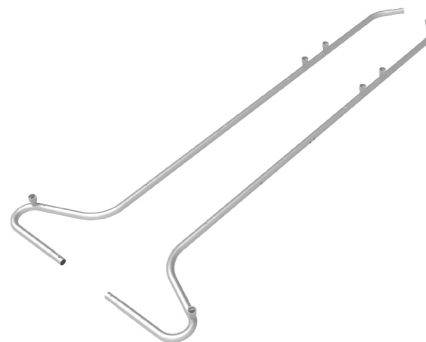
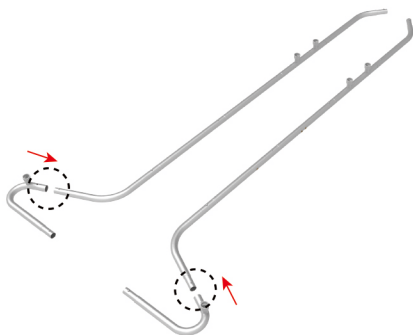

★ One Tool (Hex Wrench) 

## STEPS

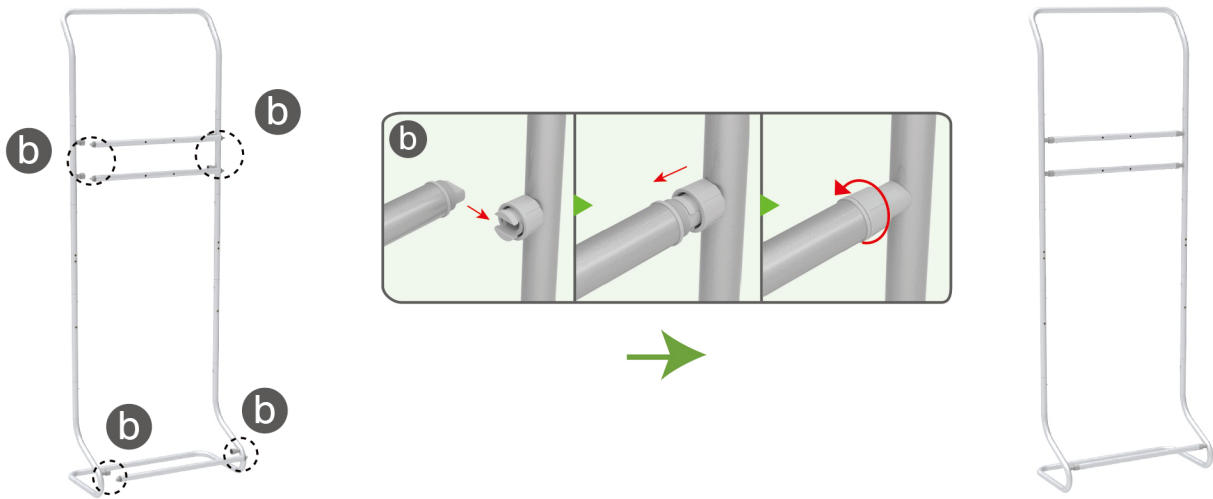
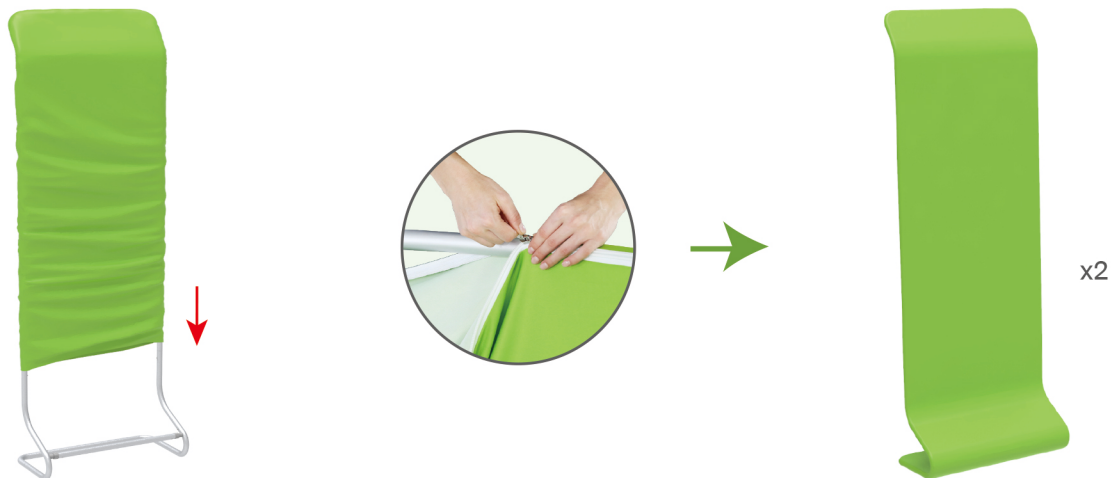
**STEP 03** Install cross bars in position.**STEP 04** Slide fabric banner on frame from top and zip up at bottom.

## Booth Set Assembly

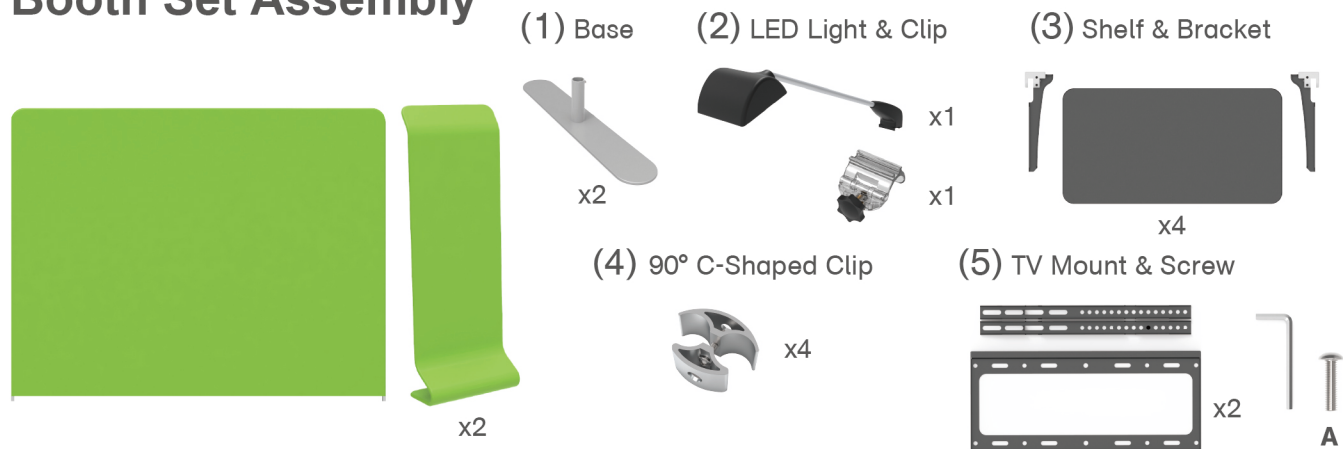

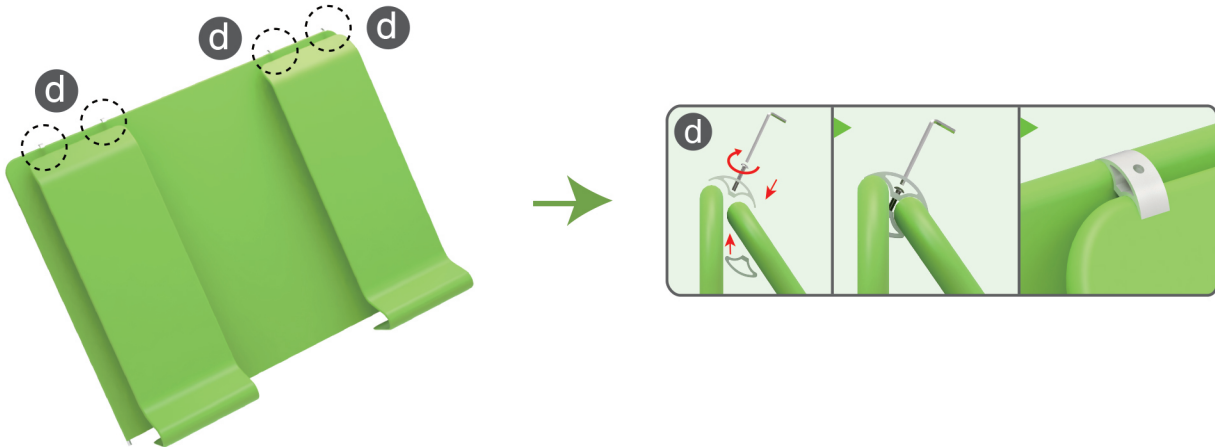
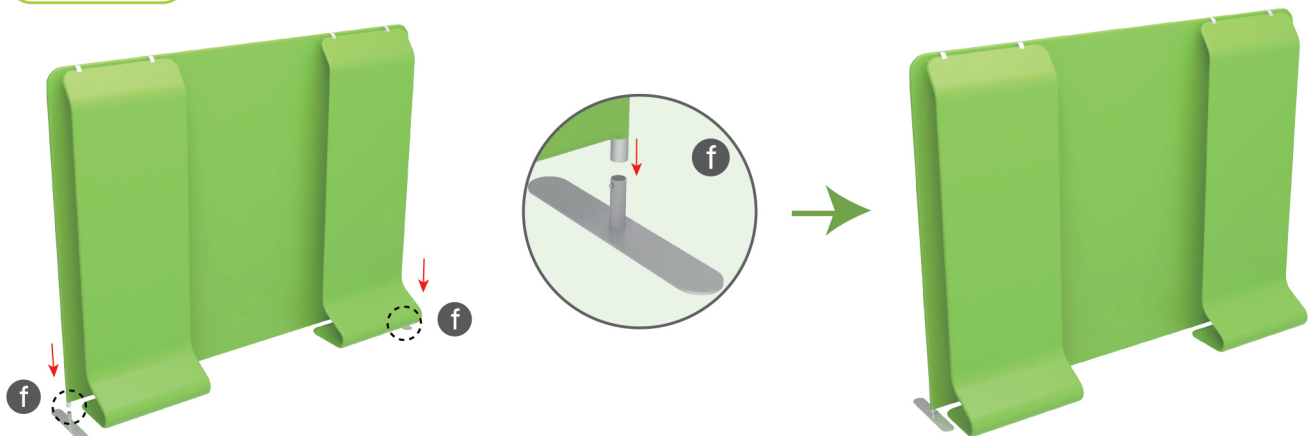

## STEPS

**STEP 01** Interconnect display stands with C-shaped clips.**STEP 02** Insert display stands onto feet by pressing their knobs.**STEP 03**

Screw TV mount onto display stand &amp; support brackets onto TV's back with hex wrench, hang TV onto mount &amp; screw.

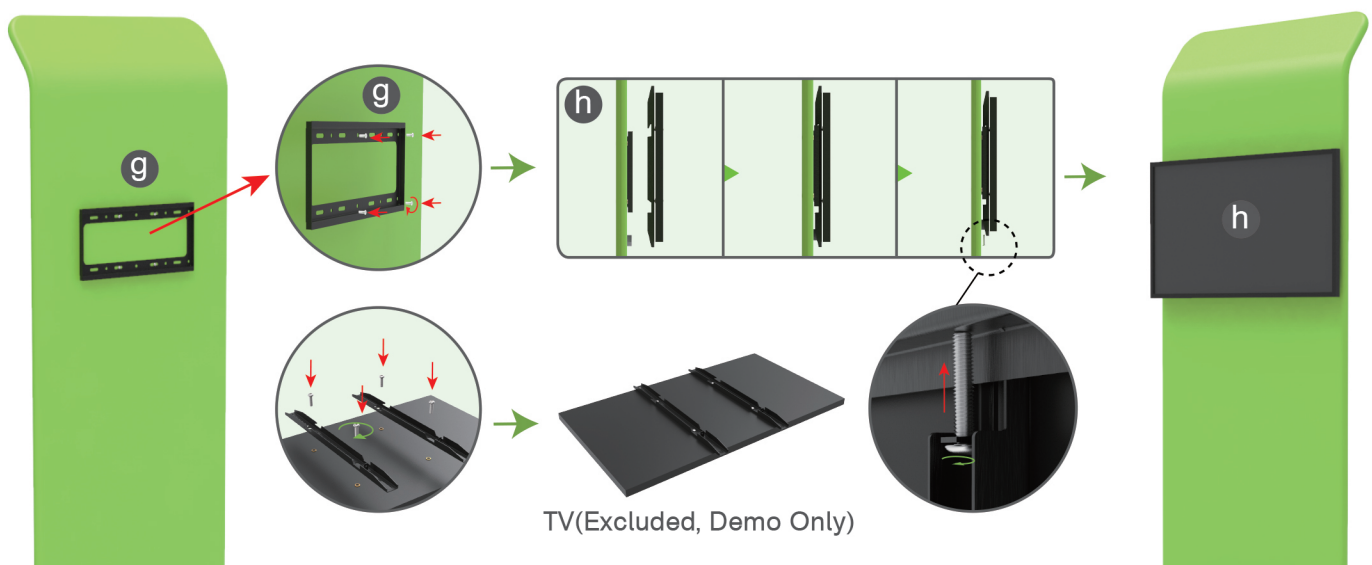

## STEPS

## STEP 04

Screw brackets onto display stand with hex wrench, insert shelves into slots.

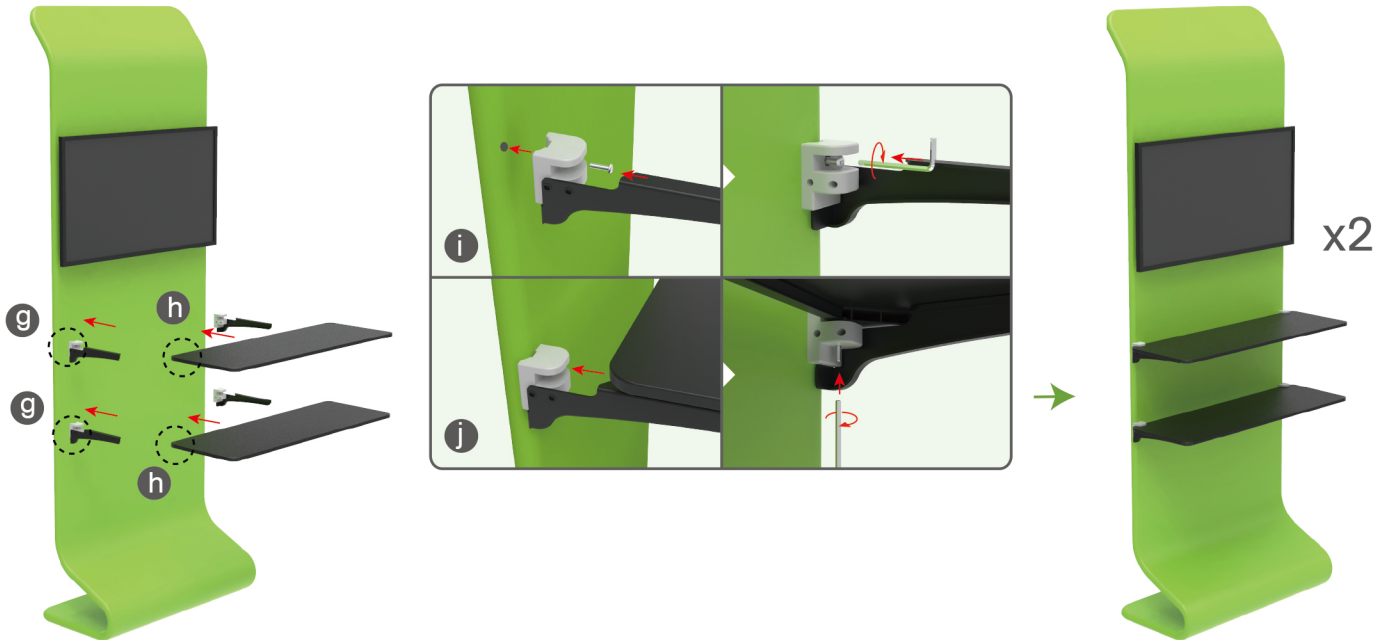

## STEP 05

Screw light clips at top of display stands, slide lights onto them and adjust their direction.

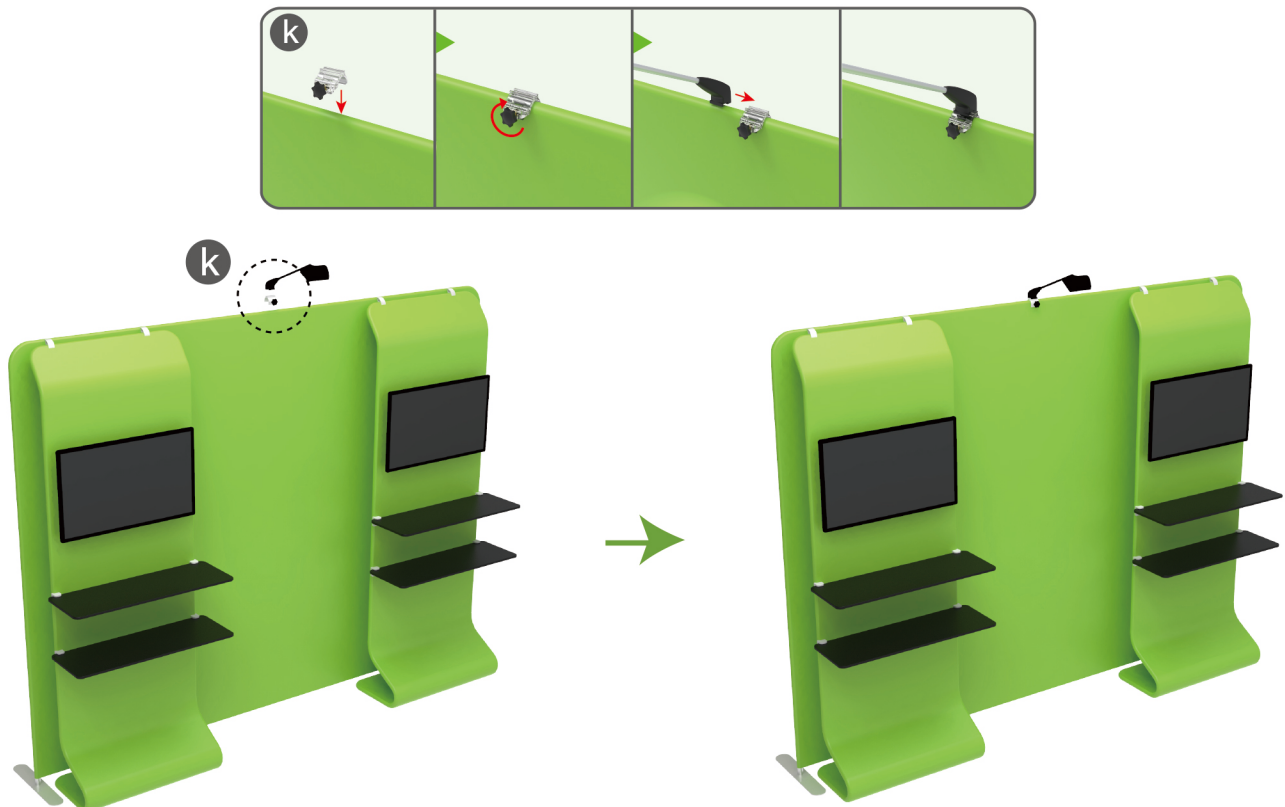

**STEPS****10X10FT-BOOTH-G**

## STEPS

(1) Durable Plastic Hard Case, Aluminum Support Poles



(2) Printed Graphic Fabric Banner



## STEP 01

Put hard case's top into fabric banner.

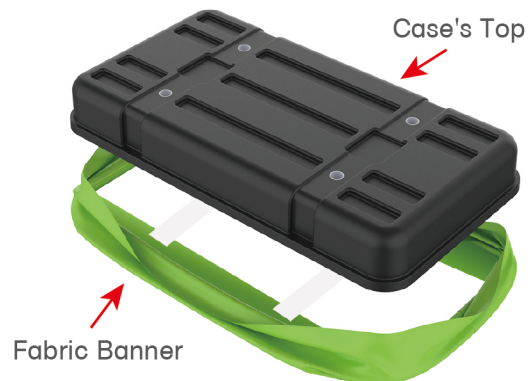

## STEP 02

Insert support poles into hard case's top &amp; bottom.

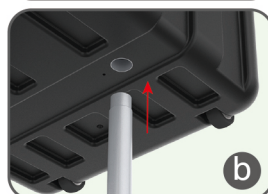
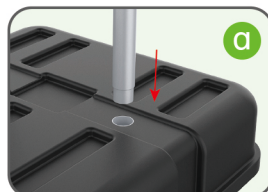
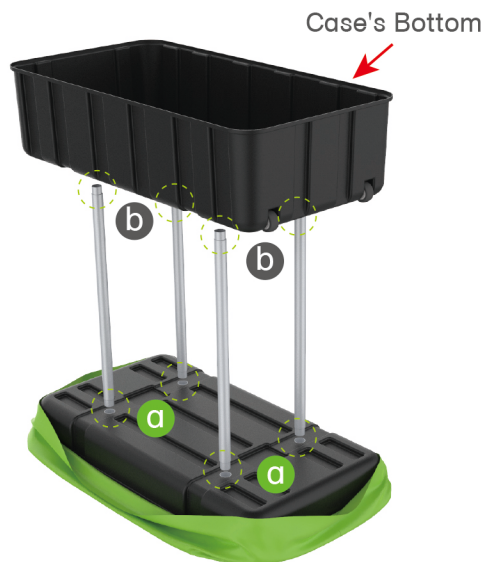



## STEPS

## STEP 04

Wrap fabric banner from bottom to top & twist it to be smooth, lay hard case's intermediate panel on podium's top.

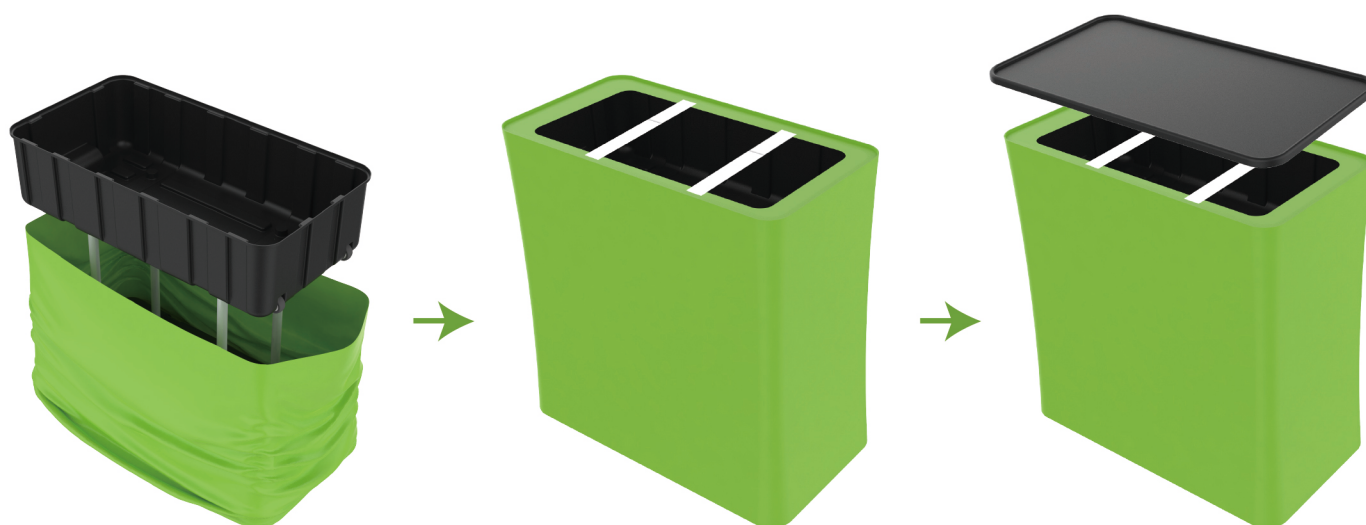

★ One Tool (Hex Wrench) **STEPS**

(1) Snap Tubes

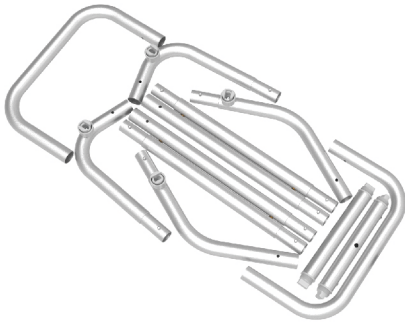

(2) Printed fabric banner

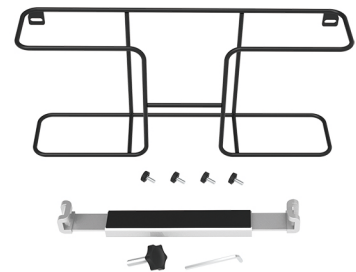
(3) Brochure rack x 2 / Screws x 4  
Tablet PC holder x1**STEP 01**

To Connect the tubes according to the labellings

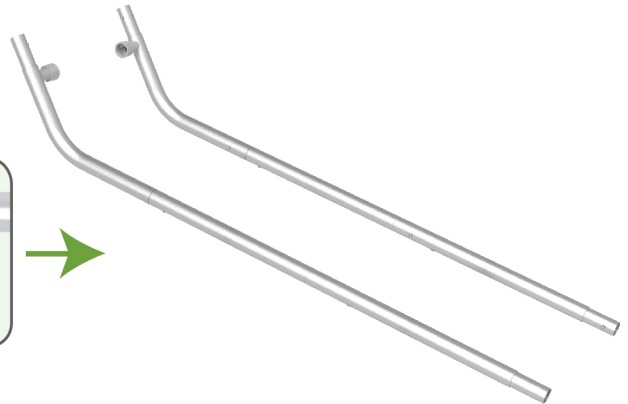
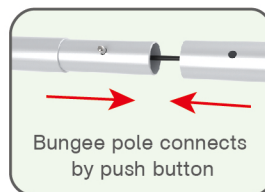
**STEP 02**

To connect 2 long side tubes by the corner pieces

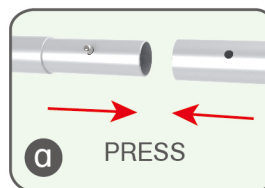



## STEPS

## STEP 03

To install the cross bar according to labellings

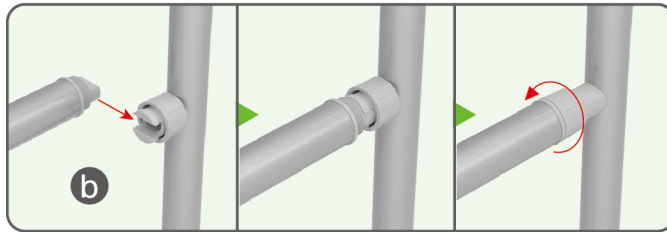

## STEP 04

To wrap the fabric from top to the middle of frame, then put the iPad in the holder and adjust the holder to right size and lock it by Allen Key Afterwards, install the set to the display stand.

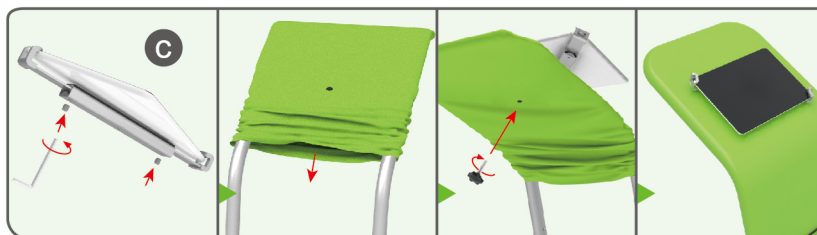

## STEPS

## STEP 05

To pull the fabric banner to bottom and zip up.



## STEP 06

To Install 2 racks by screws in position

