

INSTRUCTION



10X10FT-BOOTH-08

STEPS

(1) Hardware

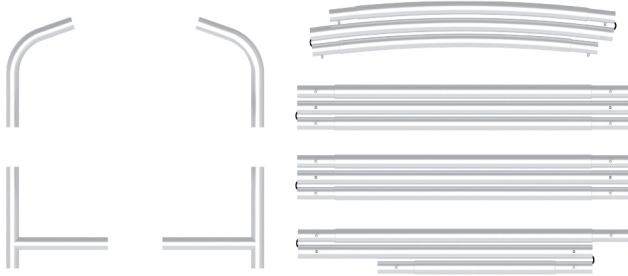

(2) Printed Graphic Fabric Banner (Optional)



STEP 01

Connect to make long poles according to labelings.

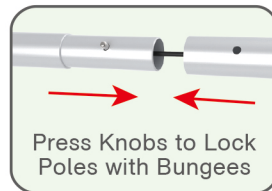

STEP 02

Connect long poles with corner poles according to labelings.

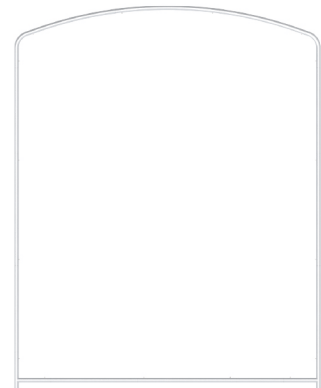
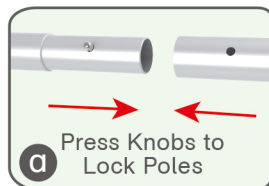
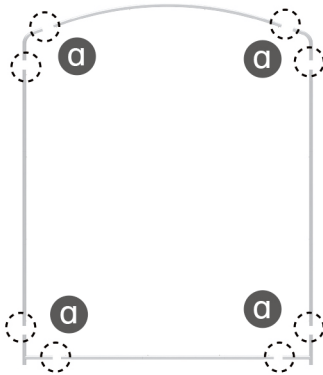

STEP 03

Slide fabric banner on frame from top and zip up at bottom.

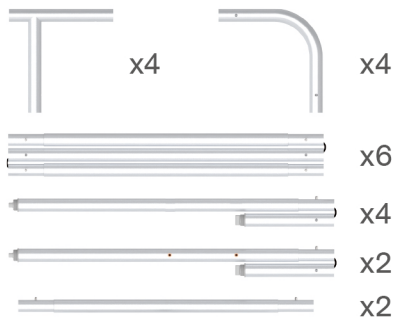
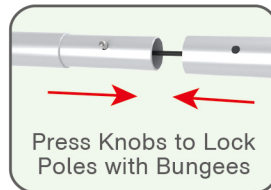
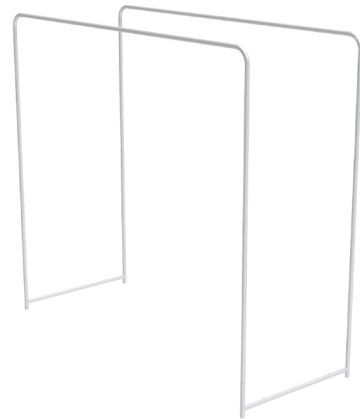
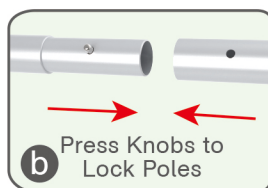
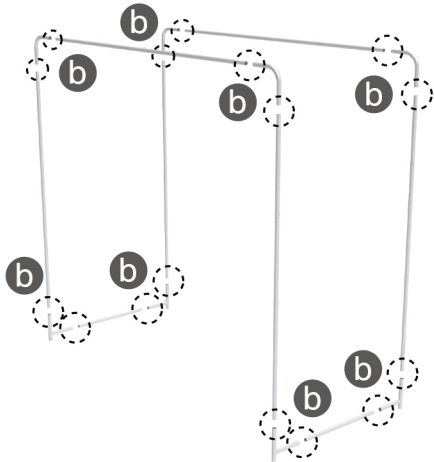

STEPS**(1) Hardware****(2) Printed Graphic Fabric Banner (Optional)****STEP 01** Connect to make long poles according to labelings.**STEP 02** Connect long poles with corner poles according to labelings.**STEP 03**

Connect support poles onto frame.

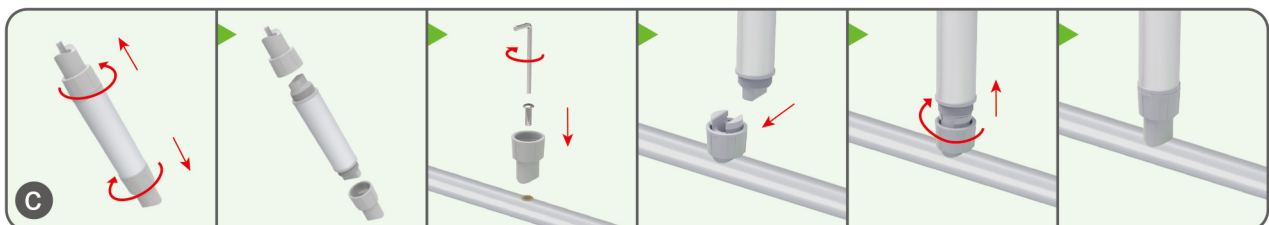

STEPS

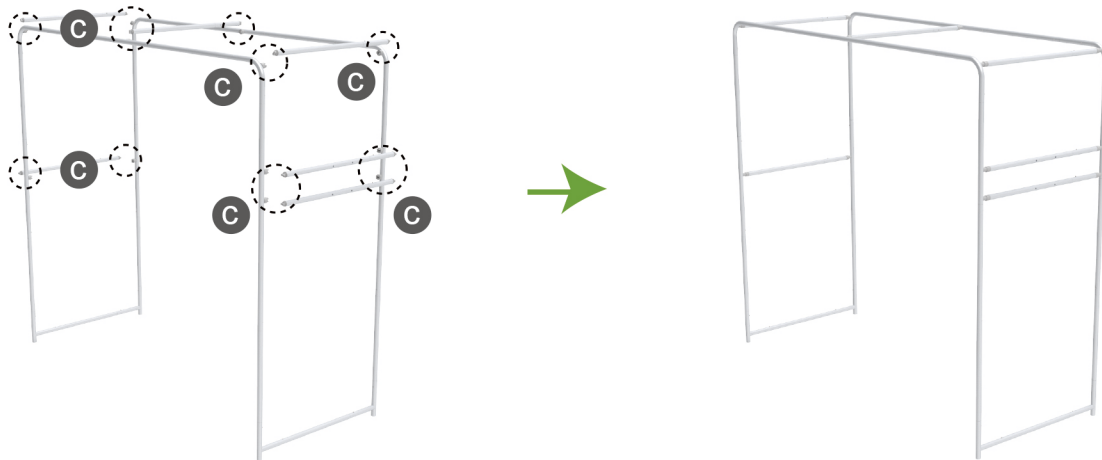

STEP 04 Lay down display stand, slide fabric banner on frame from bottom and zip up at top.

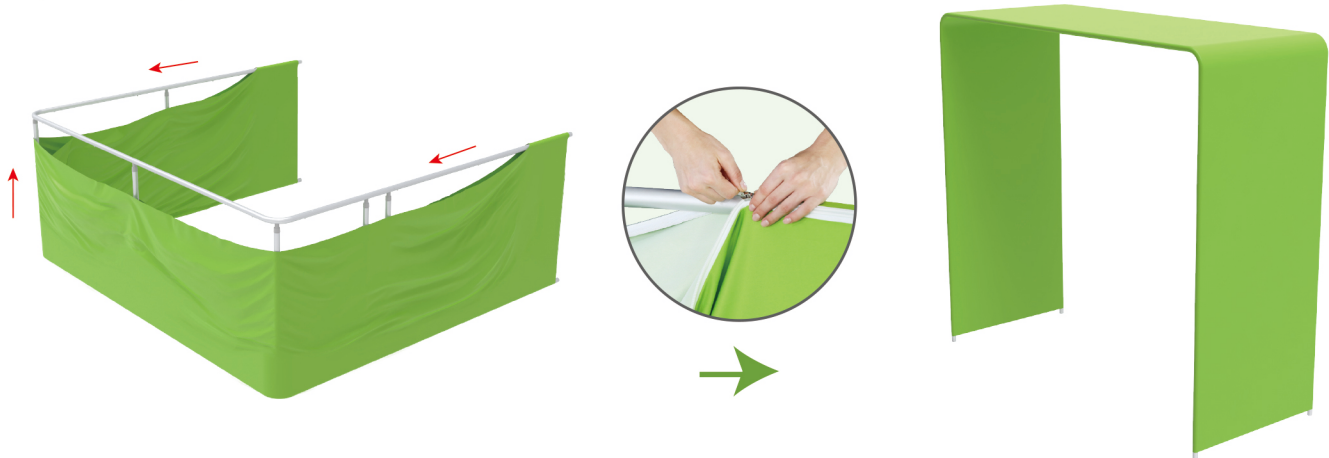

Booth Set Assembly

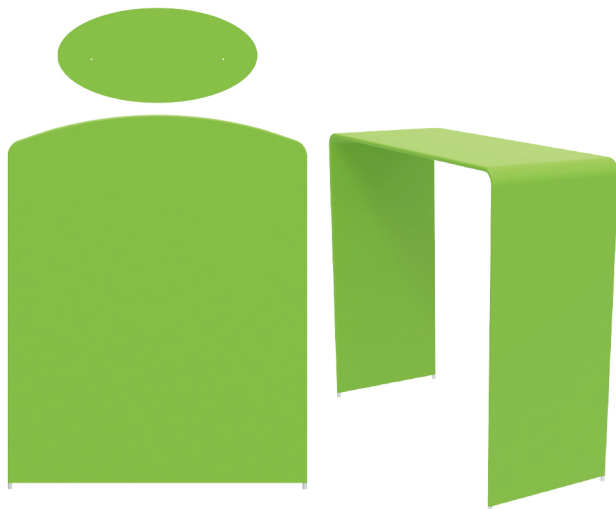

(1) Base

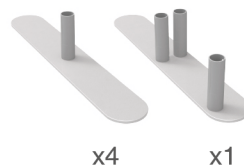

(2) TV Mount & Screw

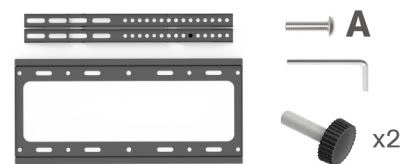

(3) MDF Board Table

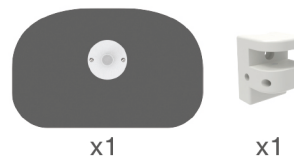

(4) 180° C-Shaped Clip



STEPS

STEP 01 Screw header onto display stand with thumb screws.

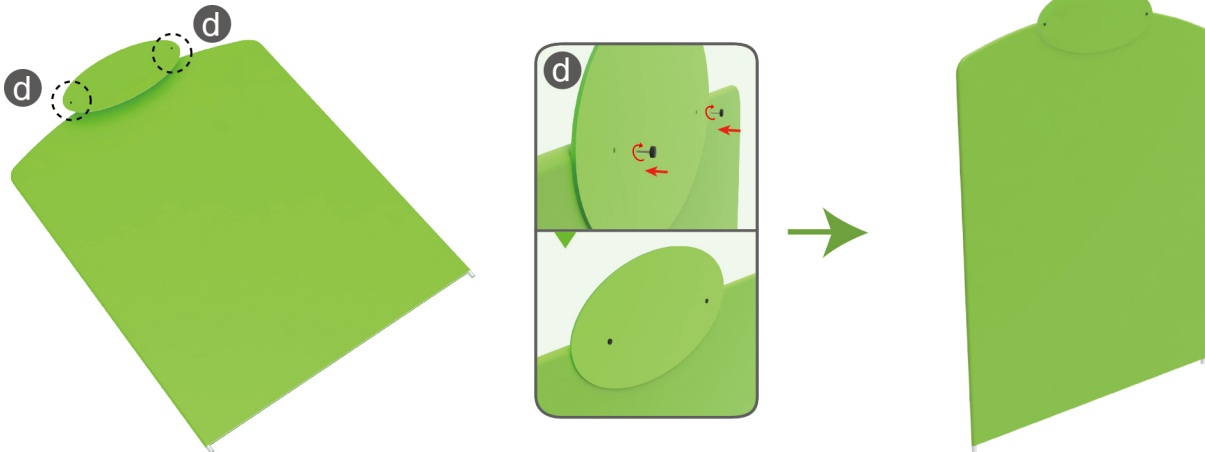

STEP 02 Insert display stands onto feet by pressing their knobs.

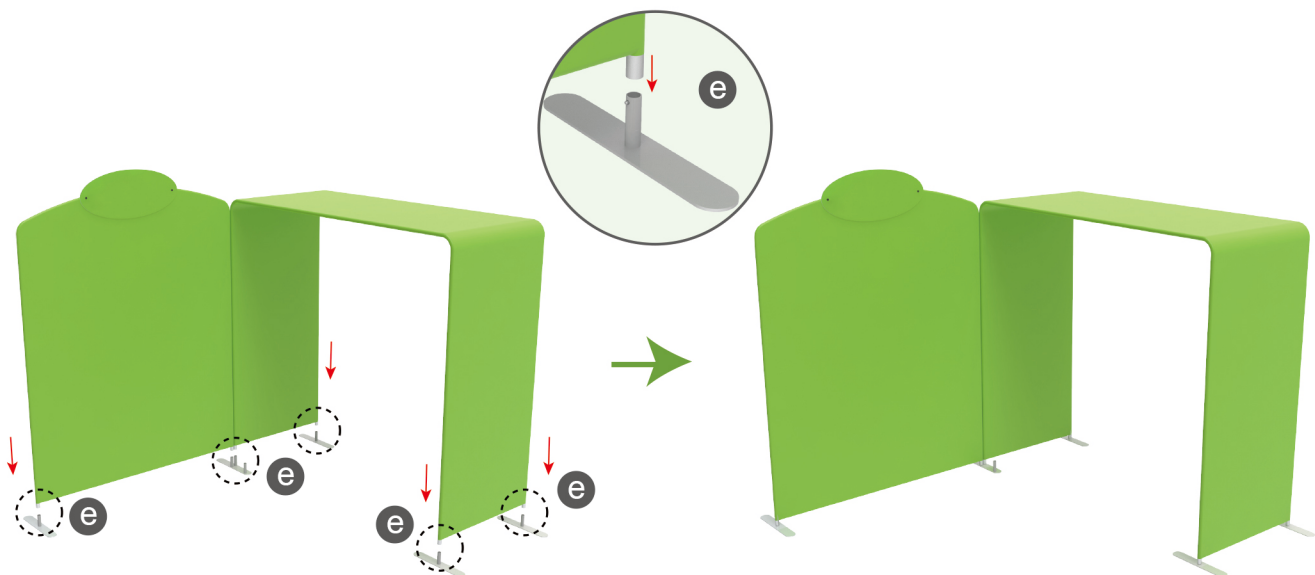

STEP 03 Interconnect display stands with C-shaped clips.

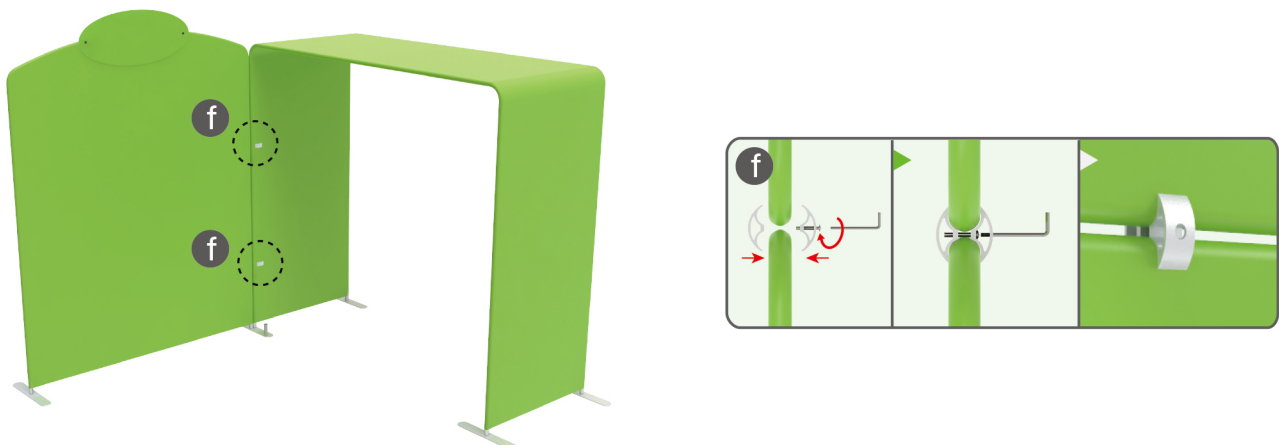

STEPS

STEP 04

Insert pole into base, screw clamp with hex wrench, place MDF board onto pole & insert into clamp with screw.

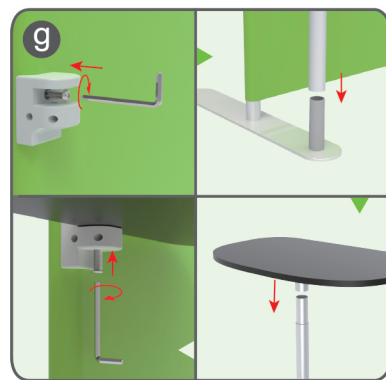
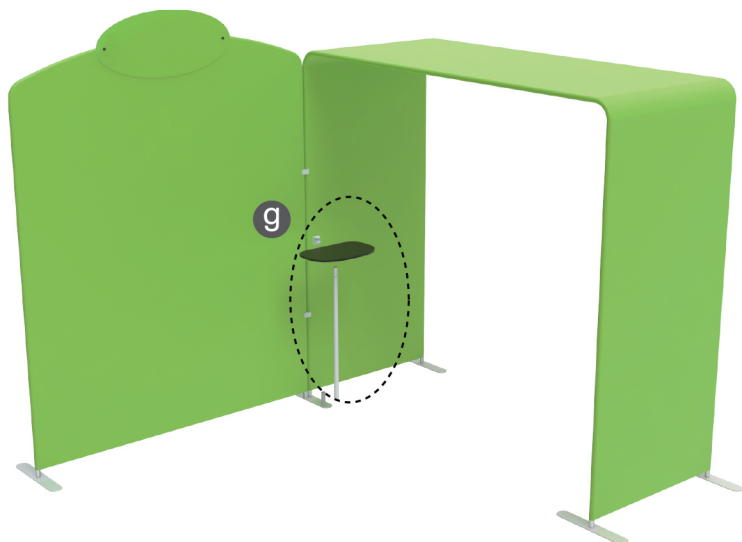

STEP 05

Screw TV mount with hex wrench.

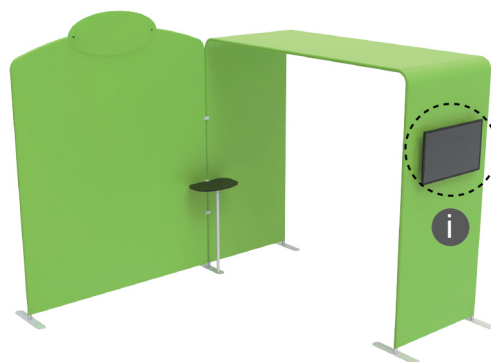
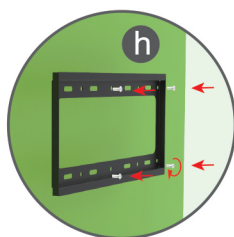
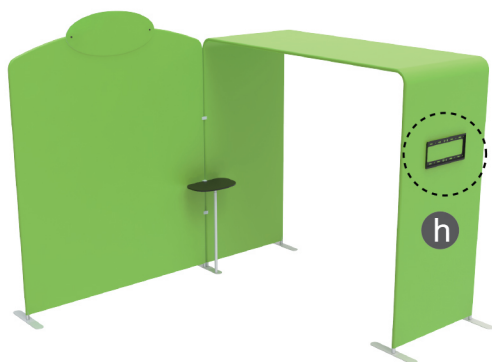

TV (Excluded, Demo Only)

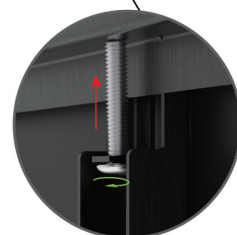
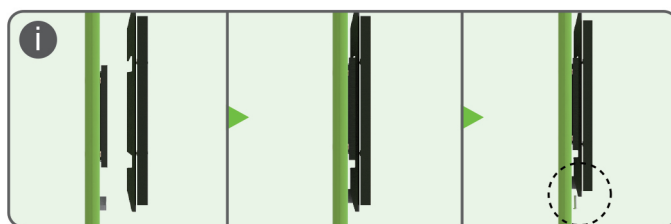
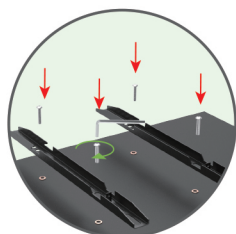
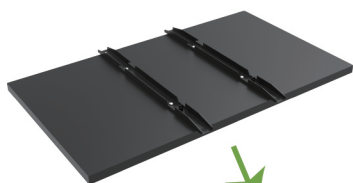

STEPS**10X10FT-BOOTH-08**

STEPS

(1) Durable Plastic Hard Case, Aluminum Support Poles



(2) Printed Graphic Fabric Banner



STEP 01

Put hard case's top into fabric banner.

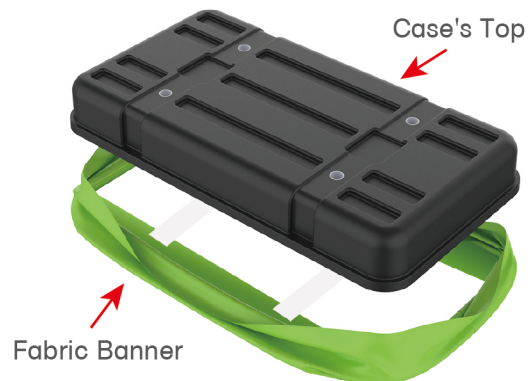

STEP 02

Insert support poles into hard case's top & bottom.

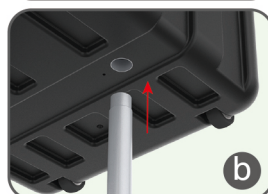
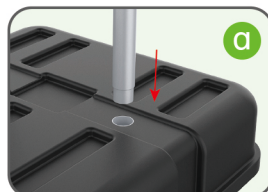
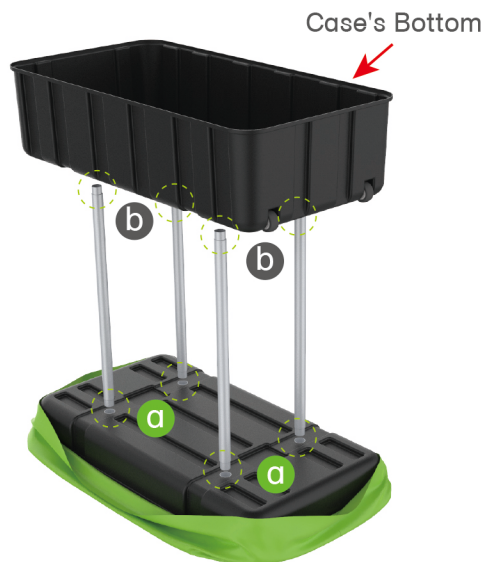

STEPS

STEP 04

Wrap fabric banner from bottom to top & twist it to be smooth, lay hard case's intermediate panel on podium's top.

