

INSTRUCTION

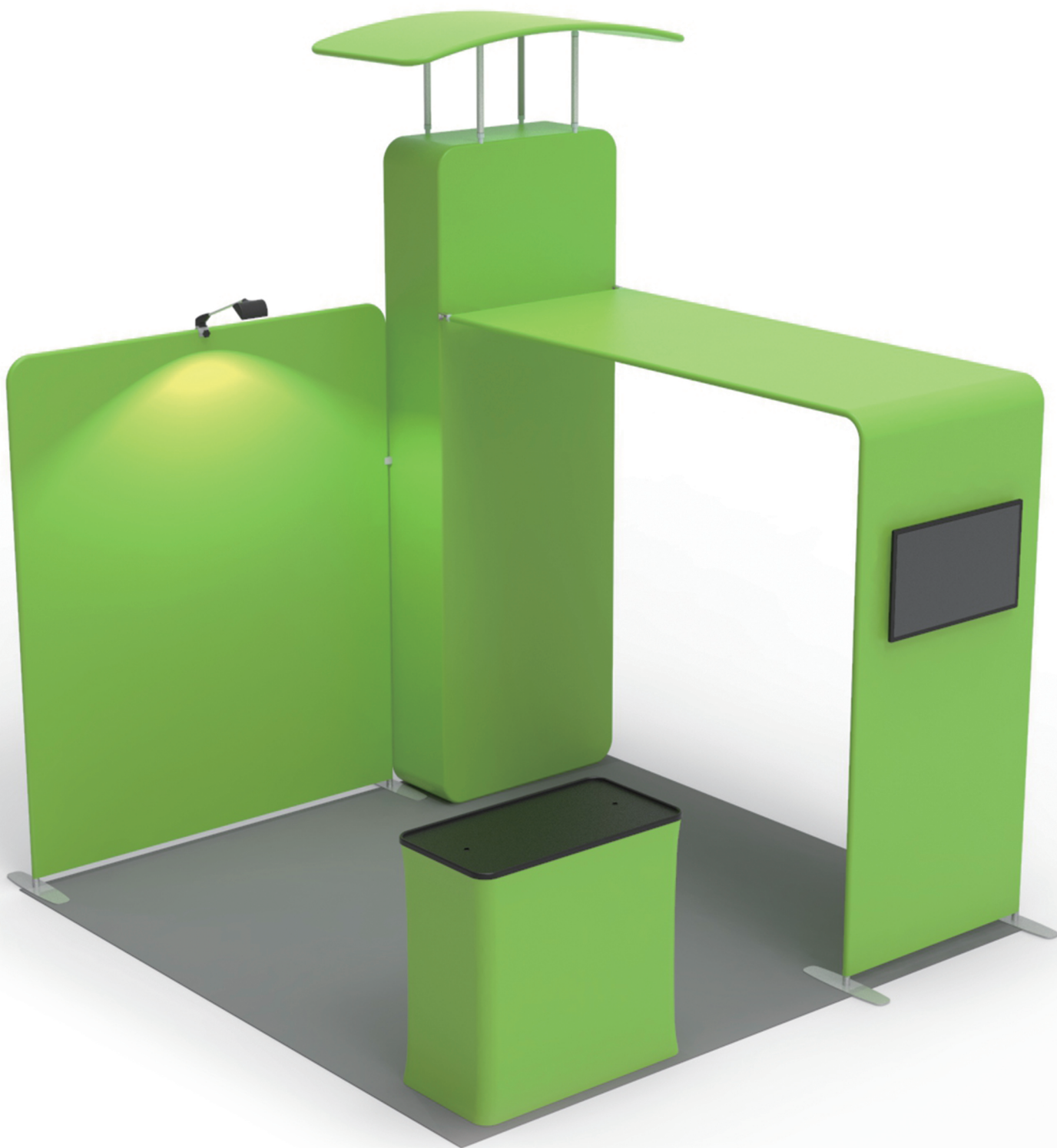

10X10FT-BOOTH-07

STEPS

(1) Hardware

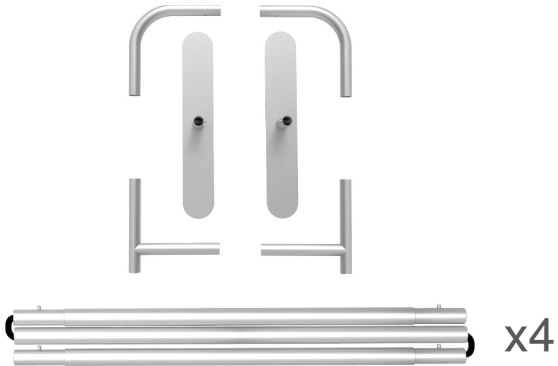

(2) Printed Graphic Fabric Banner (Optional)



STEP 01

Connect to make long poles according to labelings.

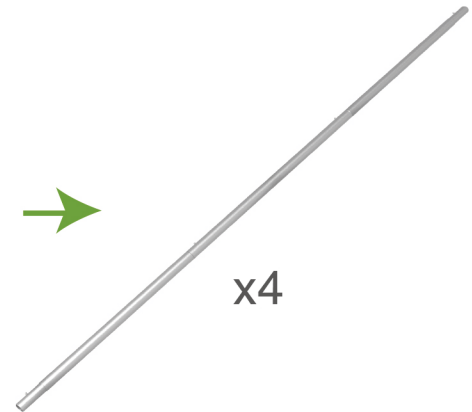
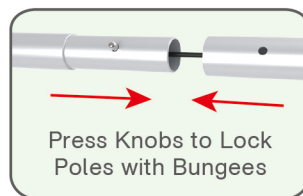
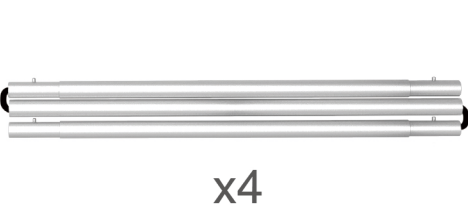

STEP 02

Connect long poles with corner poles according to labelings.

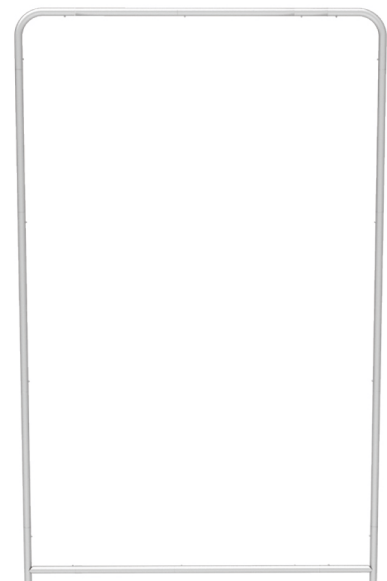
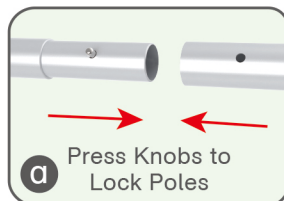
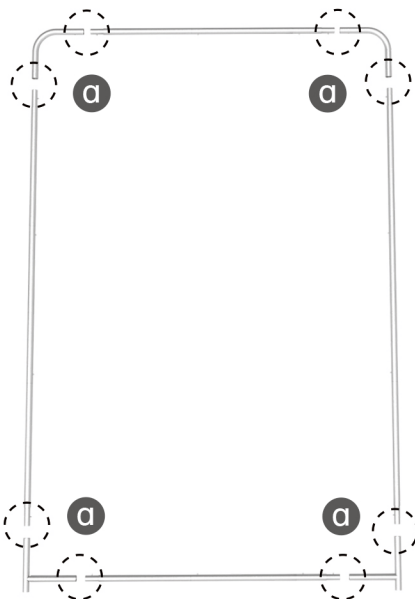

STEPS

STEP 03

Slide fabric banner on frame from top and zip up at bottom.

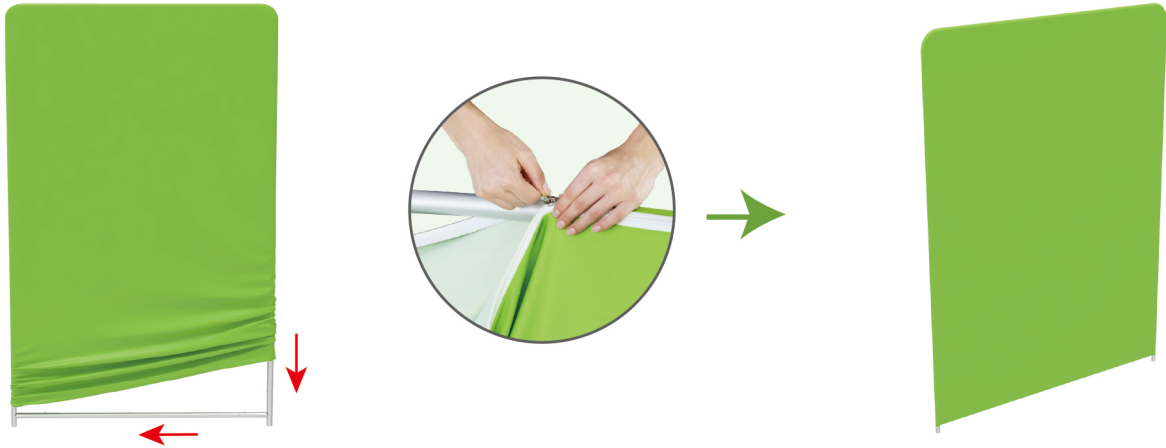

STEP 04

Insert display stand onto feet by pressing their knobs.

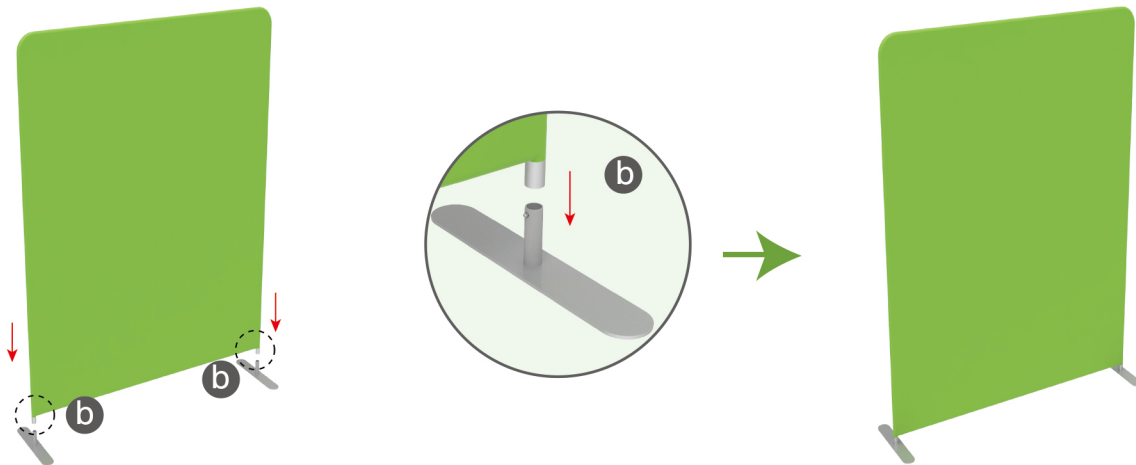

(1) Hardware

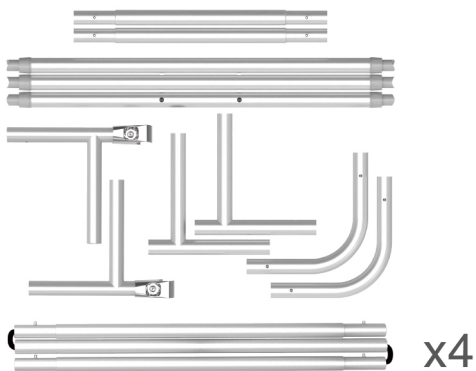

(2) Printed Graphic Fabric Banner (Optional)



STEPS

STEP 01

Connect to make long poles according to labelings.

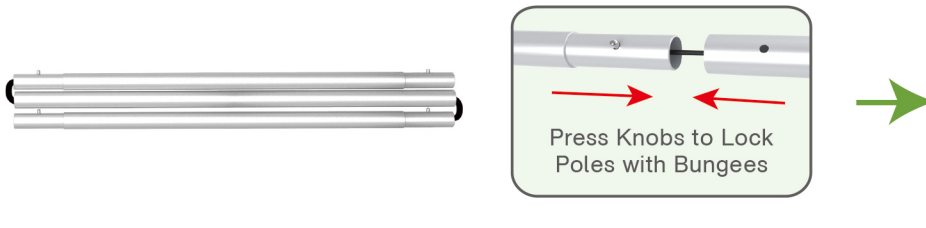

STEP 02

Connect long poles with corner poles according to labelings.

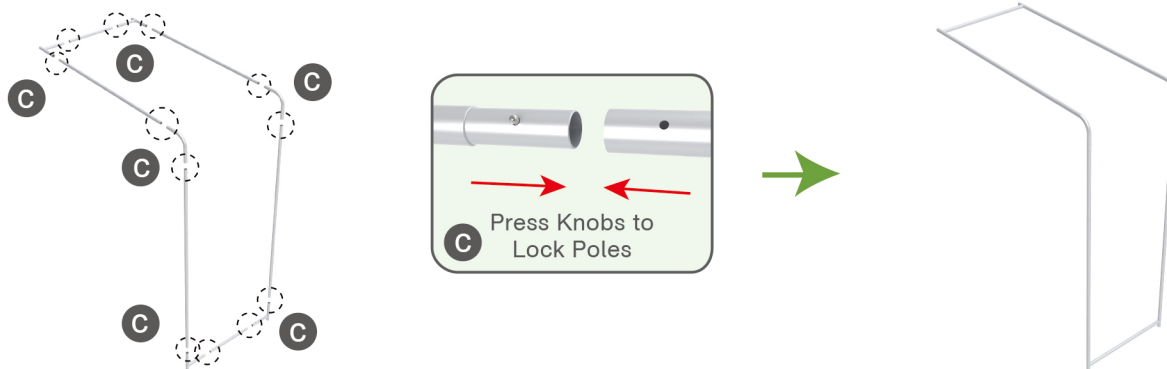

STEP 03

Connect support poles onto frame.

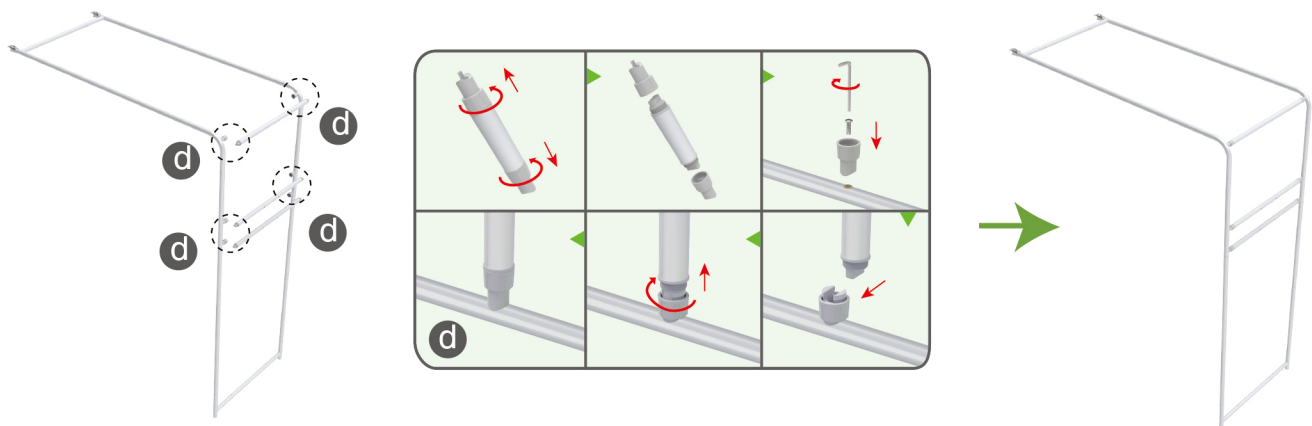

STEP 04

Slide fabric banner on frame from top and zip up at bottom.

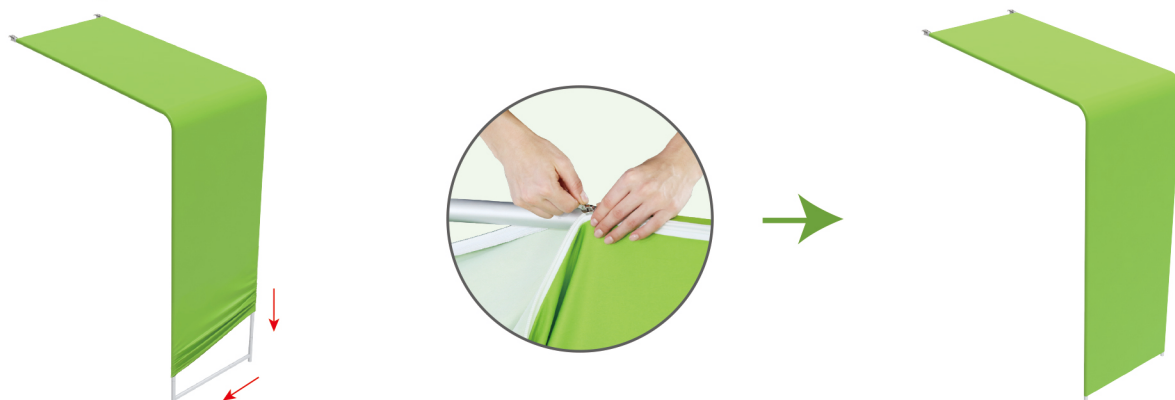

STEPS

(1) Hardware

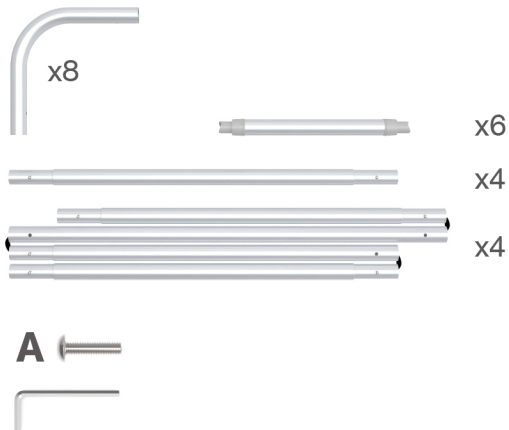

(2) Printed Graphic Fabric Banner (Optional)



STEP 01

Connect to make long poles according to labelings.

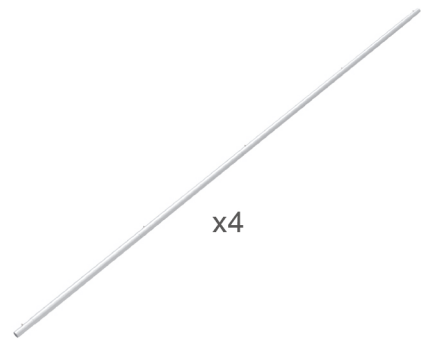
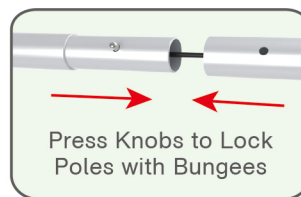

STEP 02

Connect long poles with corner poles according to labelings.

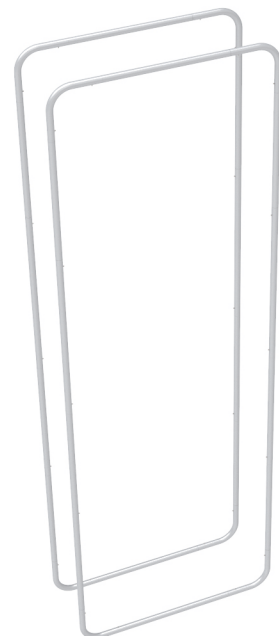
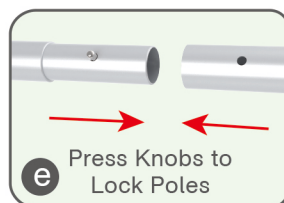
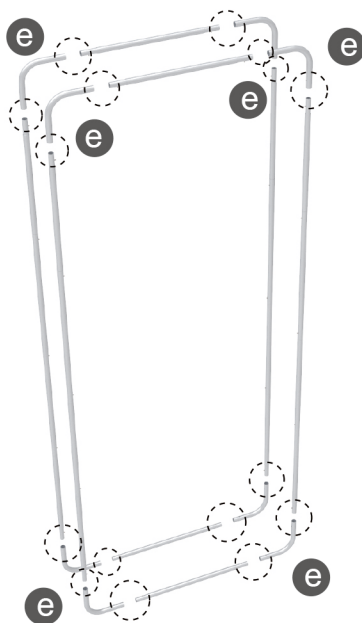

STEPS

STEP 03

Connect support poles onto column frame.

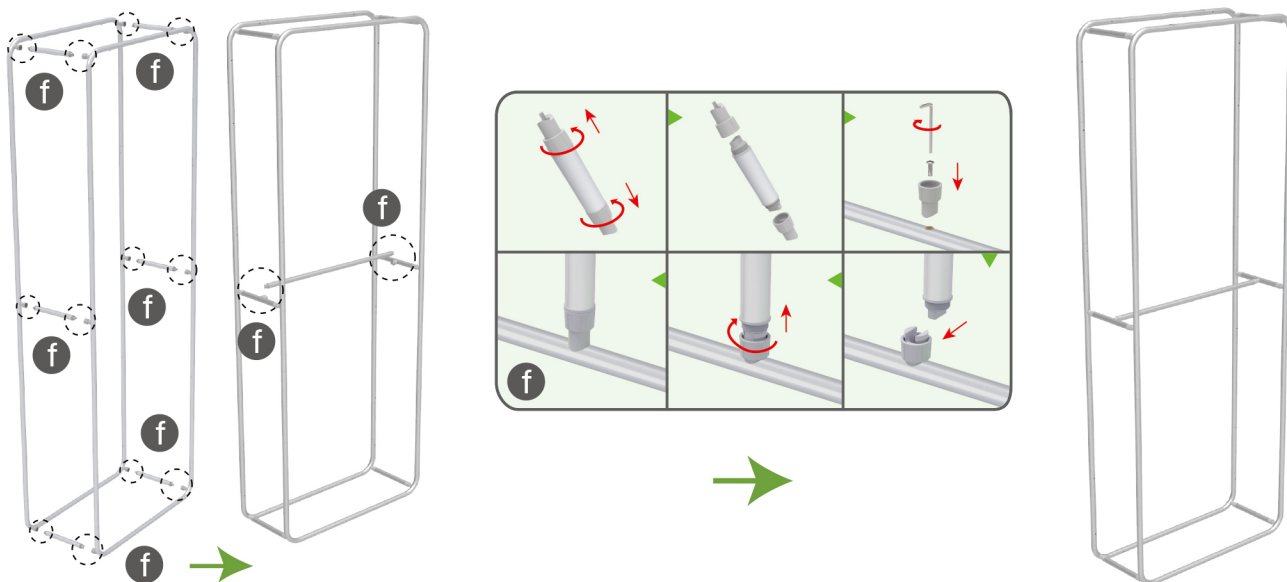

STEP 04

Slide fabric banner on frame from top and zip up at bottom.

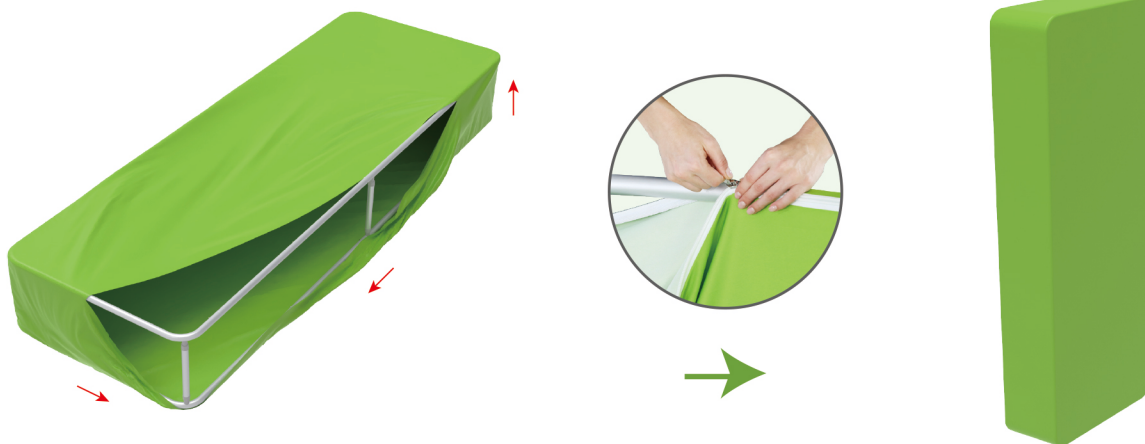

(1) Hardware

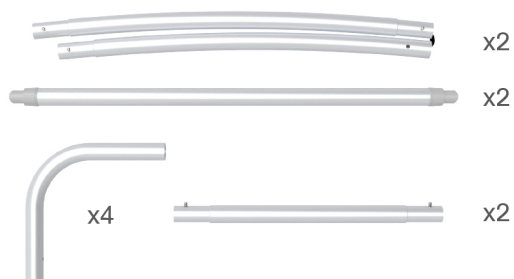

(2) Printed Graphic Fabric Banner (Optional)

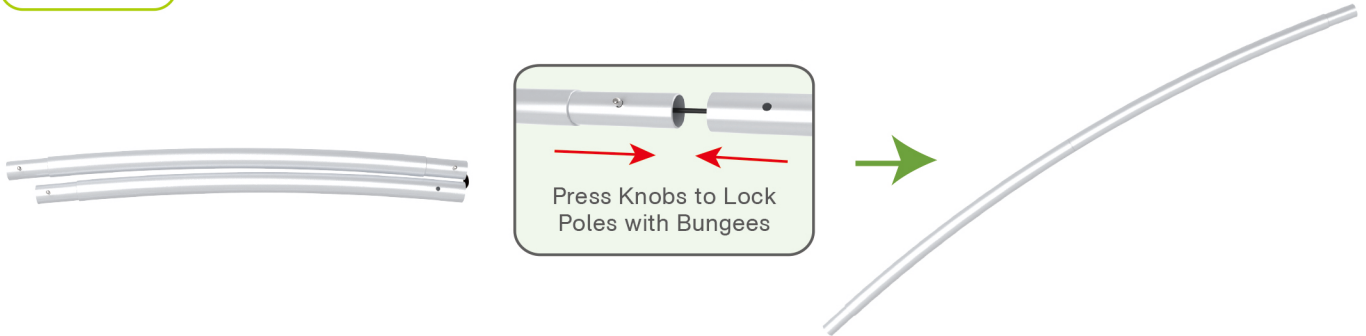
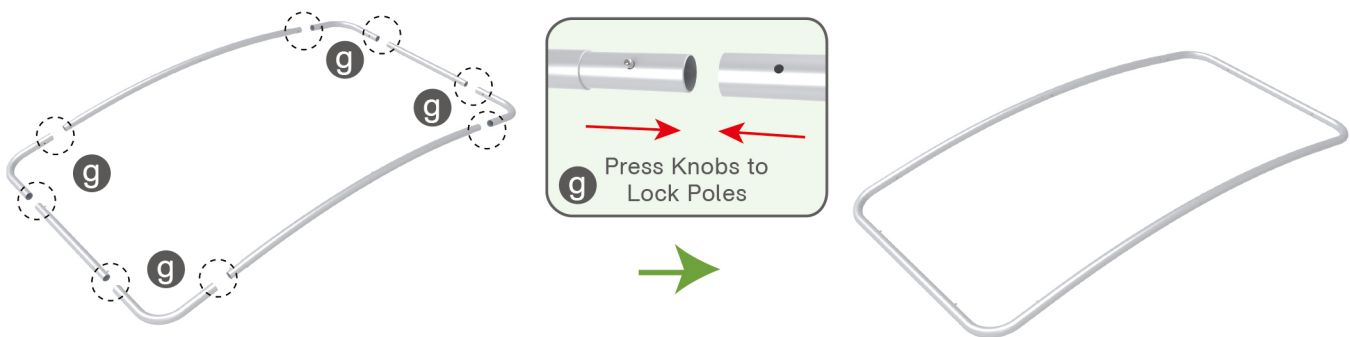
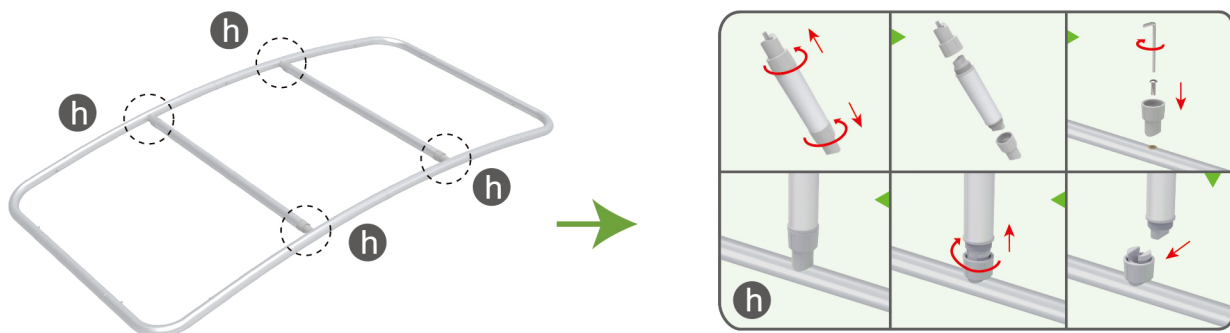
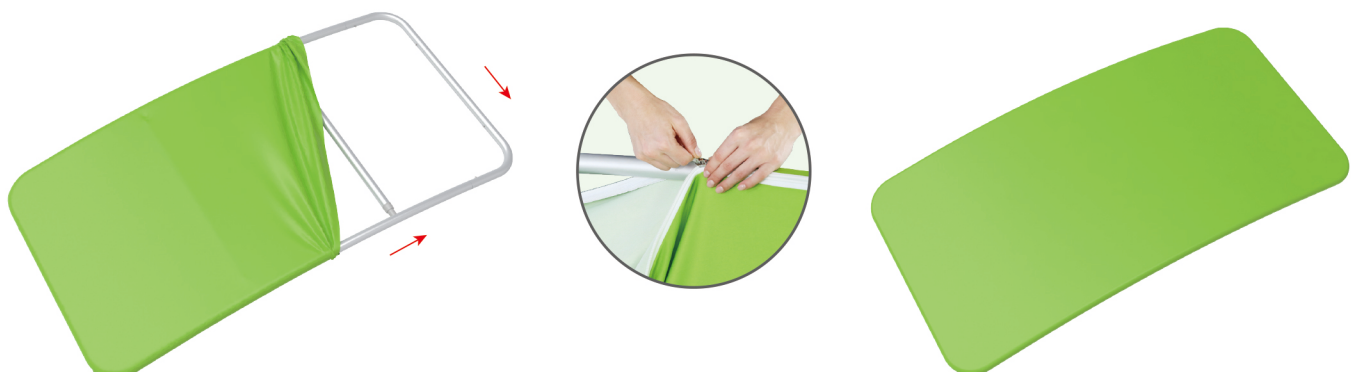

STEPS

STEP 01 Connect to make long poles according to labelings.**STEP 02** Connect long poles with corner poles according to labelings.**STEP 03** Connect support poles onto frame.**STEP 04** Slide fabric banner on frame from left and zip up at right.

STEPS

Booth Set Assembly



STEP 01

Connect support poles onto column frame and canopy.

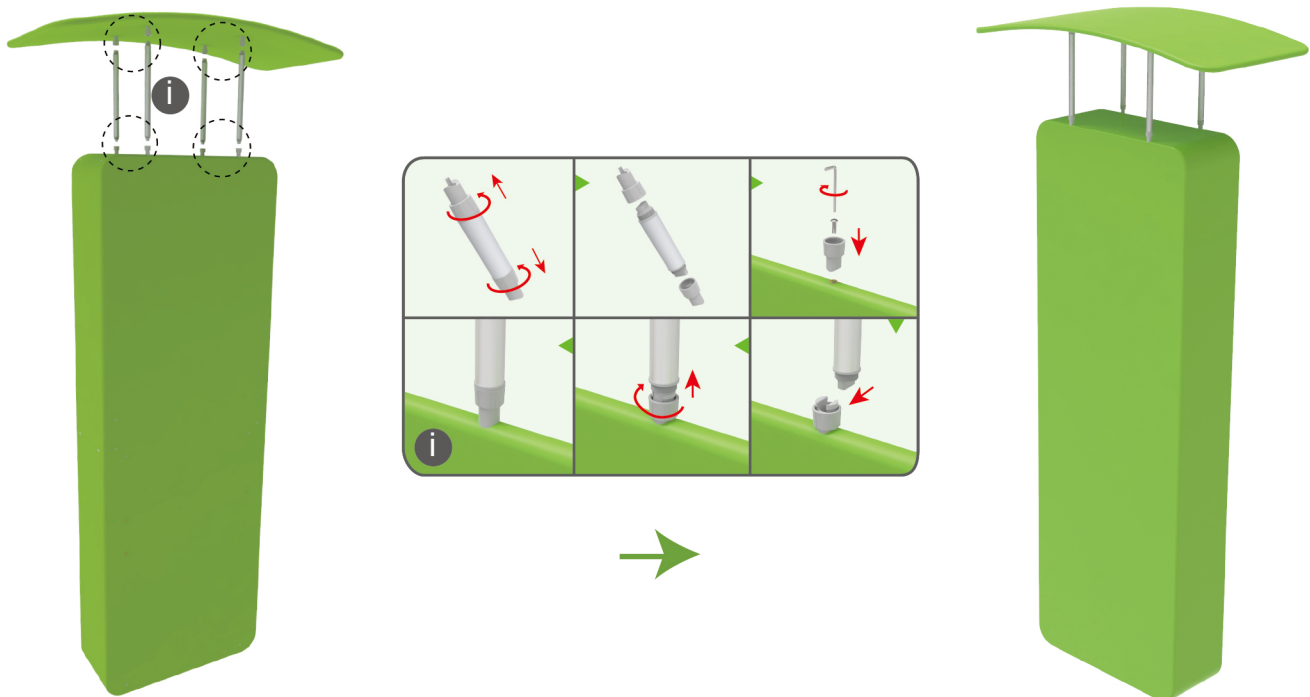

STEPS

STEP 02

Interconnect display stands with C-shaped clips.

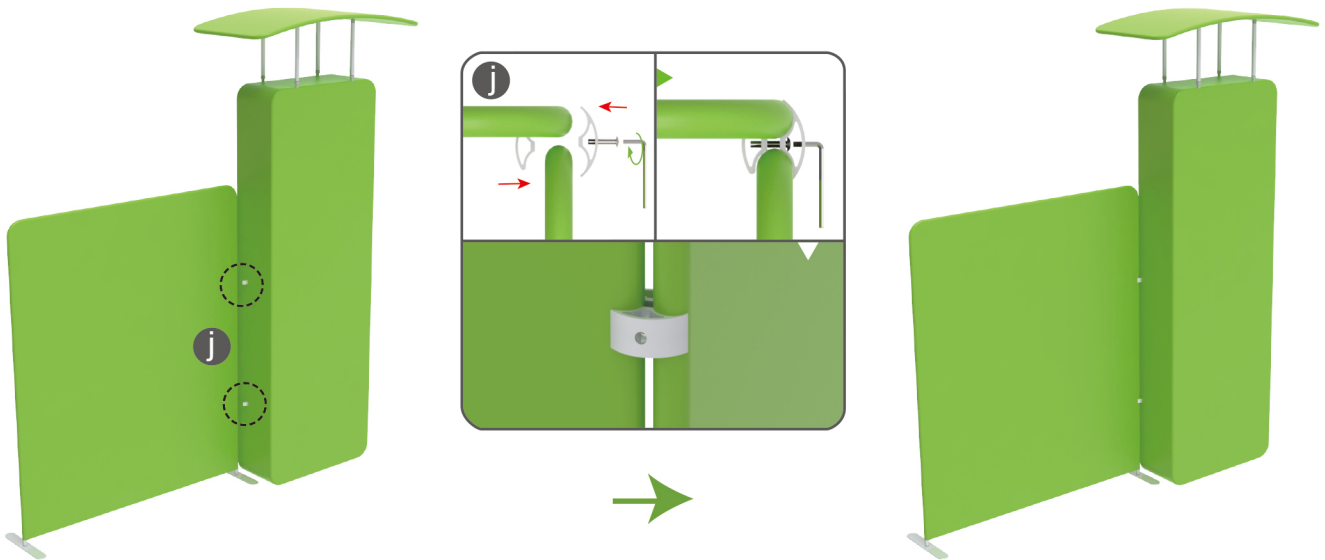

STEP 03

Connect display stands with arm clips and Insert display stands onto feet by pressing their knobs.

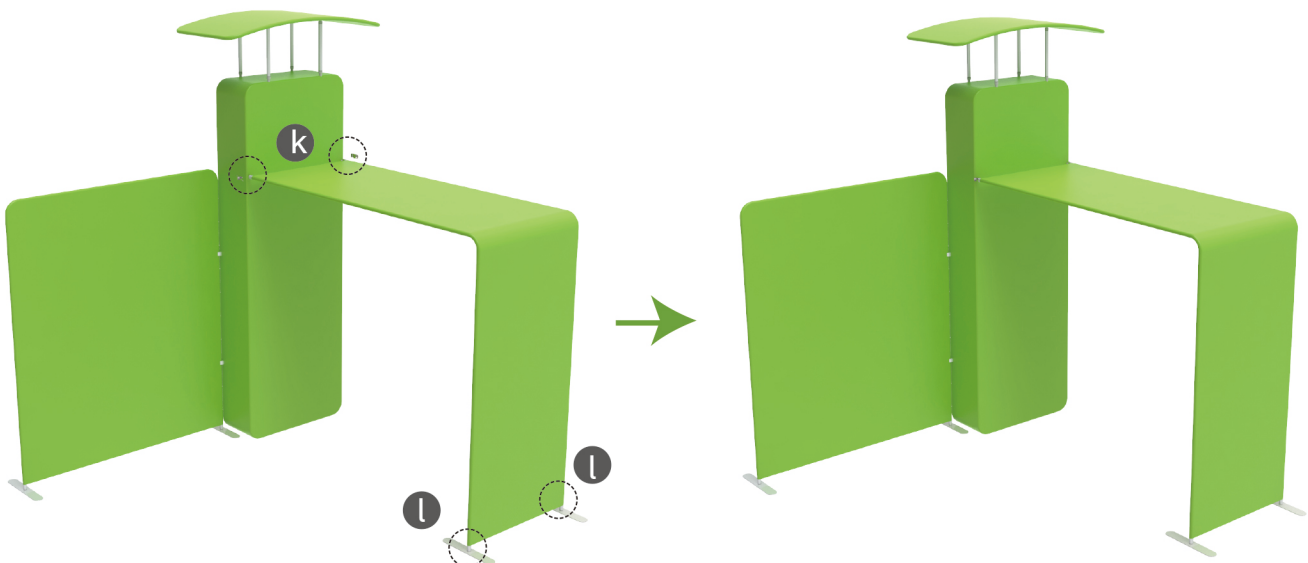
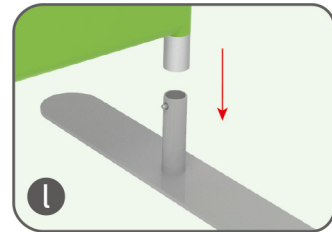
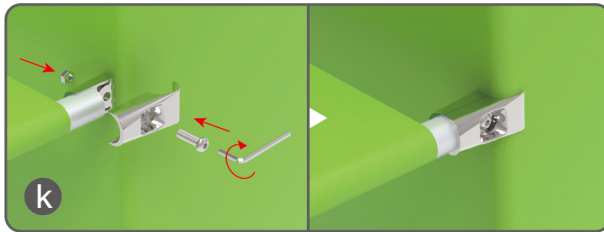

STEPS

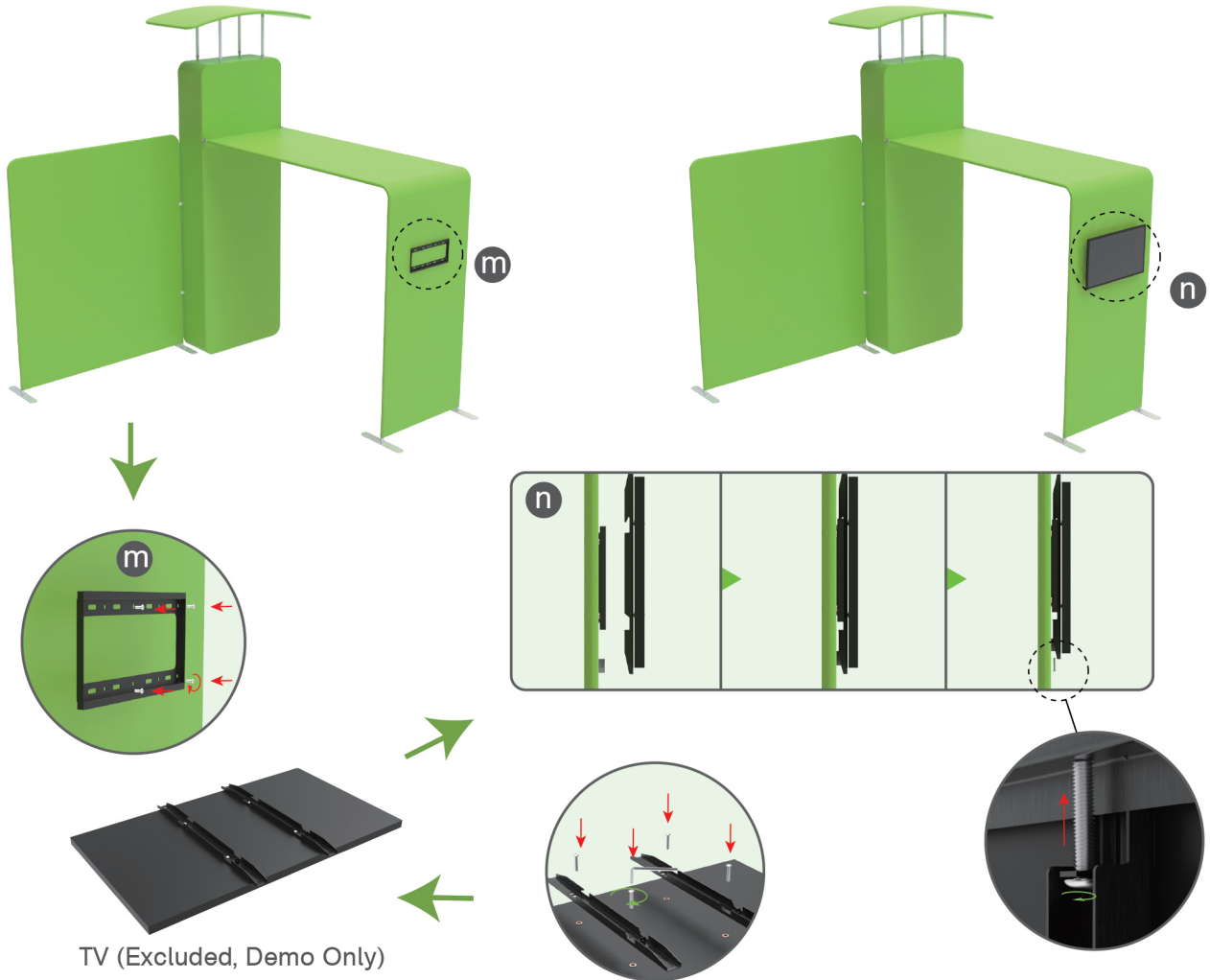
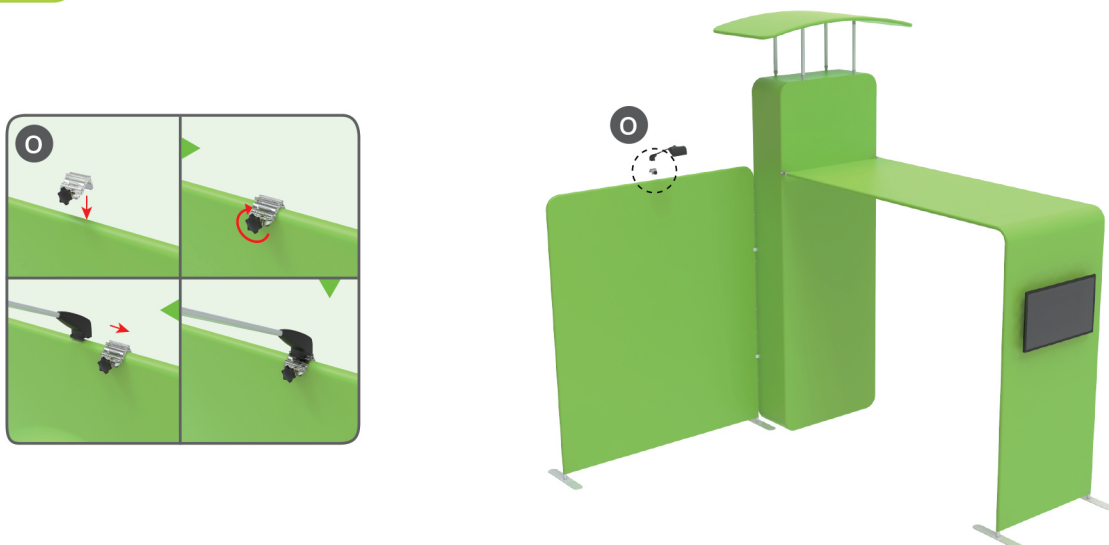
STEP 04 Screw TV mount with hex wrench.**STEP 05** Screw light clips at top of display stands, slide lights onto them and adjust their direction.

STEPS**10X10FT-BOOTH-07**

STEPS

(1) Durable Plastic Hard Case, Aluminum Support Poles



(2) Printed Graphic Fabric Banner



STEP 01

Put hard case's top into fabric banner.

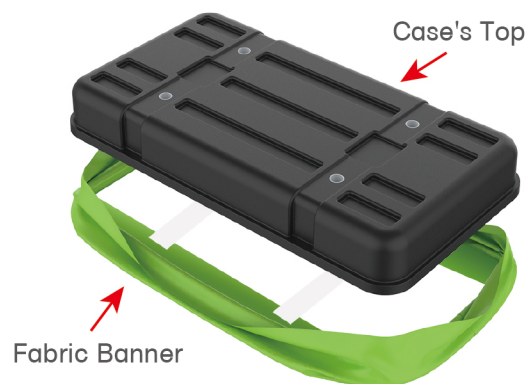

STEP 02

Insert support poles into hard case's top & bottom.

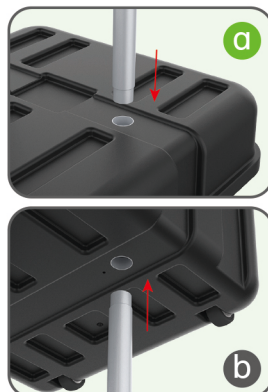
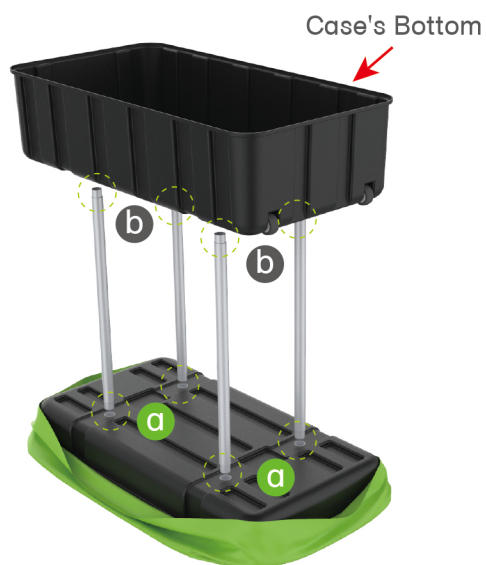

STEPS

STEP 04

Wrap fabric banner from bottom to top & twist it to be smooth, lay hard case's intermediate panel on podium's top.

