

INSTRUCTION

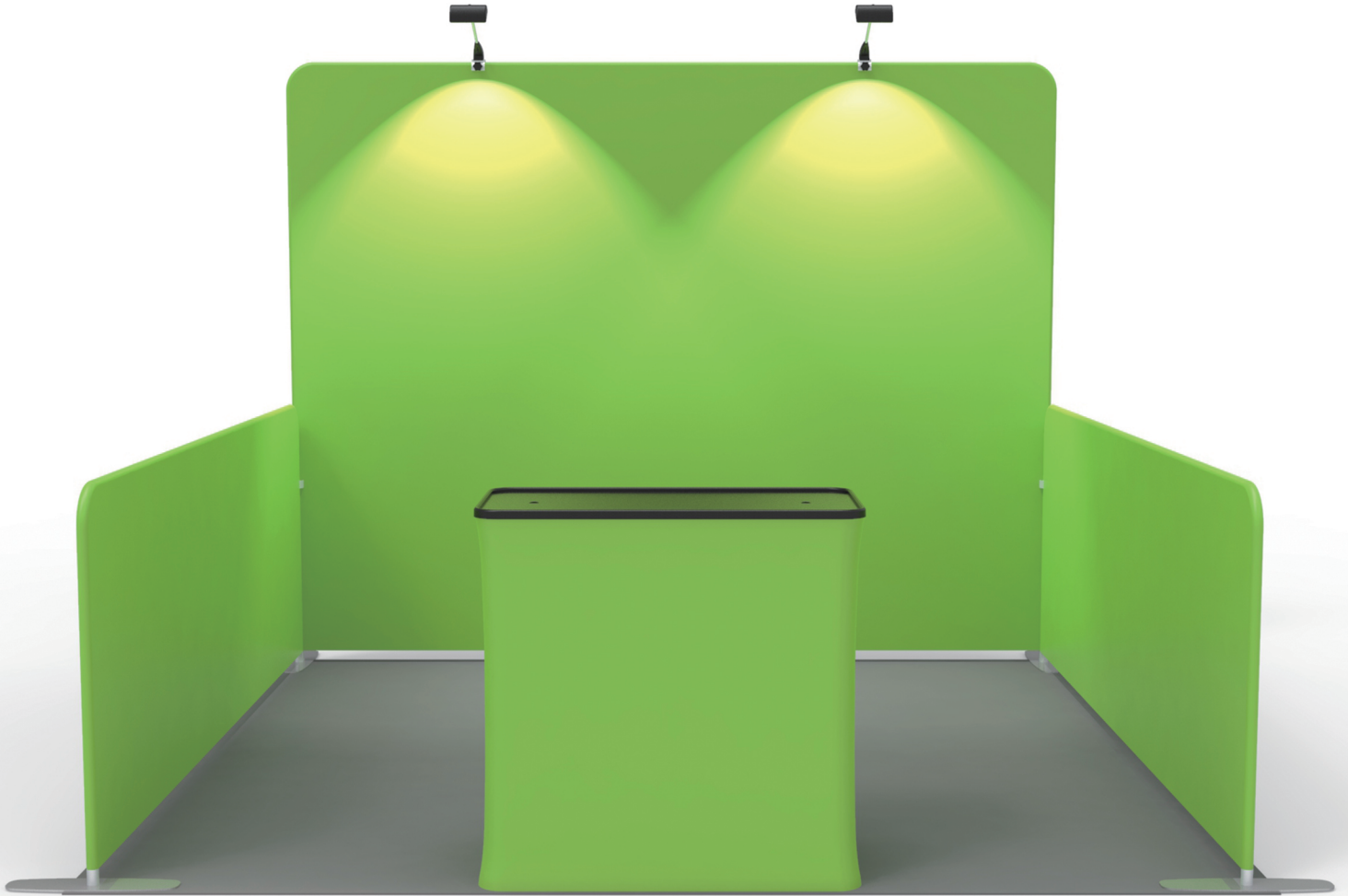
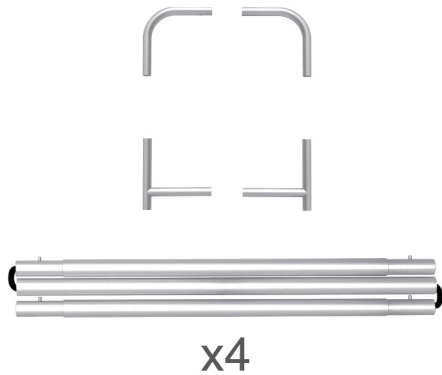

10X10FT-BOOTH-01

STEPS**(1) Hardware****(2) Printed Graphic Fabric Banner (Optional)****STEP 01**

Connect to make long poles according to labelings.

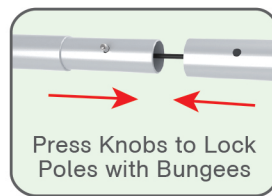
**STEP 02**

Connect long poles with corner poles according to labelings.

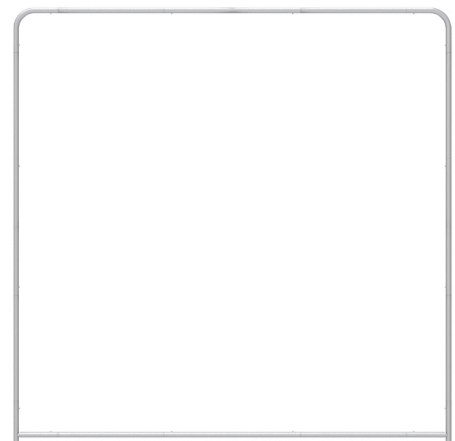
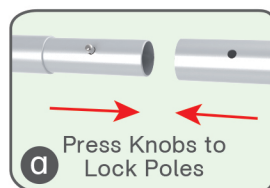
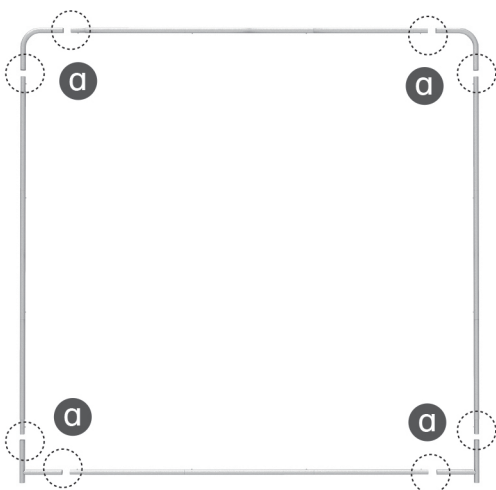

STEPS

STEP 03

Slide fabric banner on frame from top and zip up at bottom.

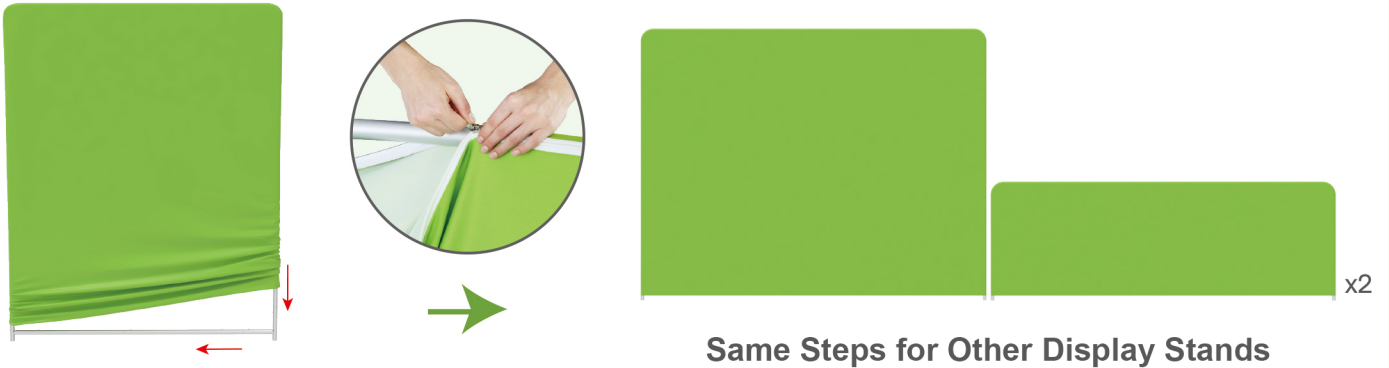

Booth Set Assembly

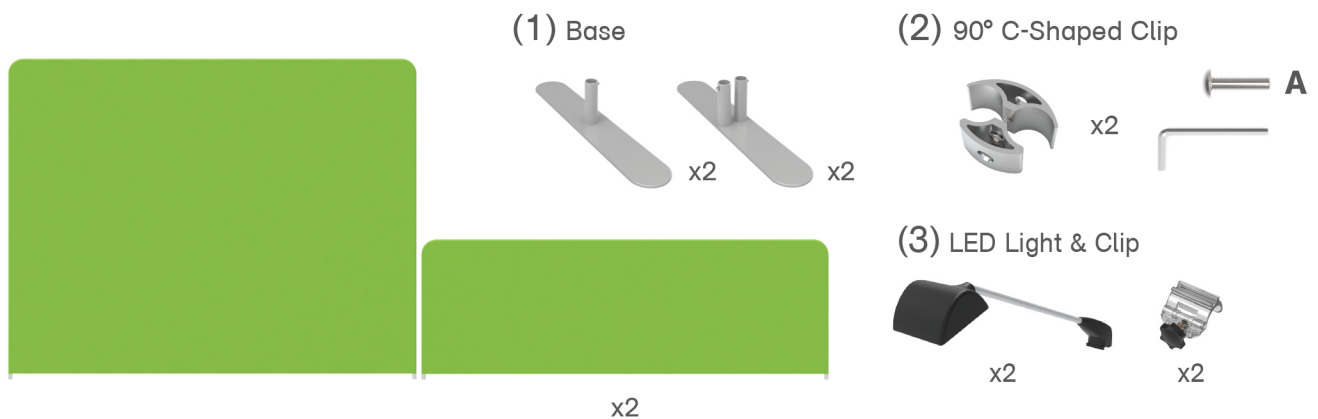

STEP 01

Insert display stands onto feet by pressing their knobs.

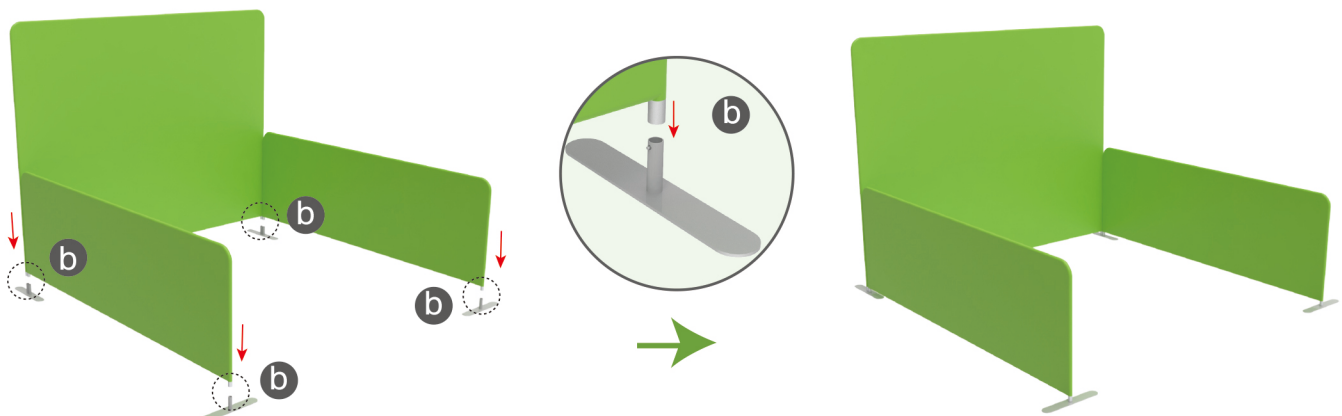

STEPS**STEP 02**

Interconnect display stands with C-shaped clips.

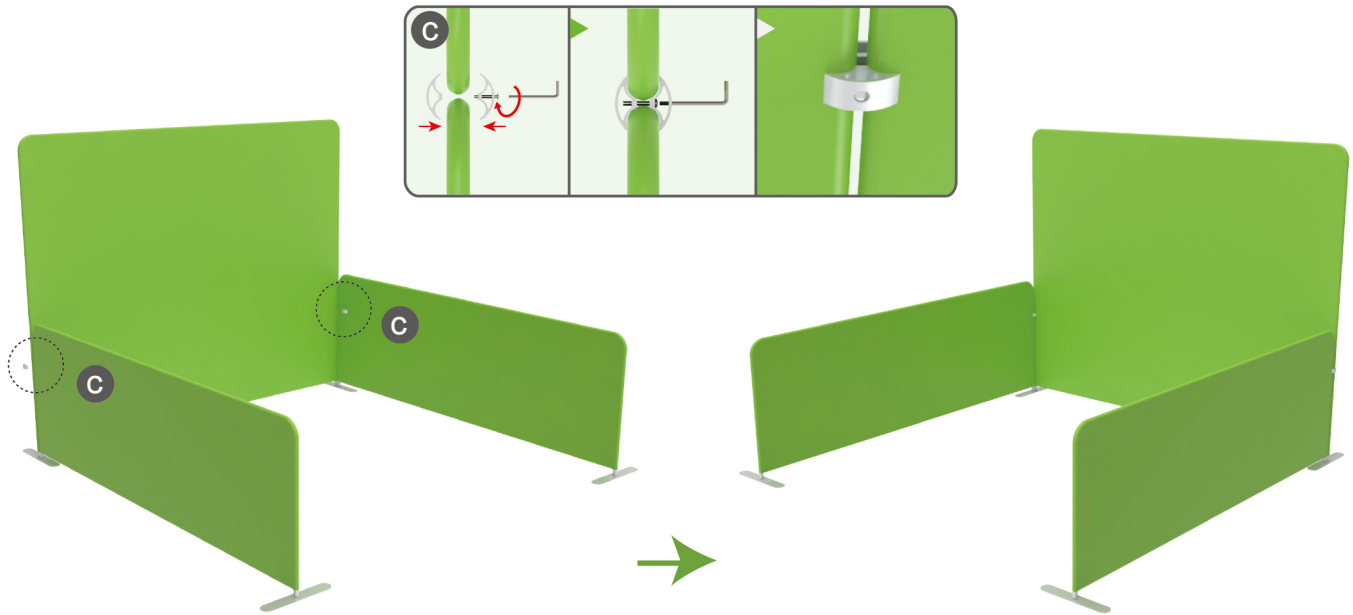
**STEP 03**

Screw light clips at top of display stands, slide lights onto them and adjust their direction.

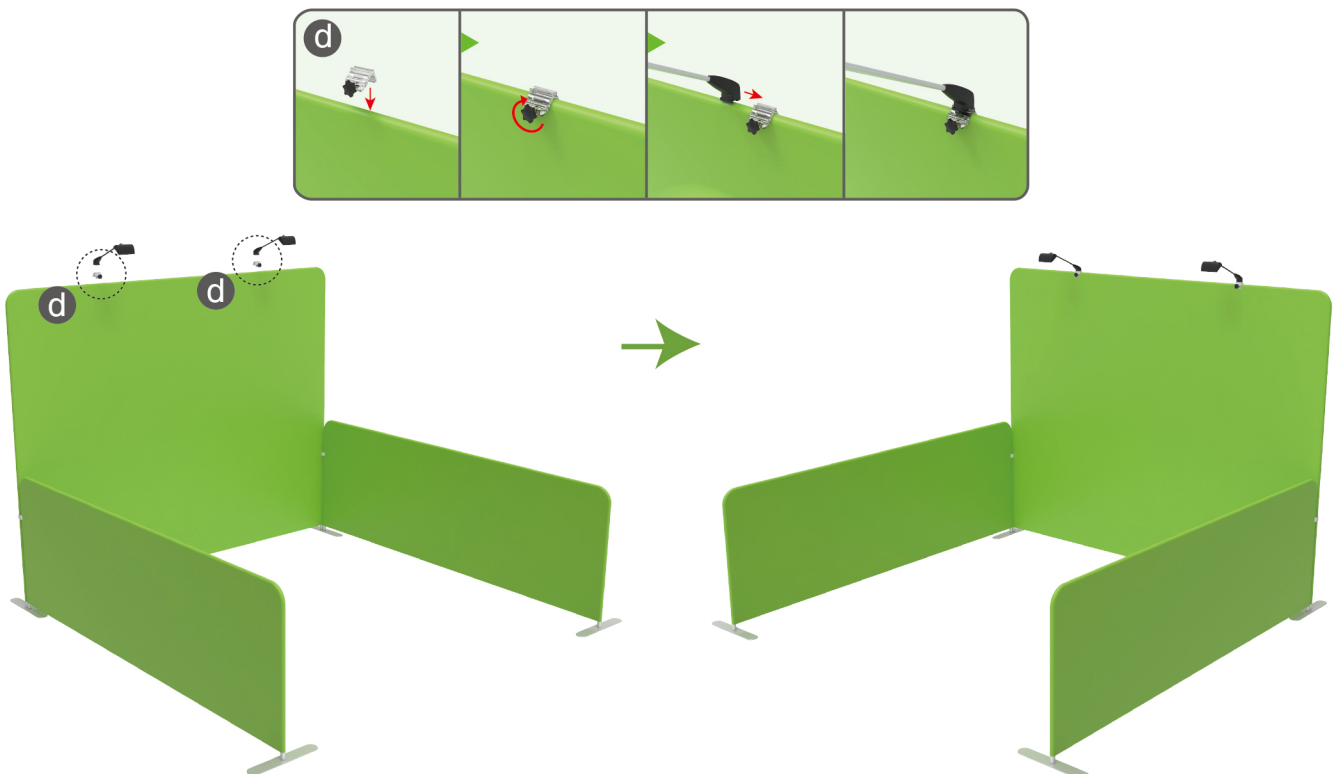

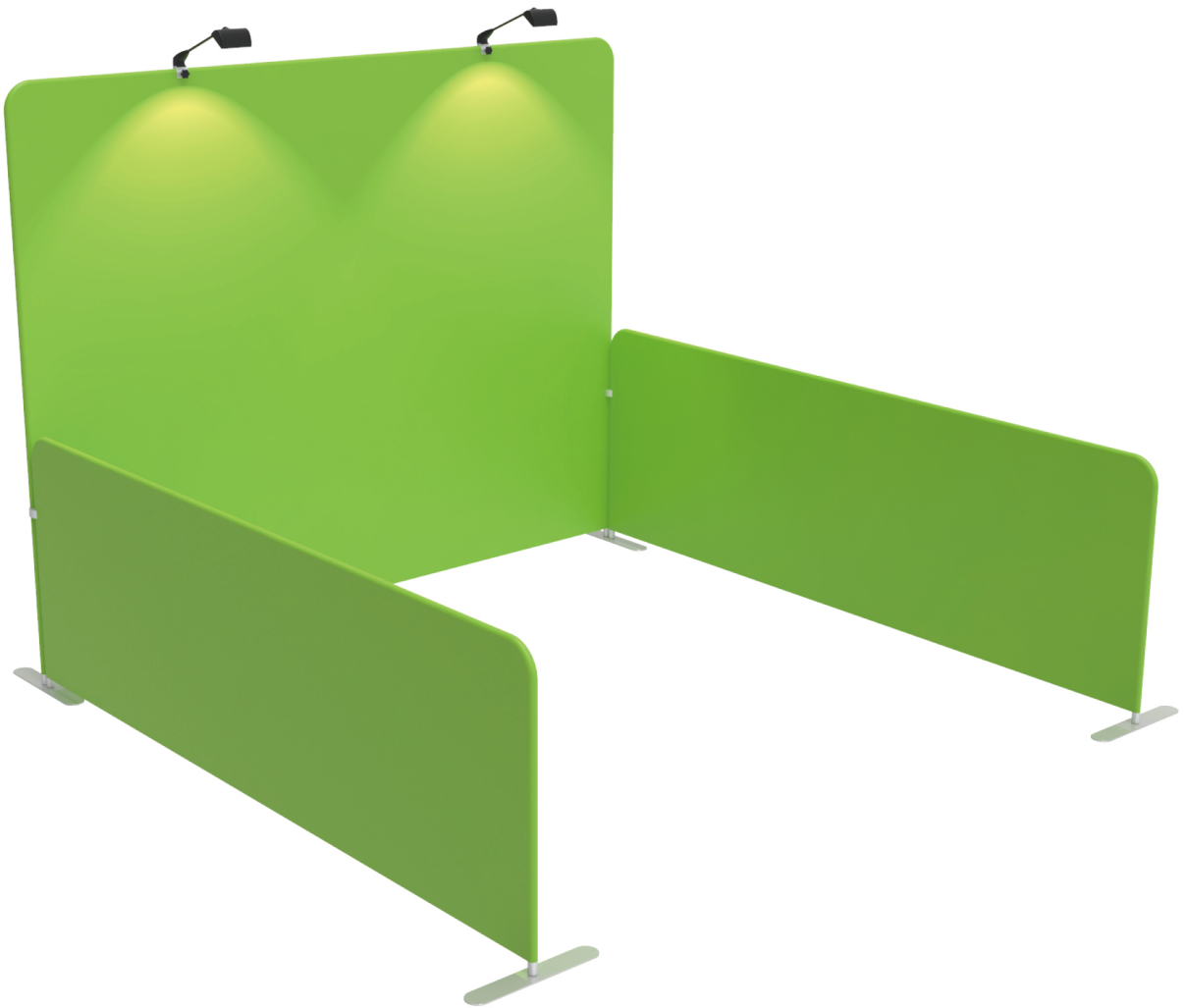
STEPS**10X10FT-BOOTH-01**

STEPS

(1) Durable Plastic Hard Case, Aluminum Support Poles



(2) Printed Graphic Fabric Banner



STEP 01

Put hard case's top into fabric banner.

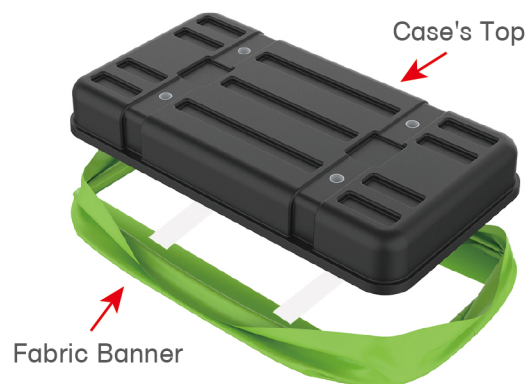

STEP 02

Insert support poles into hard case's top & bottom.

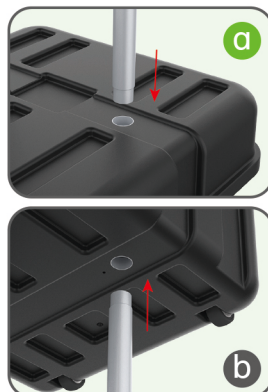
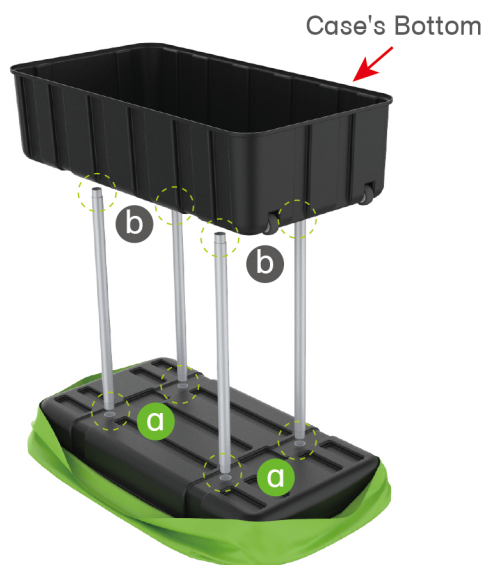

STEPS

STEP 04

Wrap fabric banner from bottom to top & twist it to be smooth, lay hard case's intermediate panel on podium's top.

