

★ One Tool (Hex Wrench) **STEPS**

(1) Hardware

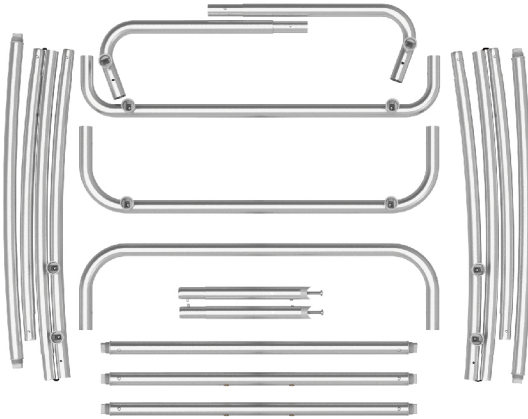

(2) Fabric banner



(3) TV mount & Screw bag

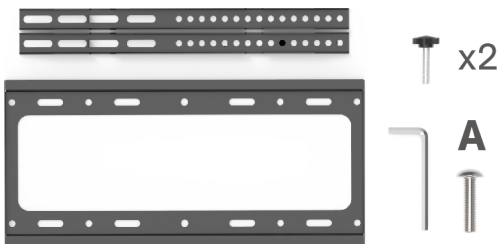

(4) Counter top

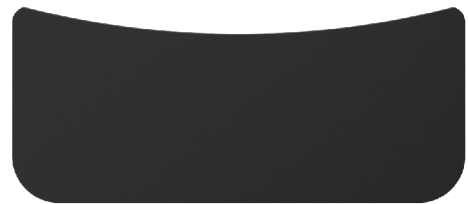
**STEP 01**

To connect the poles according to the labellings

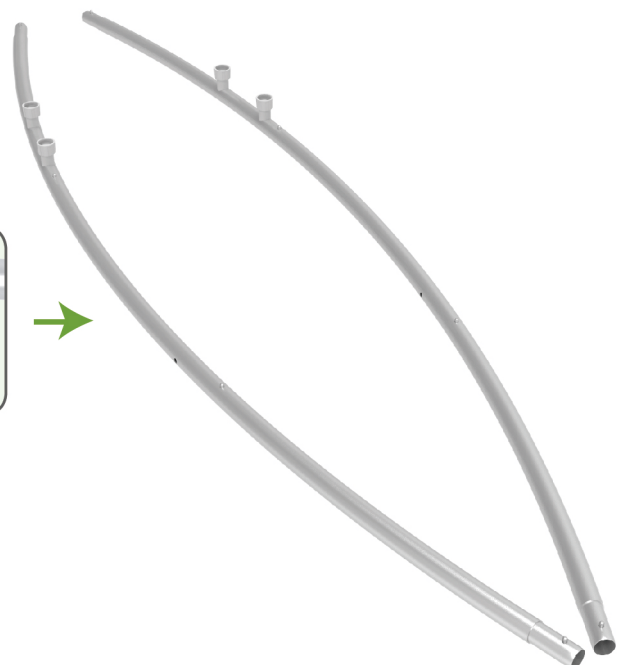
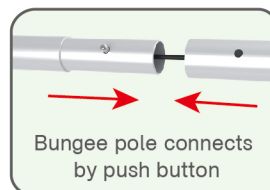

STEPS

STEP 02

To connect the poles according to the labellings

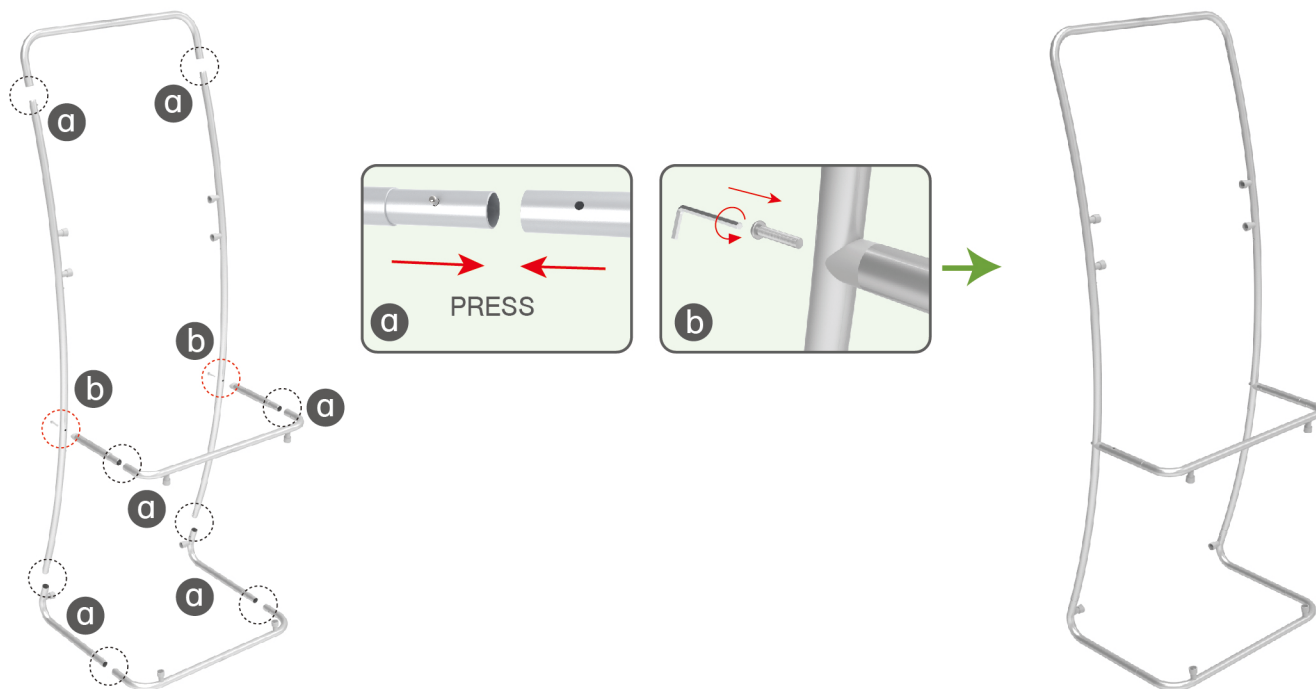

STEP 03

To install the cross bar in position

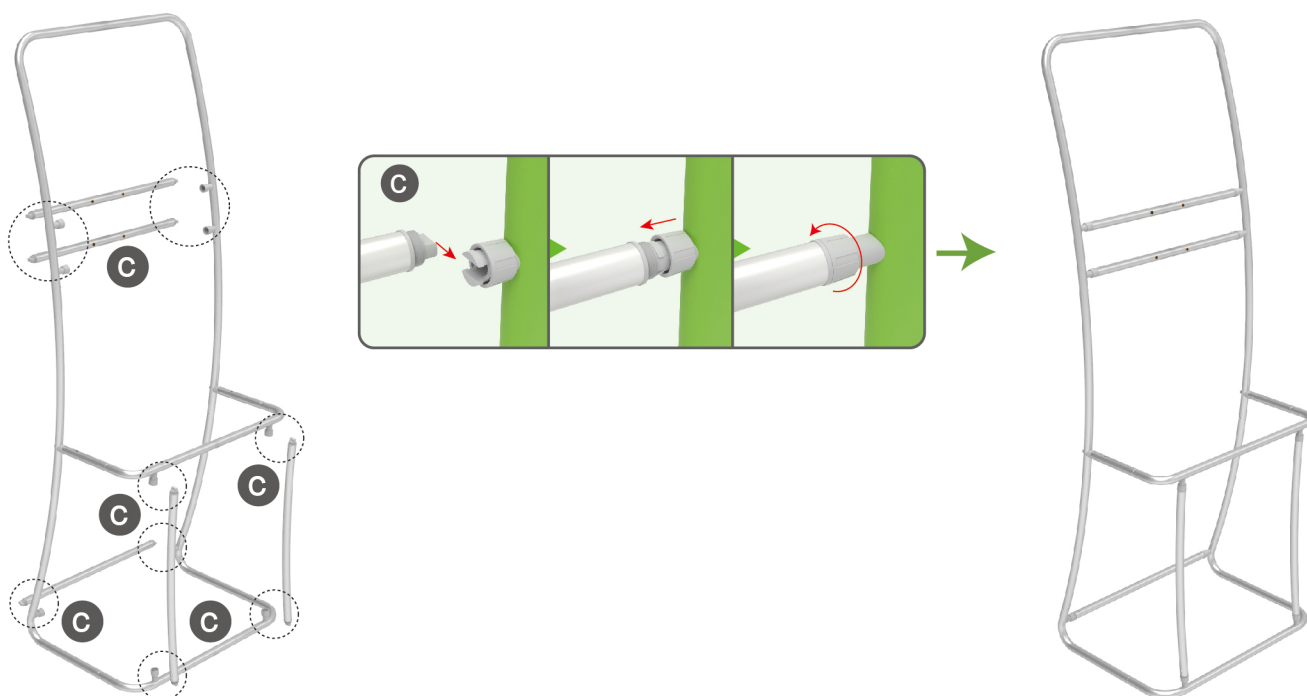

STEPS

STEP 04

To wrap the fabric banner from top to bottom and zip up



Zip up fabric graphic



STEP 05

To put the counter top in position and unzip the zippers at 2 sides and use screw for fastening from bottom

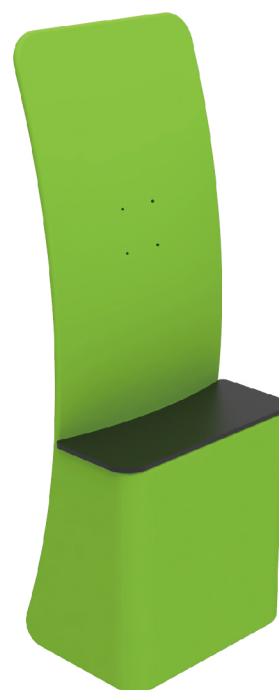
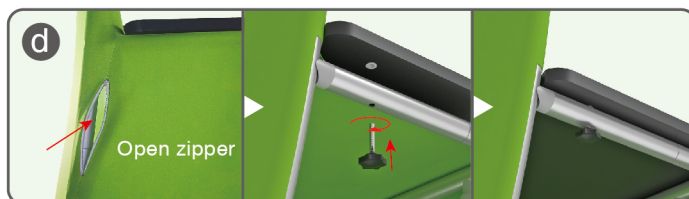
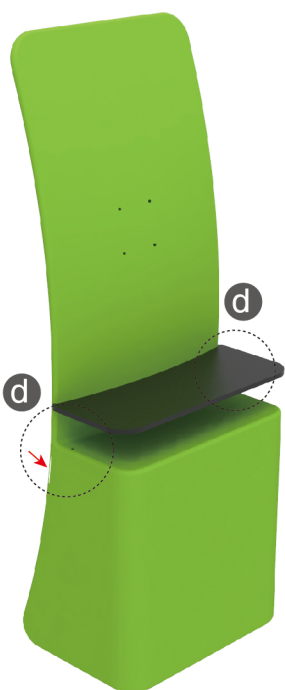

STEPS

STEP 06

To install the TV mount

