

INSTRUCTION

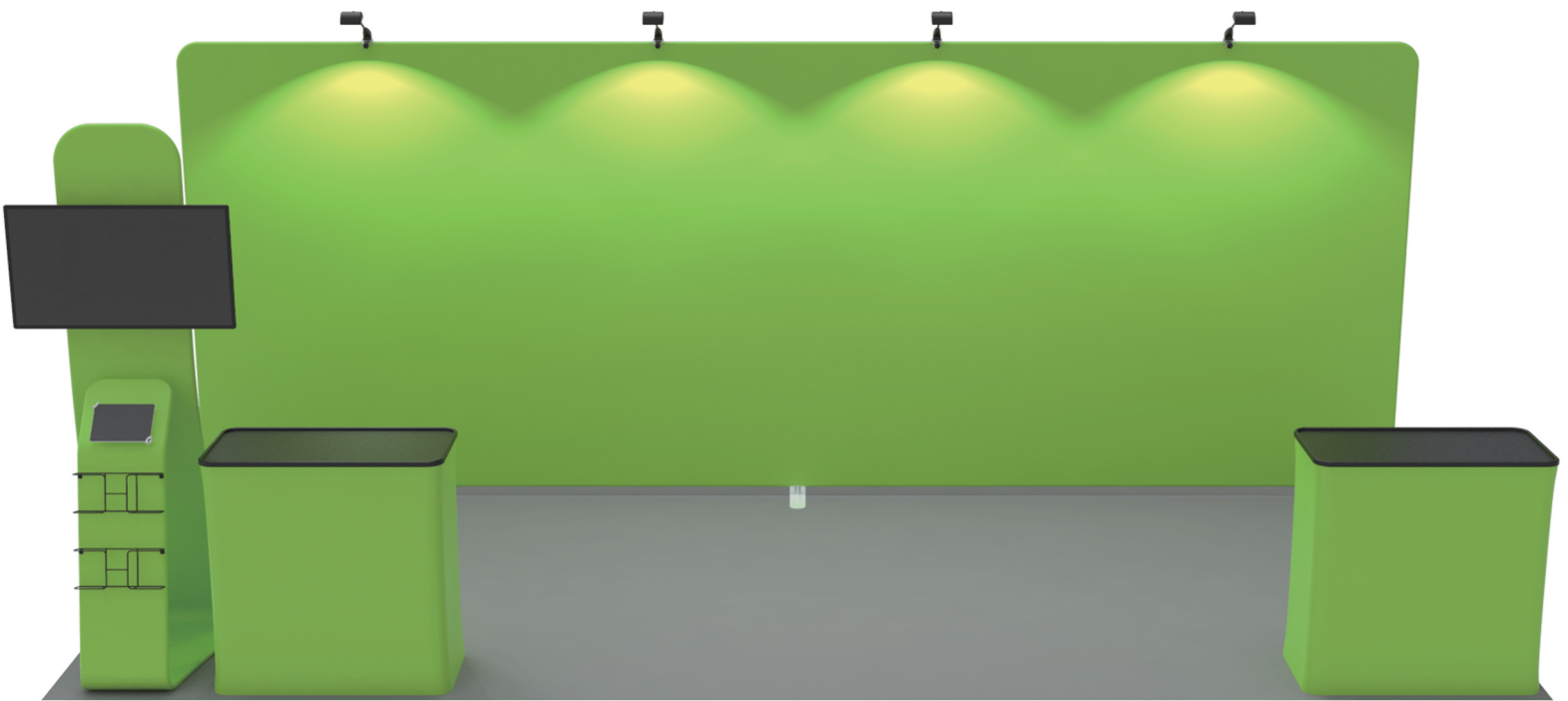

TF-SB-10X20-61

STEPS

(1) Hardware

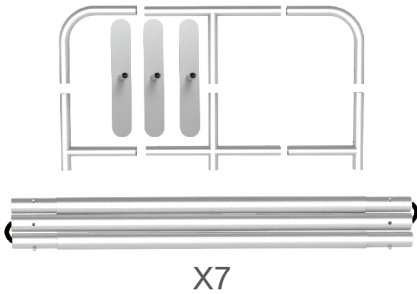

(2) Fabric banner

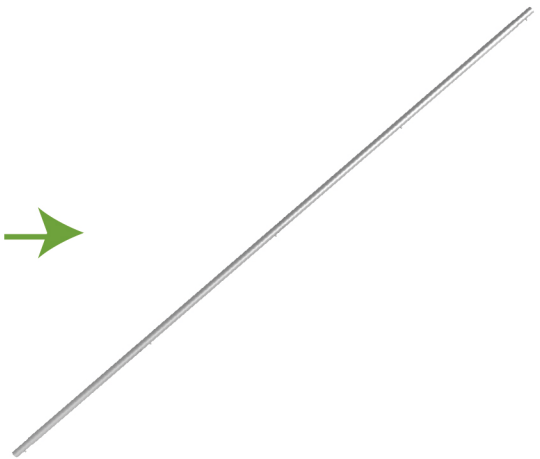
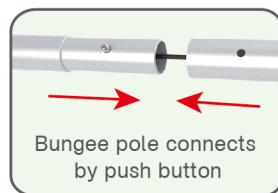
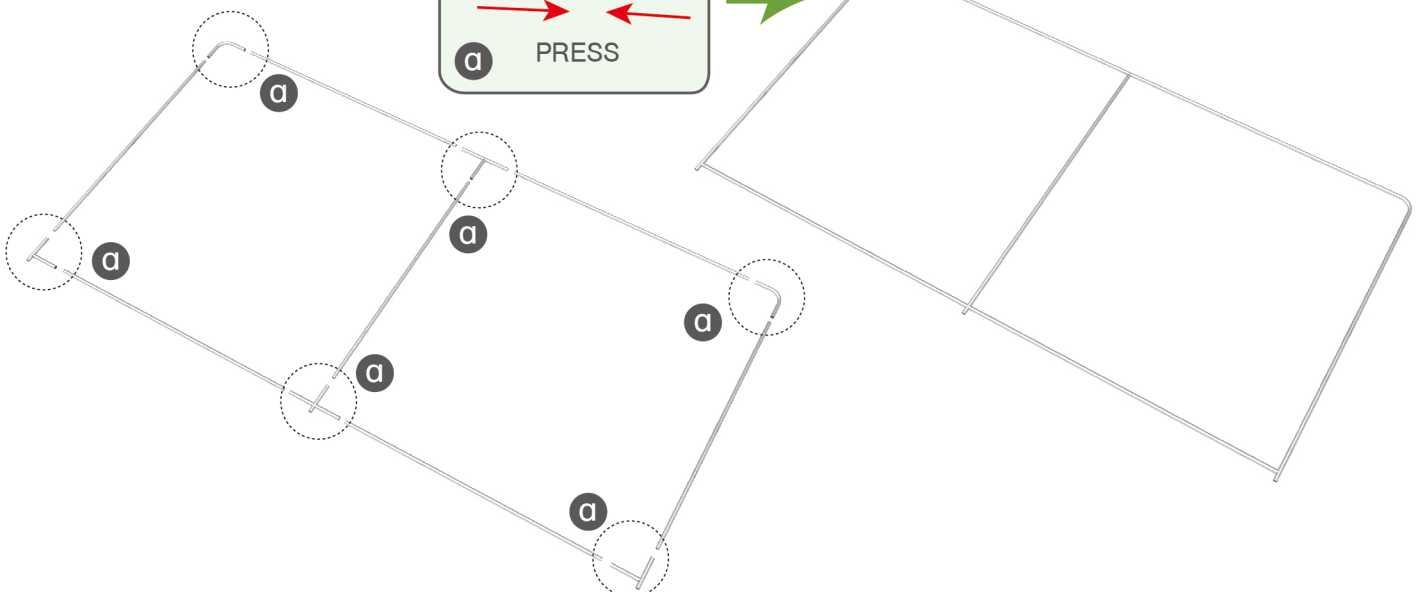
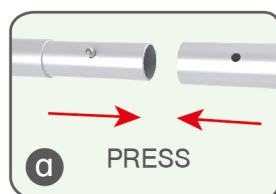

(3) Light Clips

**STEP 01** To connect the poles according to the labellings**STEP 02** To connect the long poles by corner pieces according to labellings and assemble middle upright pole in position.

STEPS

STEP 03 To slide the fabric banner on the frame from top and zip up at bottom

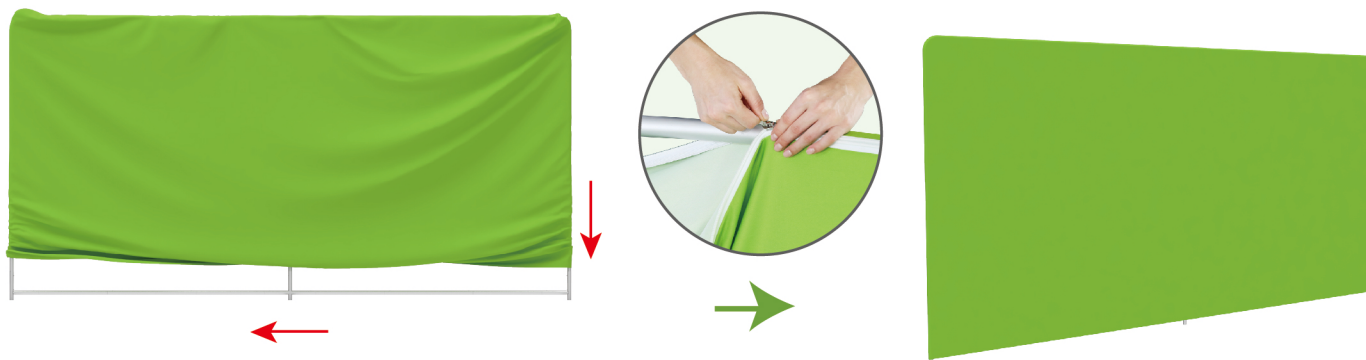

STEP 04 To assemble the stand feet in position

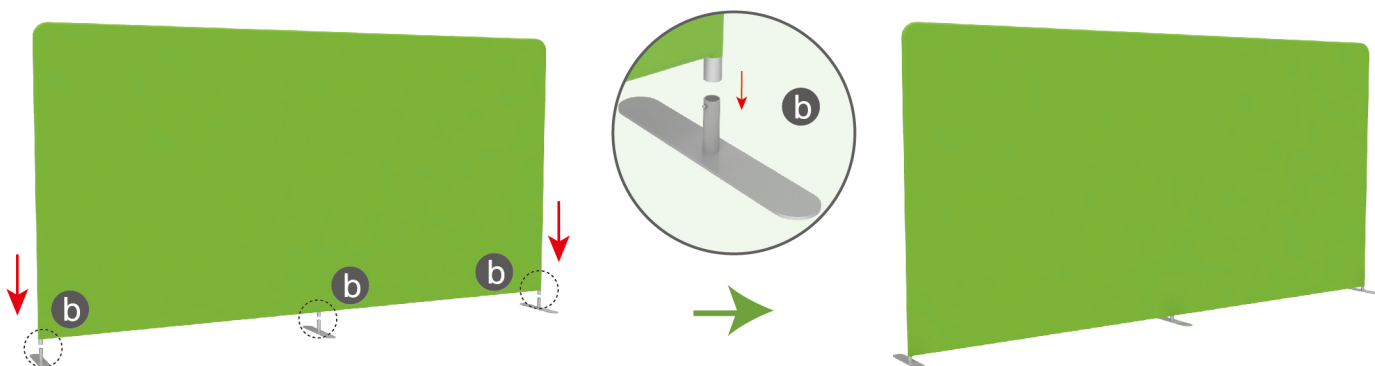

STEP 05 To install the light clip at top of the banner stand and slide the light in position then adjust the light angle. ***LED Lights are optional***

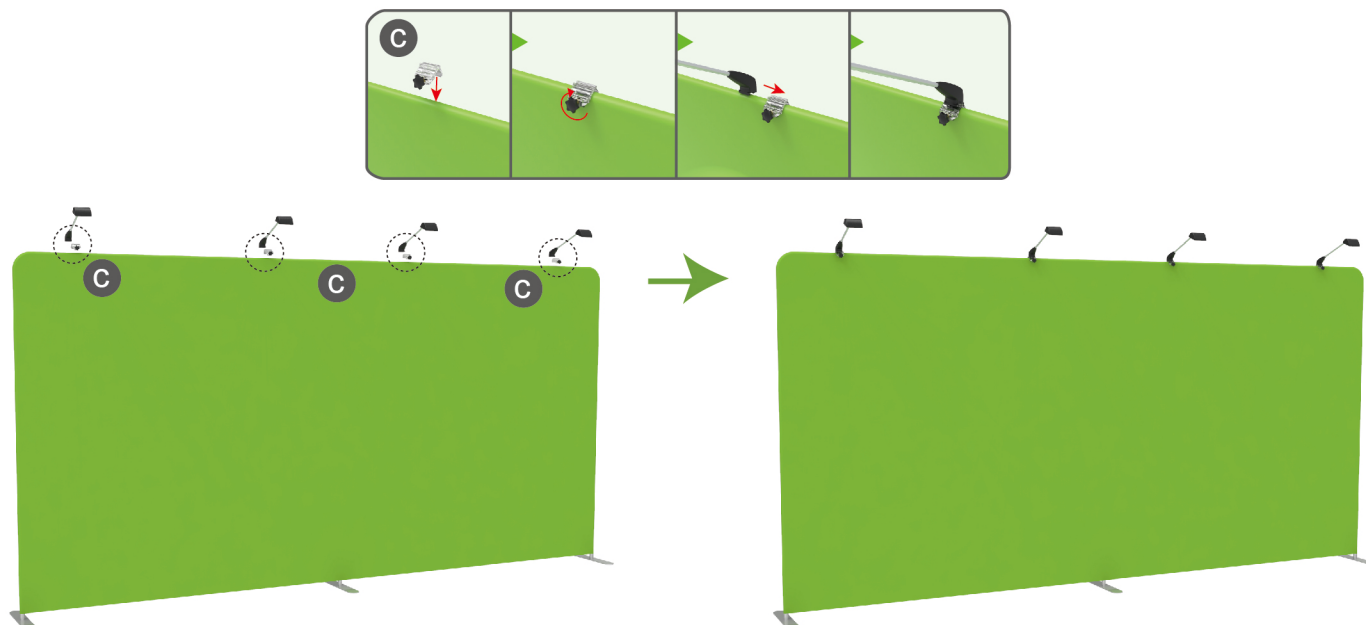

STEPS

(1) Hardware



(2) Printed Graphic Fabric Banner (Optional)



(3) TV Mount & Screw

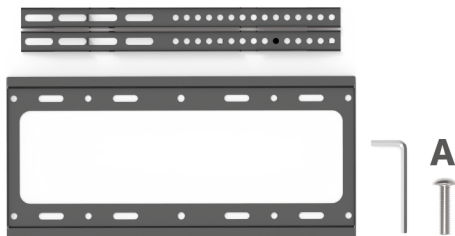

(4) Brochure Rack

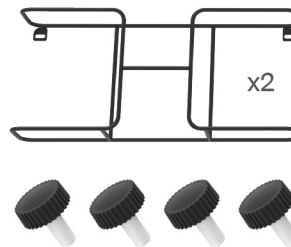

(5) iPad/Tablet Adjustable Holder

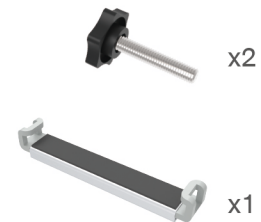

STEP 01

Connect to make long poles according to labelings.

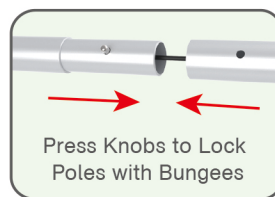

STEPS

STEP 02 Connect long poles with corner poles according to labelings, install cross bars in position.

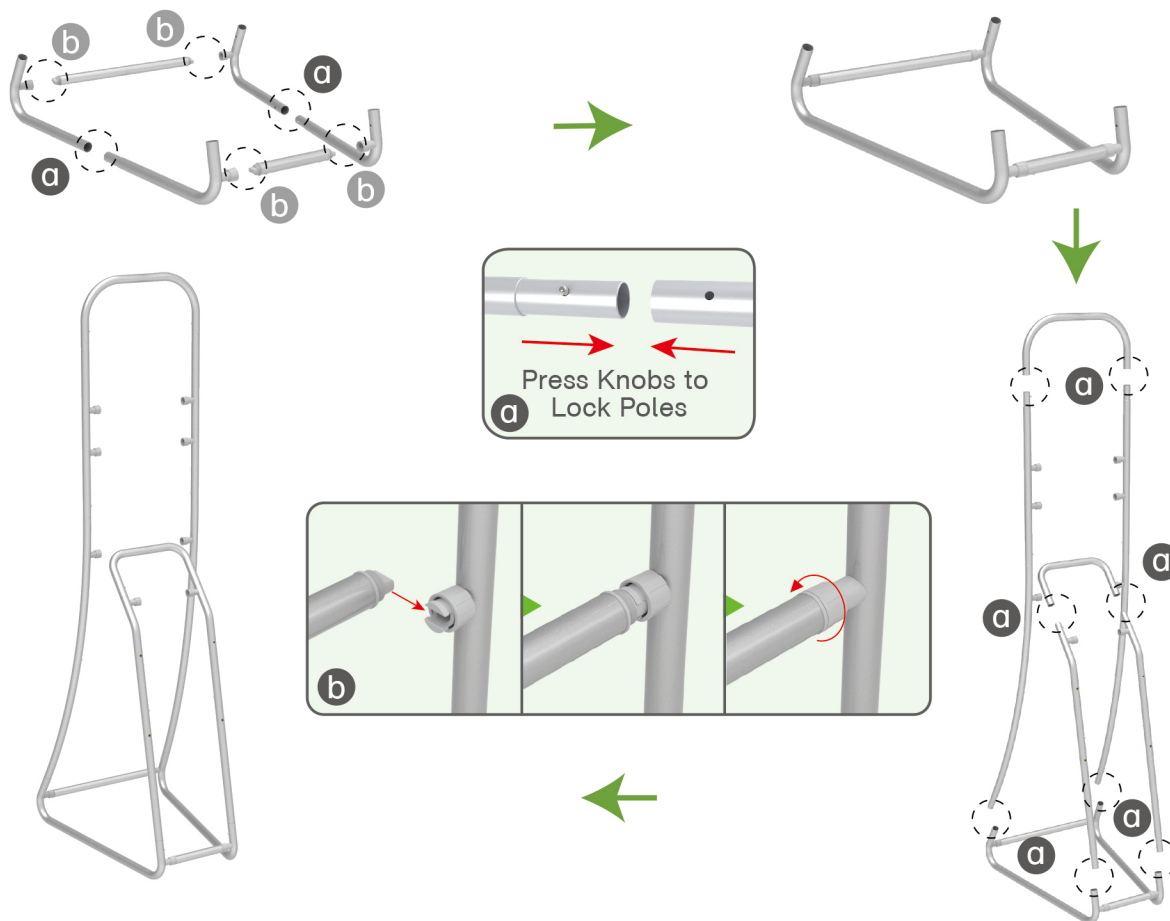

STEP 03 Install cross bars in position.

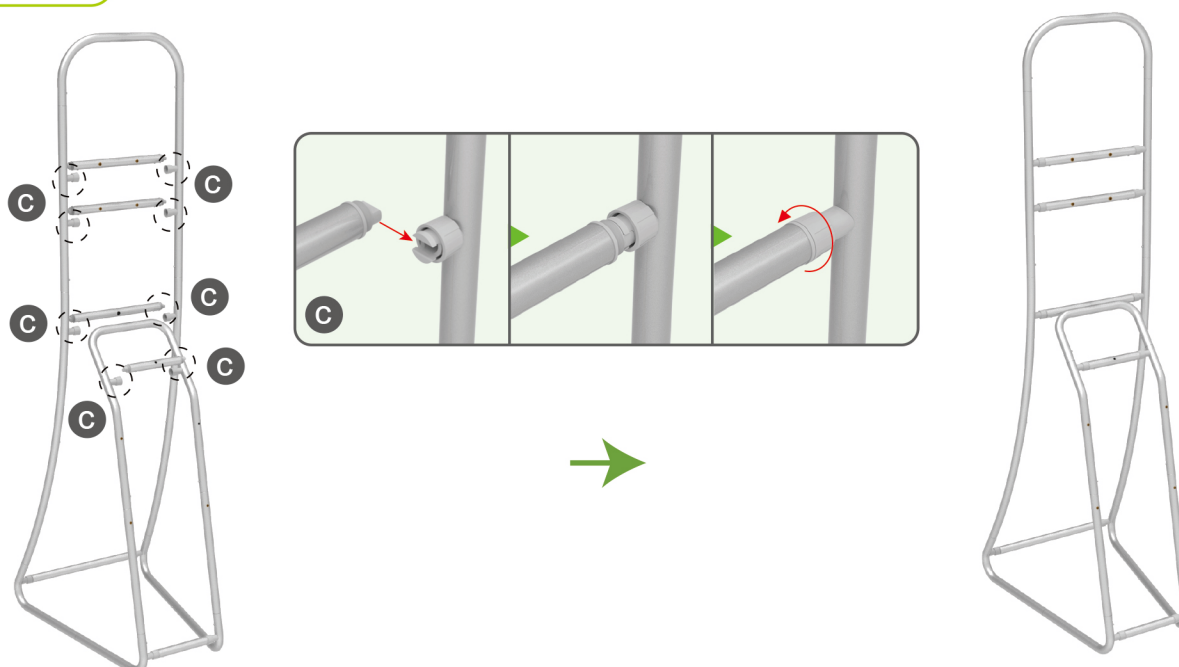

STEPS

STEP 04

Wrap fabric banner from front top and zip up at back top, screw to interconnect back middle cross bar with front top.

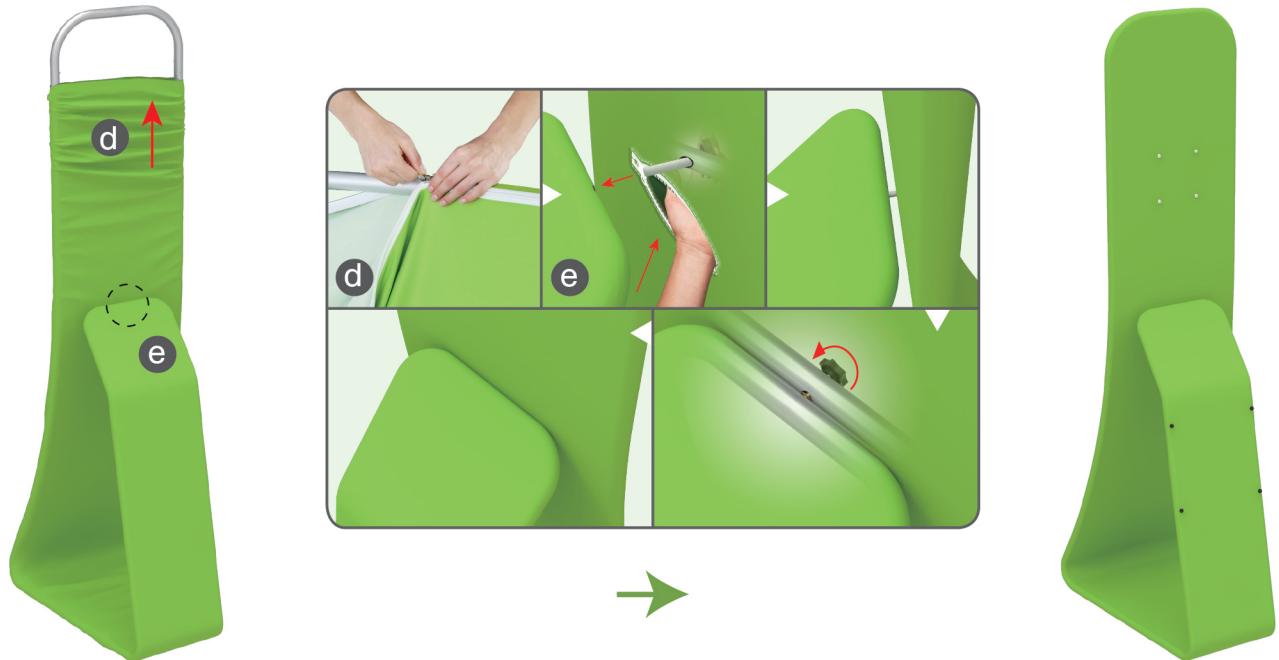

STEP 05

Screw TV mount onto display stand.

TV(Excluded,
Demo Only)

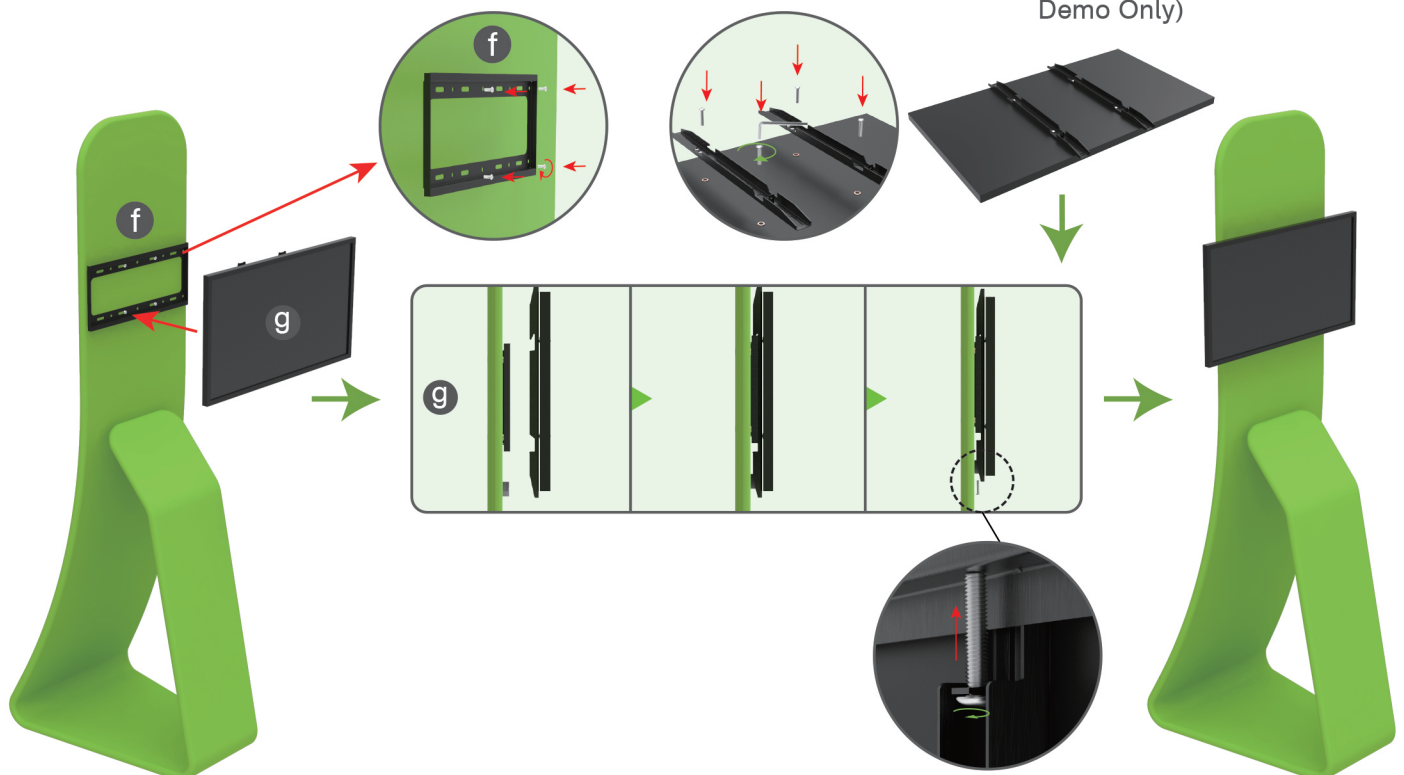

STEPS

STEP 06

Adjust holder to diagonally fit iPad/tablet in position, fasten with allen key & screw whole kit onto display stand's front top.

Adjustable holder is compatible with 8" - 13" iPad/tablet

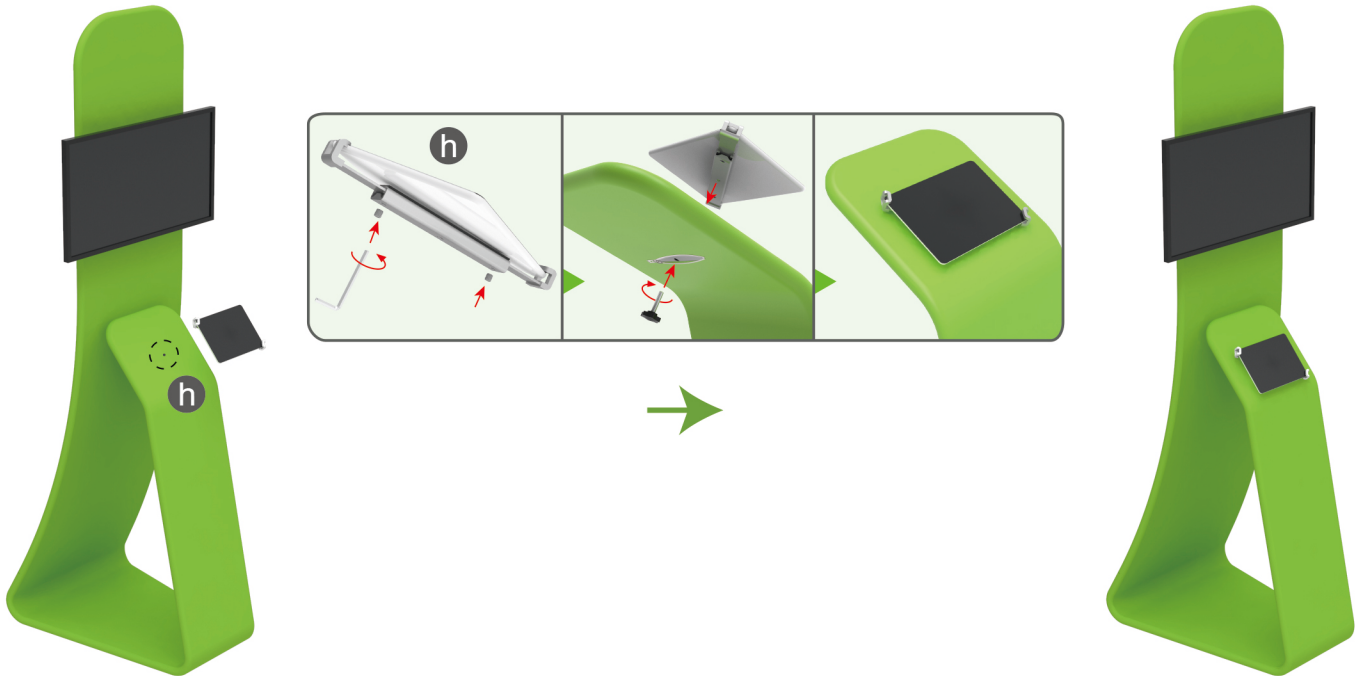

STEP 07

Screw 2 brochure racks in position.

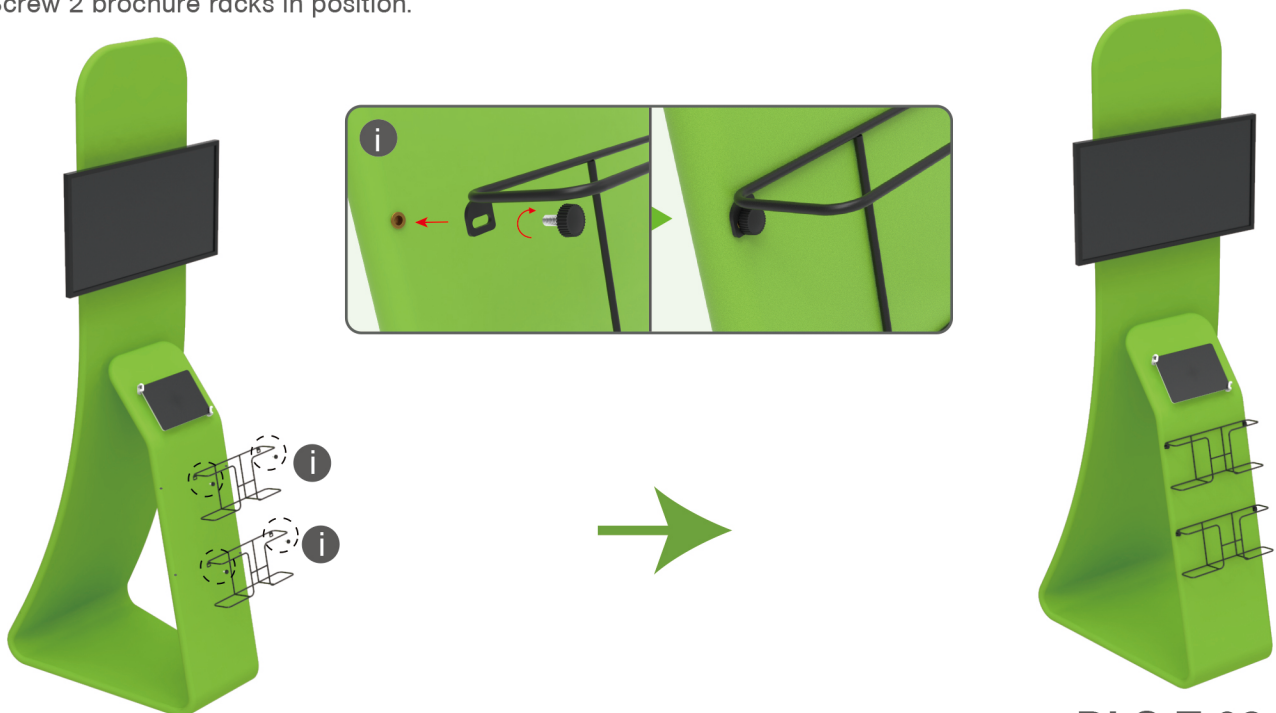

DLS-T-02

STEPS

(1) Durable Plastic Hard Case, Aluminum Support Poles



(2) Printed Graphic Fabric Banner



STEP 01

Put hard case's top into fabric banner.

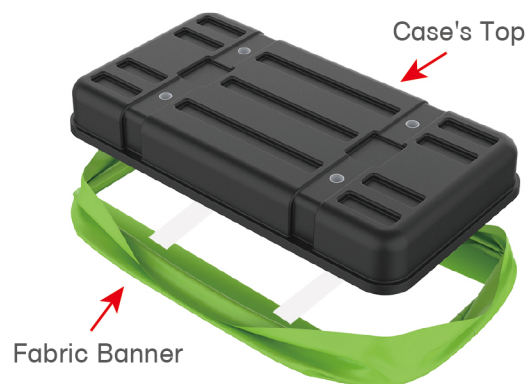

STEP 02

Insert support poles into hard case's top & bottom.

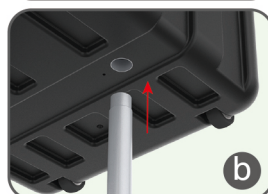
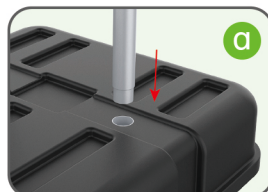
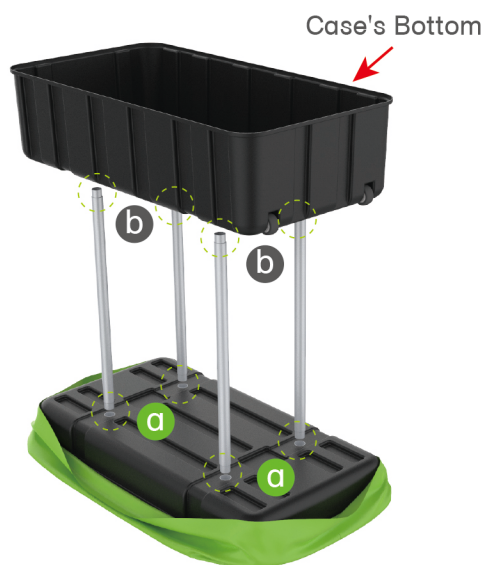

STEPS

STEP 04

Wrap fabric banner from bottom to top & twist it to be smooth, lay hard case's intermediate panel on podium's top.

