

INSTRUCTION

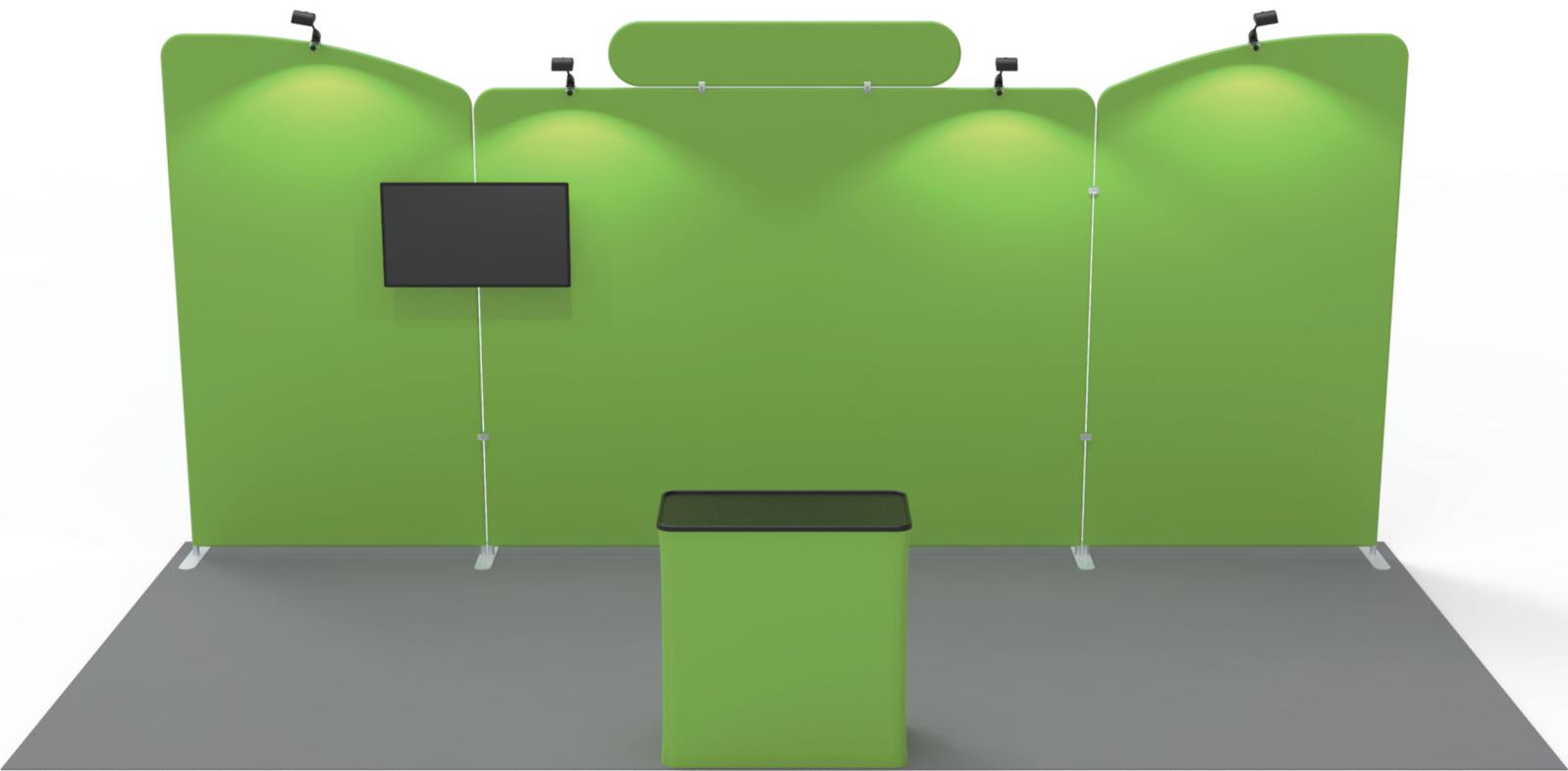

10X20FT-BOOTH-25

STEPS

(1) Hardware

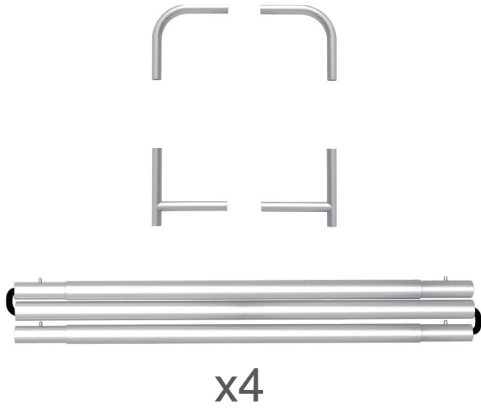

(2) Printed Graphic Fabric Banner (Optional)



STEP 01

Connect to make long poles according to labelings.

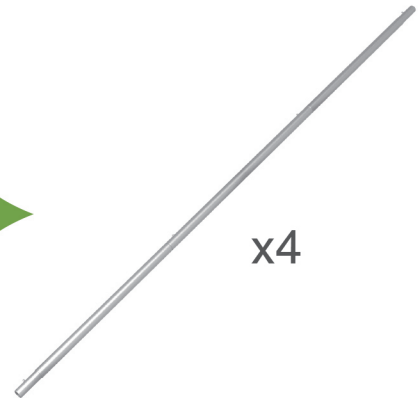
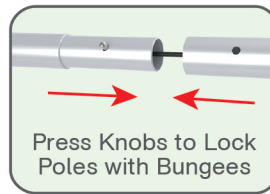
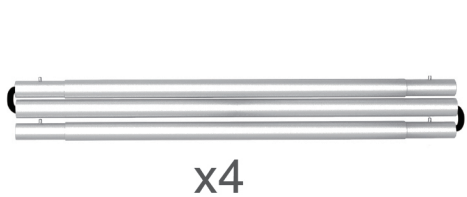

STEP 02

Connect long poles with corner poles according to labelings.

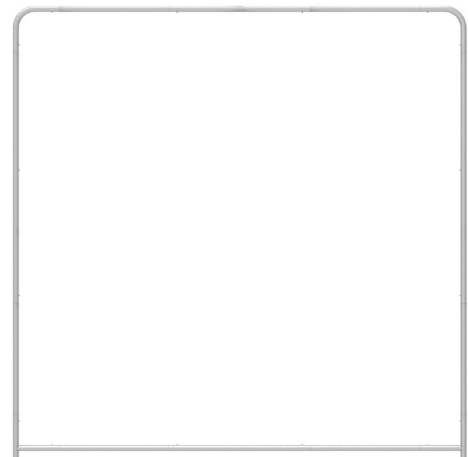
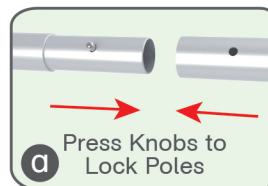
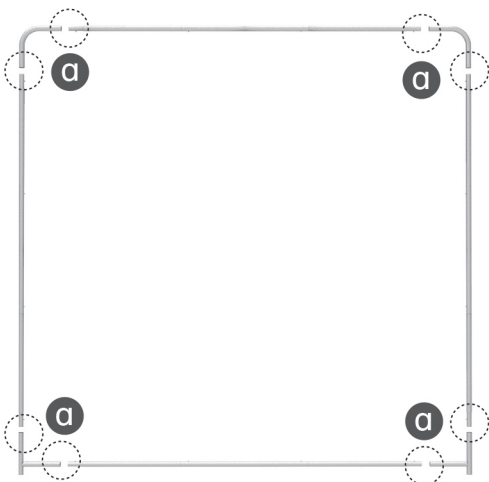

STEPS

STEP 03

Slide fabric banner on frame from top and zip up at bottom.

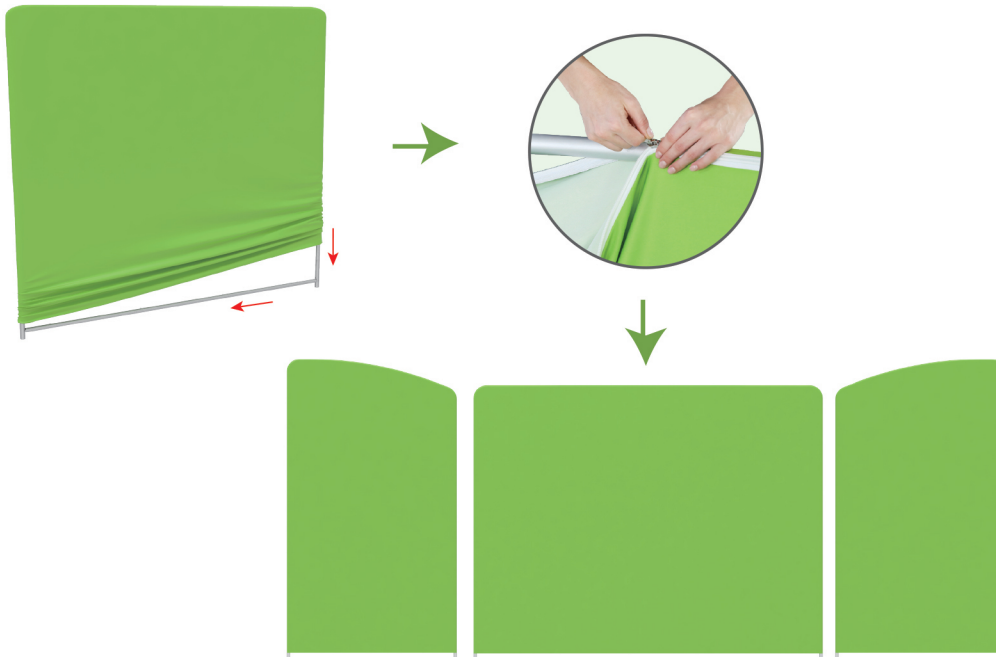

Same Steps for Other Display Stands

(1) Hardware**(2) Printed Graphic Fabric Banner (Optional)****STEP 01**

Connect poles according to labelings.

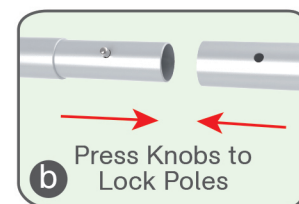
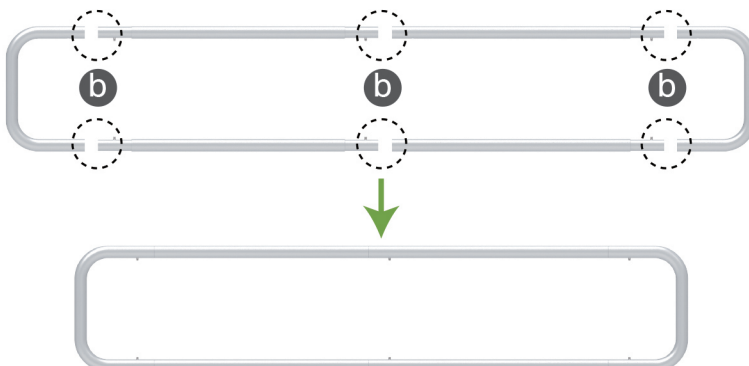

Press Knobs to Lock Poles

STEPS

STEP 02 Slide fabric banner on frame from left and zip up at right.



x2



Booth Set Assembly



(1) Base

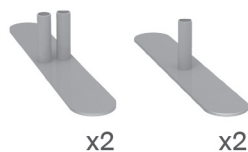

x2

x2

(2) LED Light & Clip



x4

x4

(3) 180° C-Shaped Clip



x6

(4) TV Mount

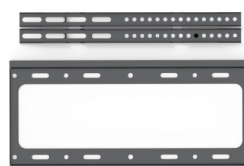

x1

STEPS

STEP 01

Interconnect display stands with C-shaped clips.

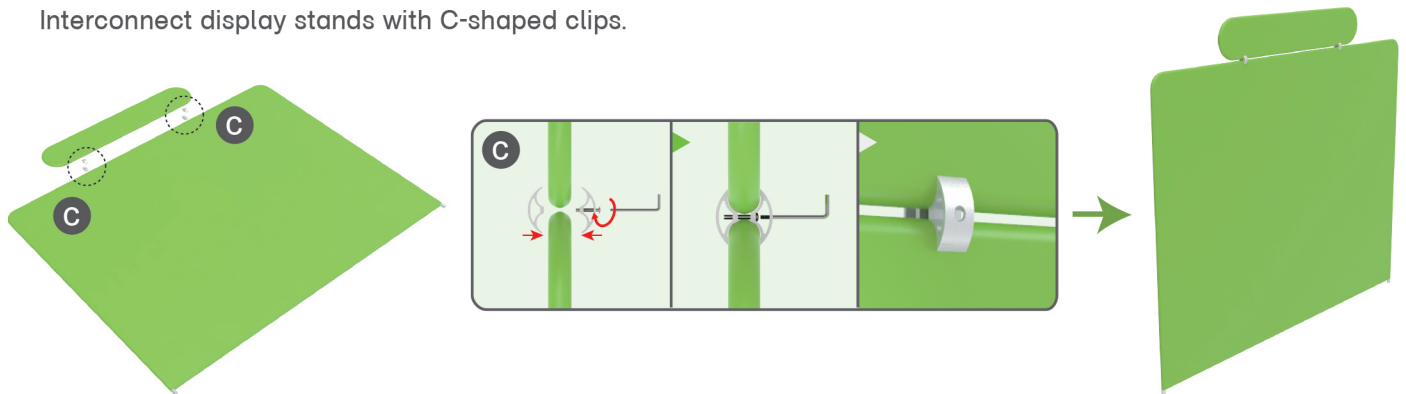

STEP 02

Insert display stands onto feet by pressing their knobs.

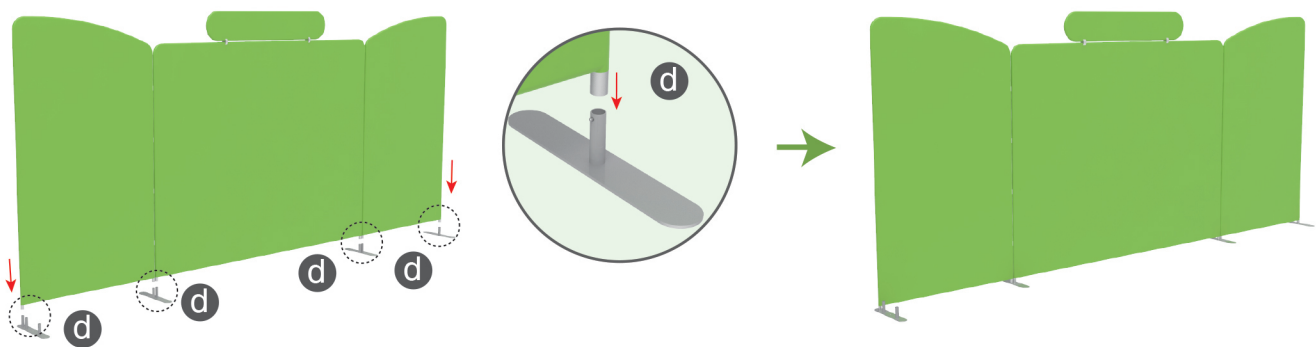

STEP 03

Interconnect display stands with C-shaped clips.

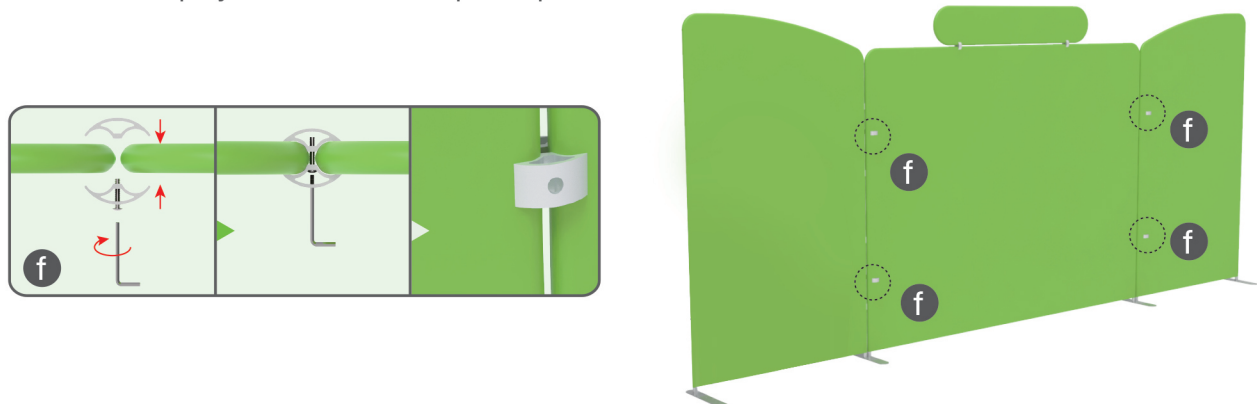

STEPS

STEP 04

Screw TV mount with hex wrench.

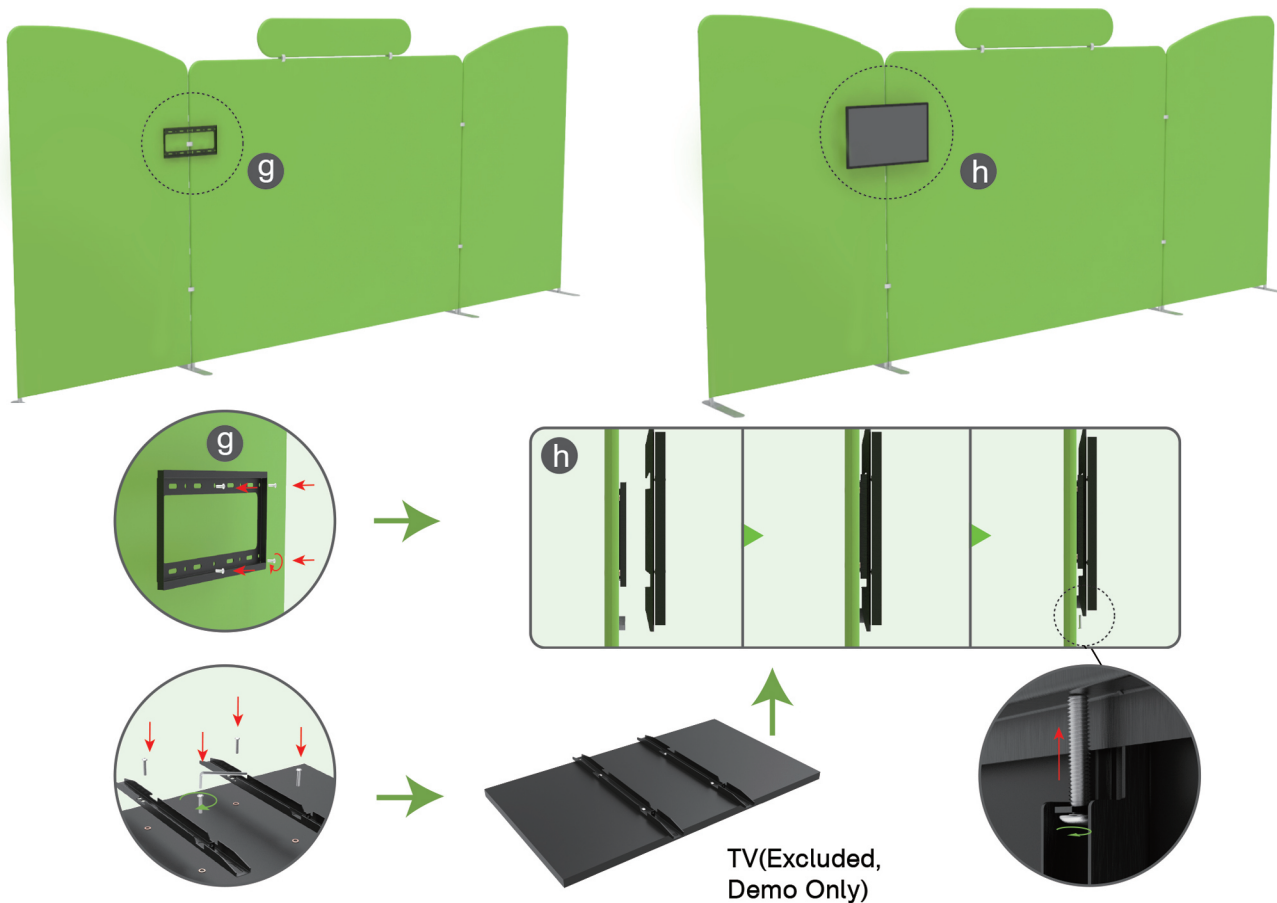

STEP 05

Screw light clips at top of display stands, slide lights onto them and adjust their direction.

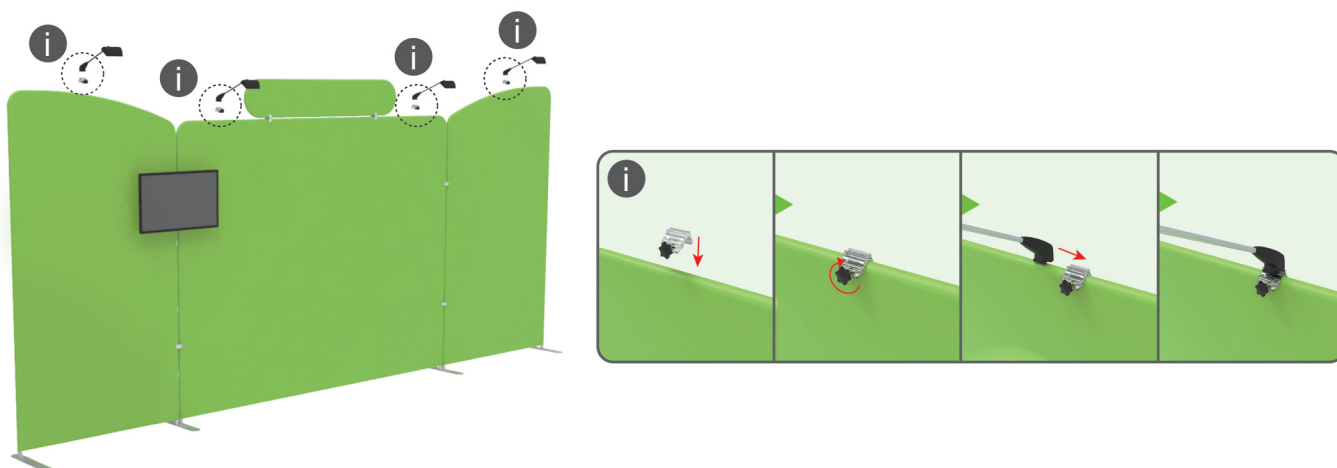

STEPS**10X20FT-BOOTH-25**

STEPS

(1) Durable Plastic Hard Case, Aluminum Support Poles



(2) Printed Graphic Fabric Banner



STEP 01

Put hard case's top into fabric banner.

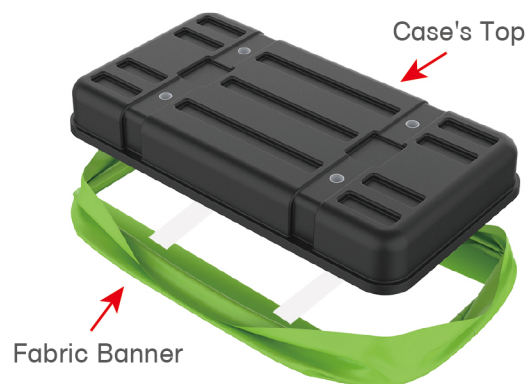

STEP 02

Insert support poles into hard case's top & bottom.

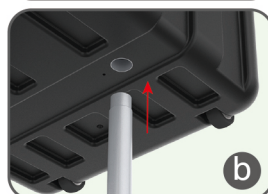
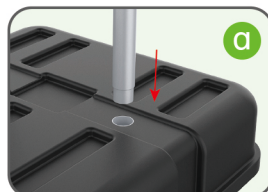
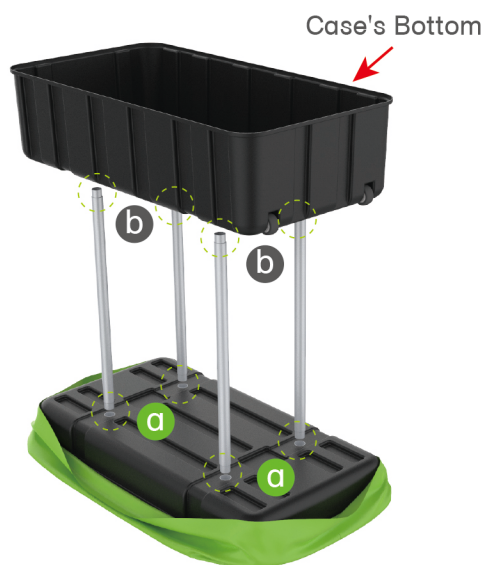

STEPS

STEP 04

Wrap fabric banner from bottom to top & twist it to be smooth, lay hard case's intermediate panel on podium's top.

