

INSTRUCTION

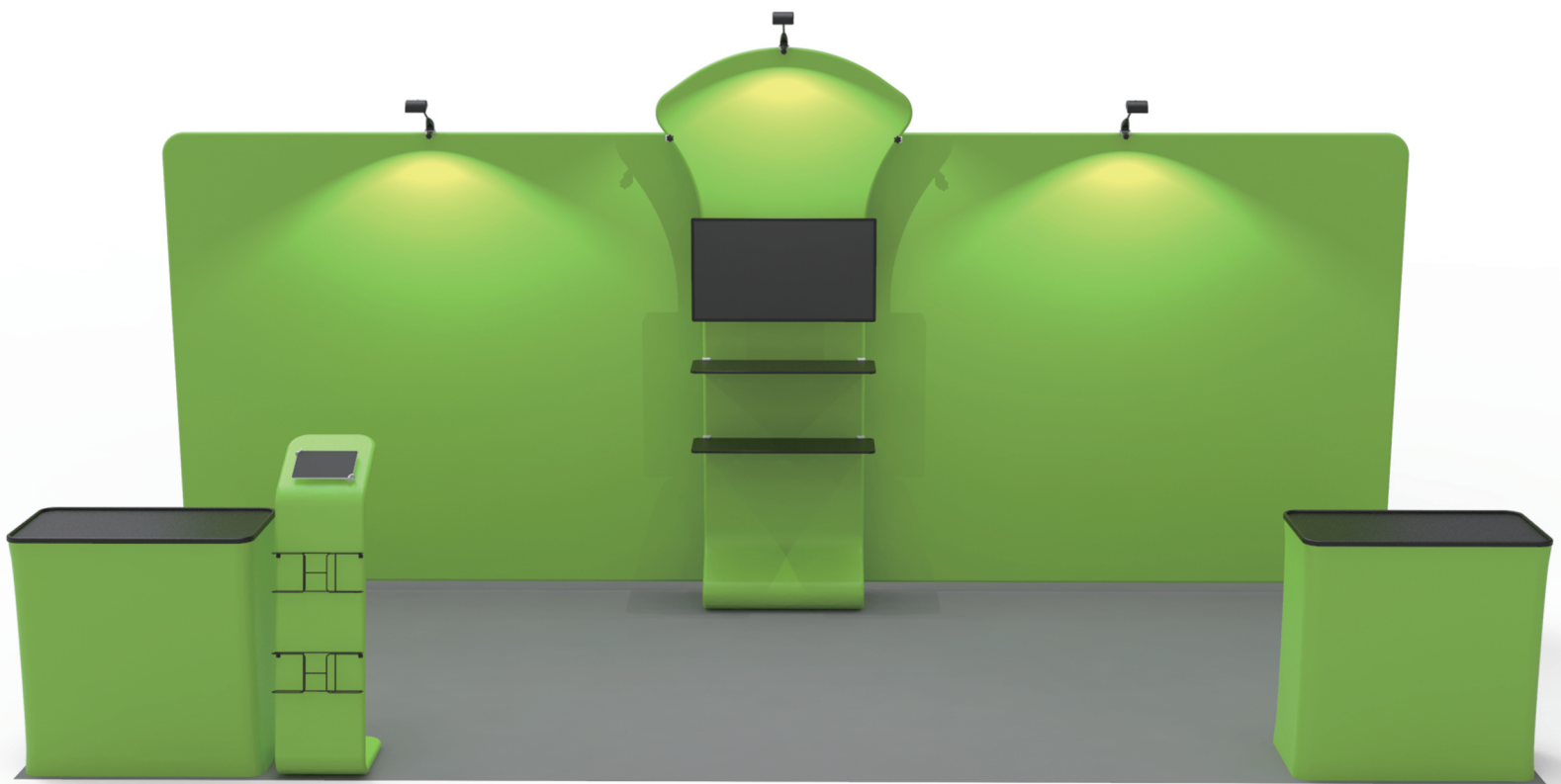

TF-SB-10X20-62

STEPS

(1) Hardware

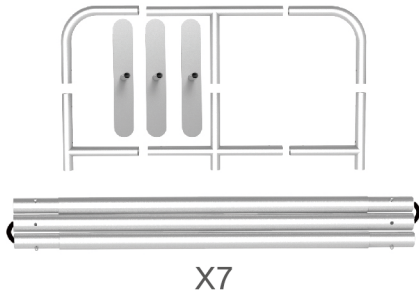

(2) Fabric banner

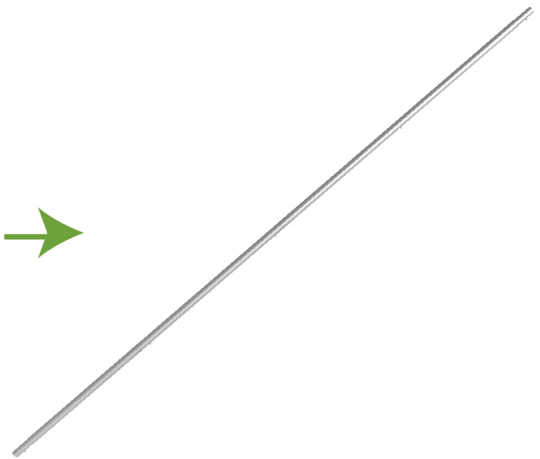
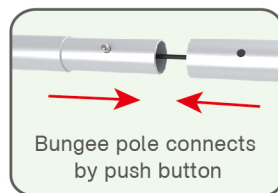
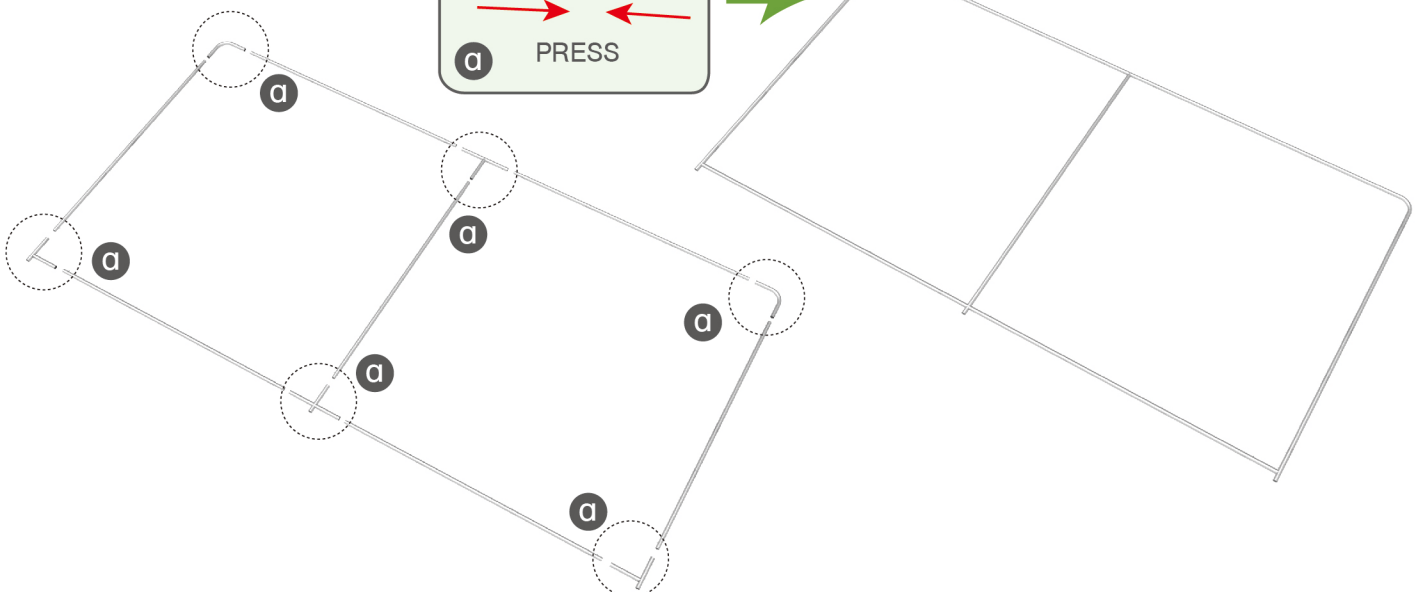
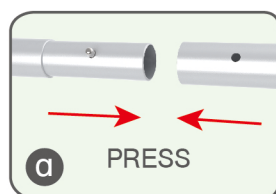

(3) Light Clips

**STEP 01** To connect the poles according to the labellings**STEP 02** To connect the long poles by corner pieces according to labellings and assemble middle upright pole in position.

STEPS

STEP 03 To slide the fabric banner on the frame from top and zip up at bottom

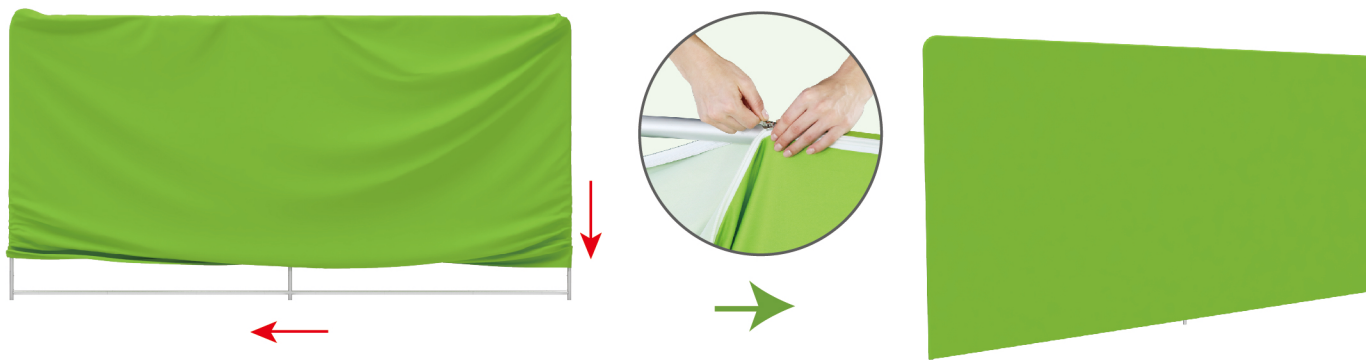

STEP 04 To assemble the stand feet in position

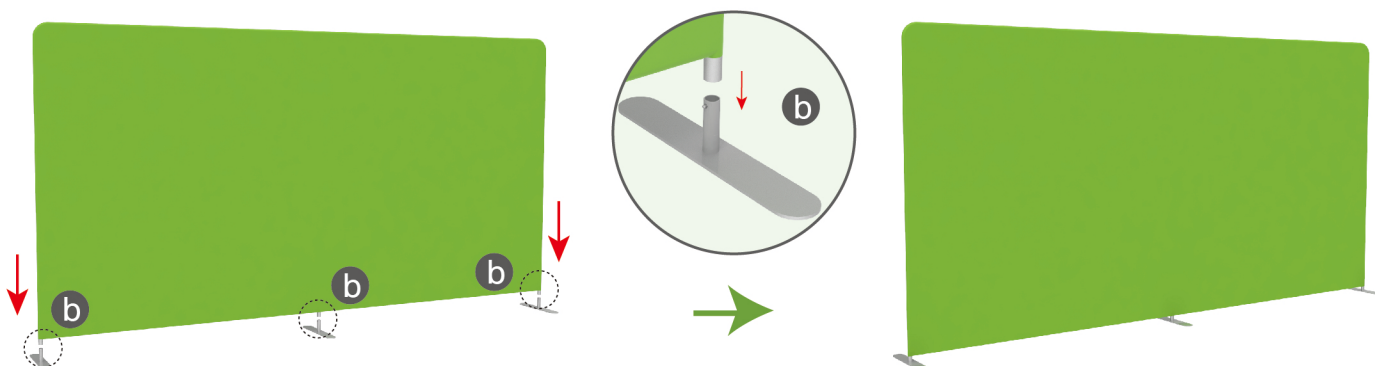

STEP 05 To install the light clip at top of the banner stand and slide the light in position then adjust the light angle. ***LED Lights are optional***

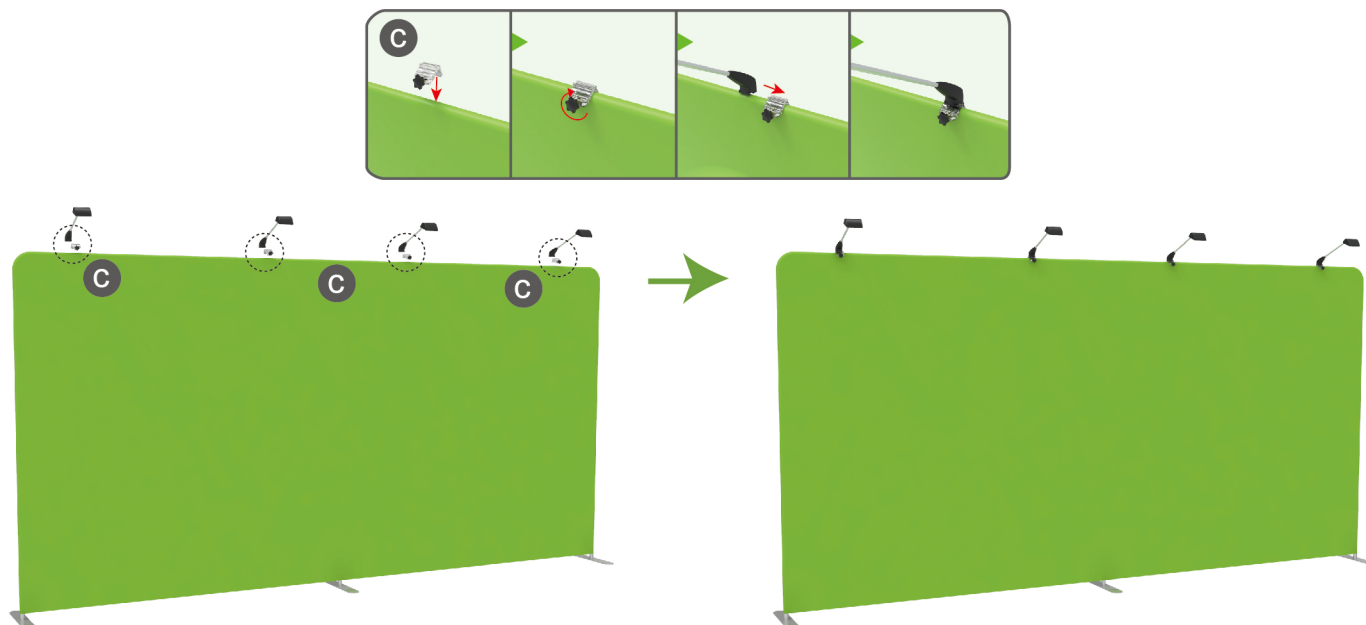

★ One Tool (Hex Wrench) **STEPS**

(1) Hardware

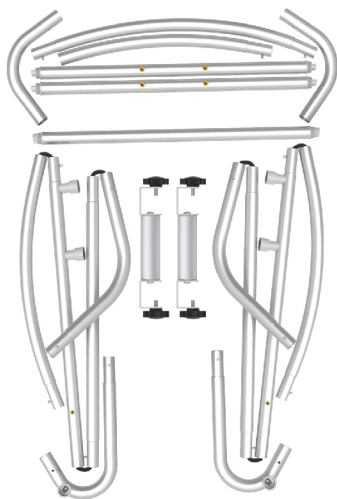

(2) Fabric banner



(3) shelves and bracket set

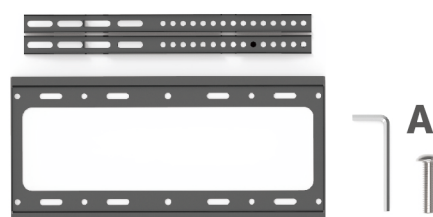

(4) TV mount and screw bag

**STEP 01**

To connect the poles according to the labellings

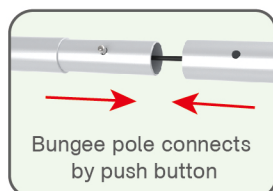
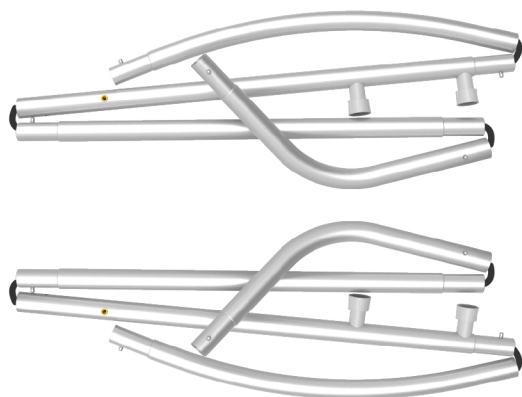

STEPS

STEP 02

To connect the poles according to the labellings

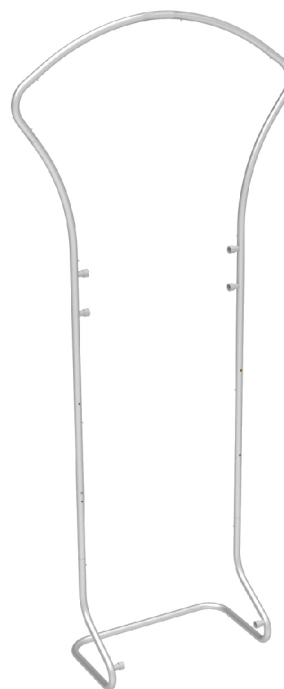
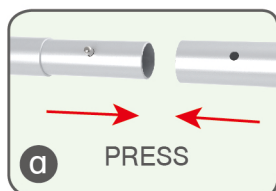

STEP 03

To install cross bars in position

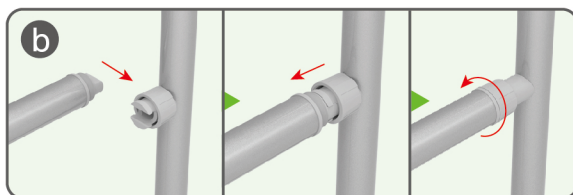
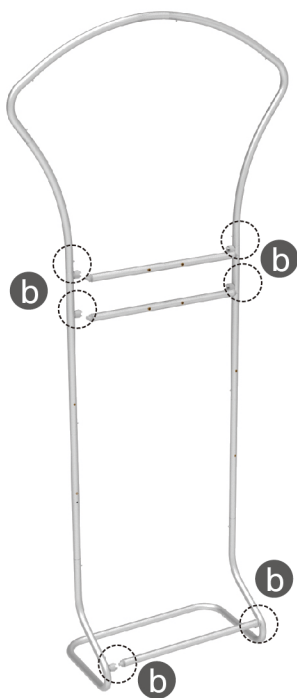

STEPS

STEP 04

To wrap the fabric from bottom to top and zip up

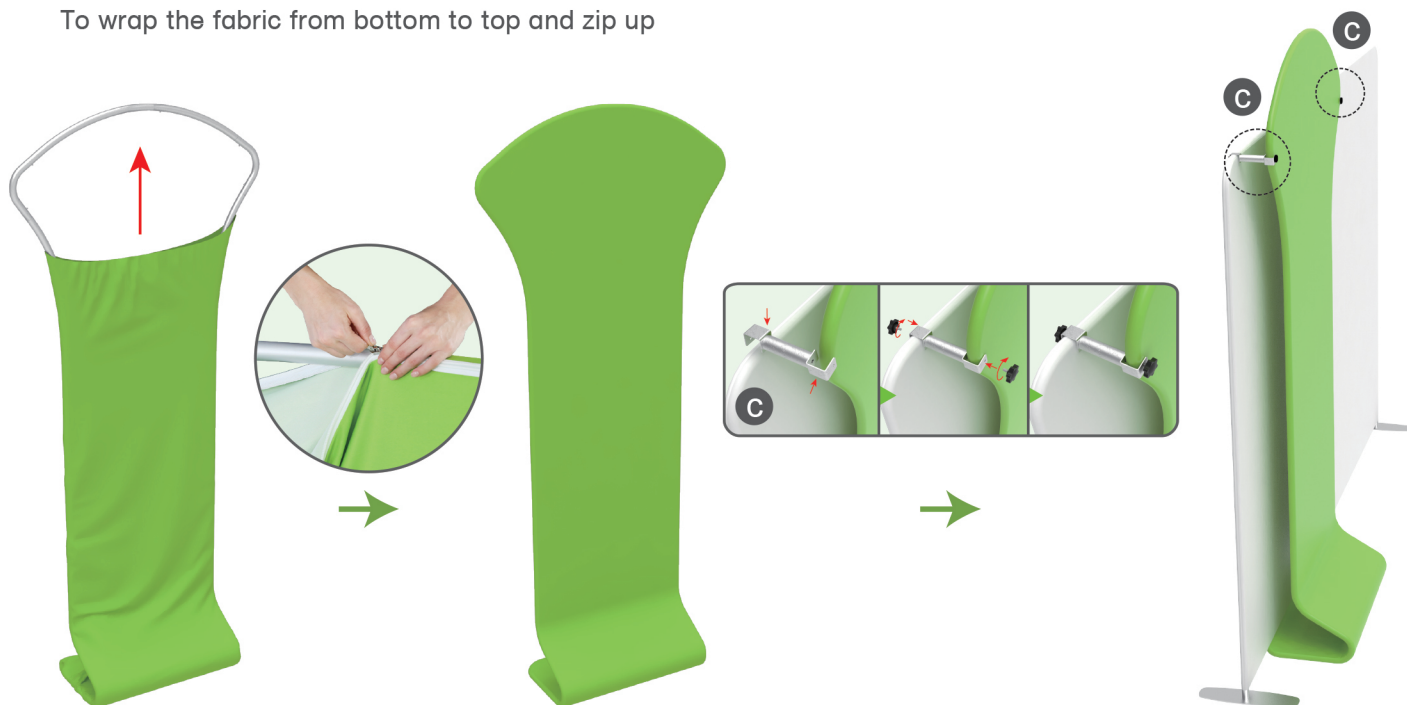

STEP 05

To install the TV mount onto the stand and put the support brackets at the back of TV screen, then hang whole set of TV screen onto the TV mount.

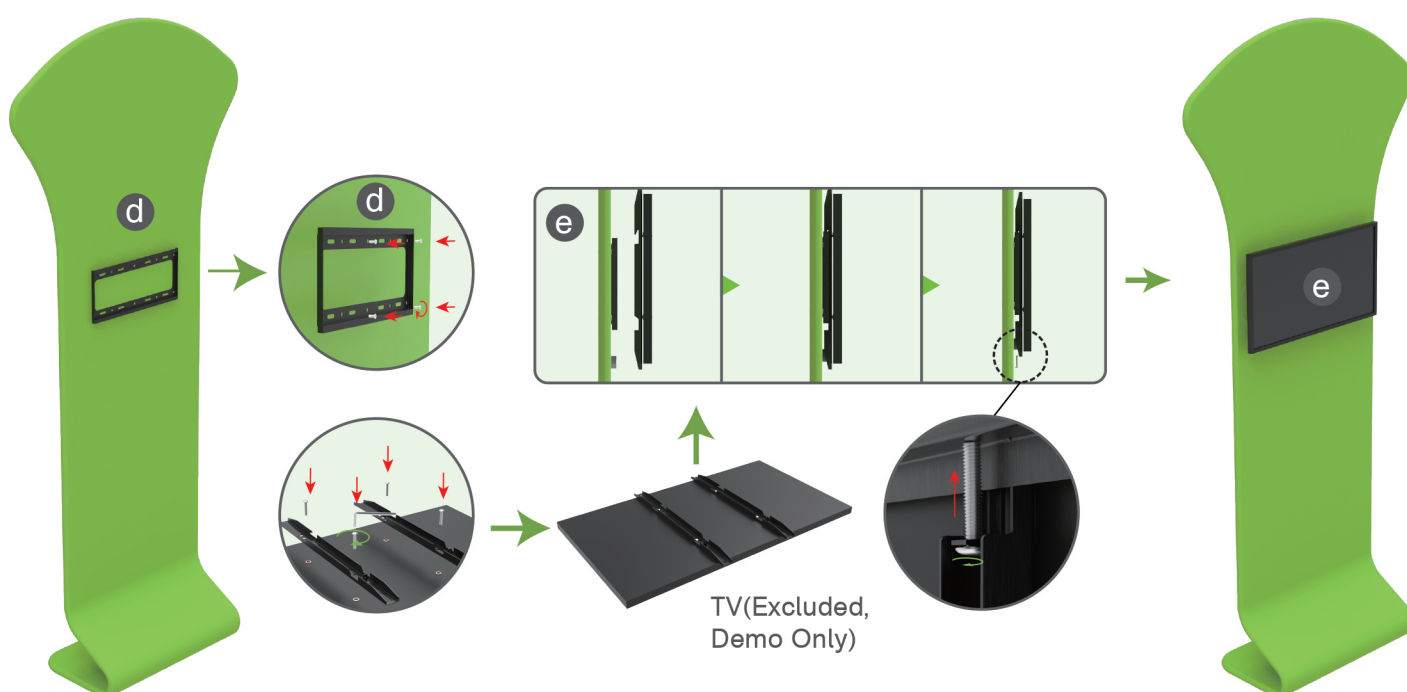

STEPS

STEP 06

To install the shelves brackets in position then put shelves in place

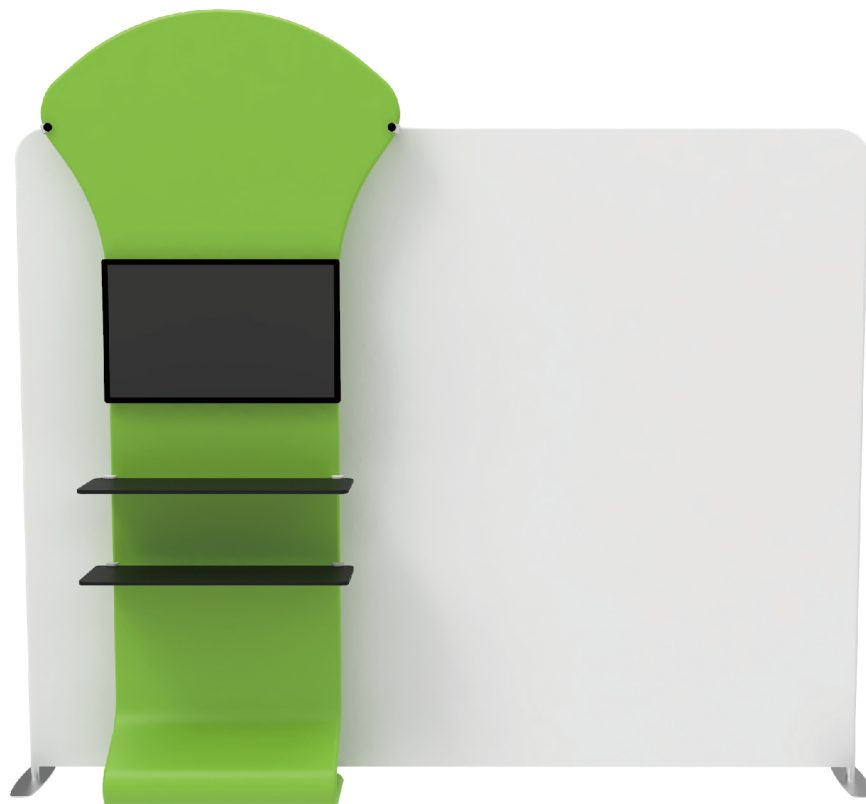
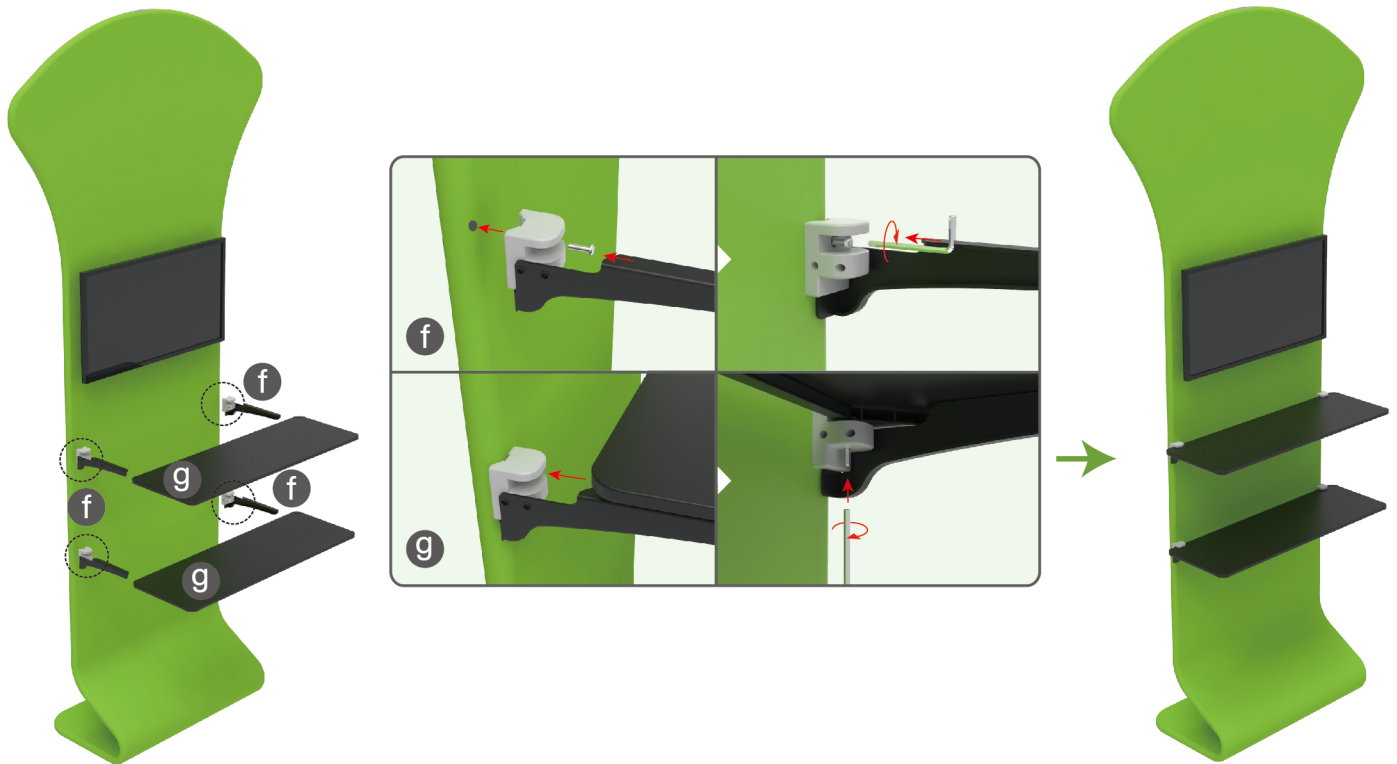

★ One Tool (Hex Wrench) **STEPS**

(1) Snap Tubes

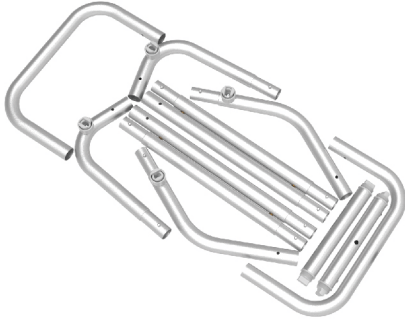

(2) Printed fabric banner

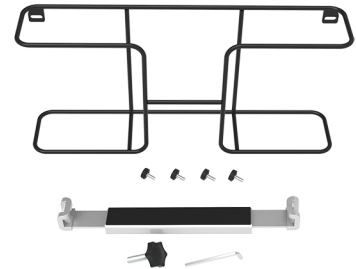
(3) Brochure rack x 2 / Screws x 4
Tablet PC holder x1**STEP 01**

To Connect the tubes according to the labellings

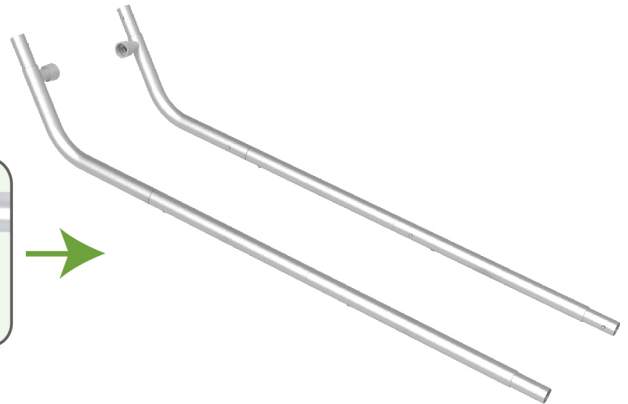
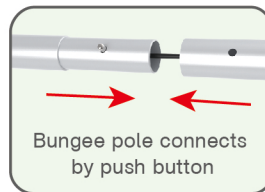
**STEP 02**

To connect 2 long side tubes by the corner pieces

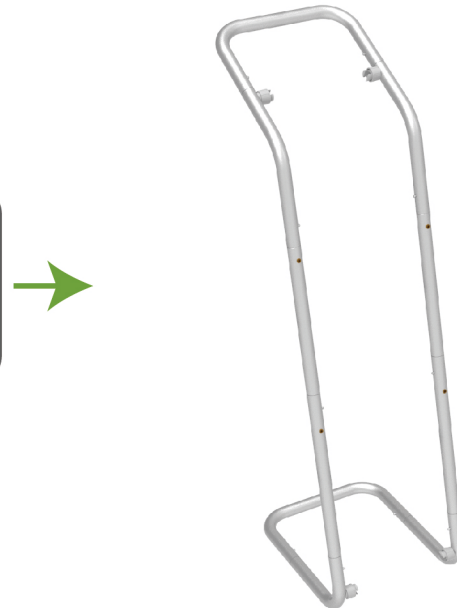
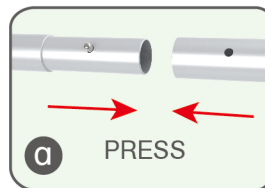
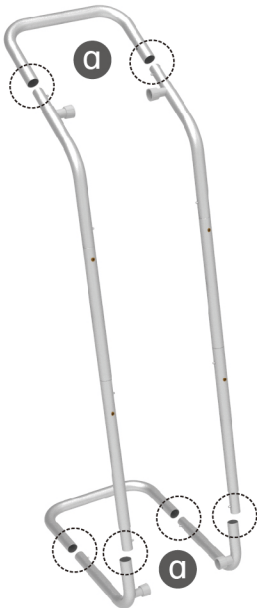

STEPS

STEP 03

To install the cross bar according to labellings

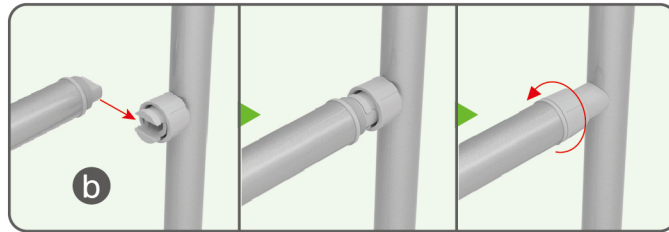

STEP 04

To wrap the fabric from top to the middle of frame, then put the iPad in the holder and adjust the holder to right size and lock it by Allen Key Afterwards, install the set to the display stand.

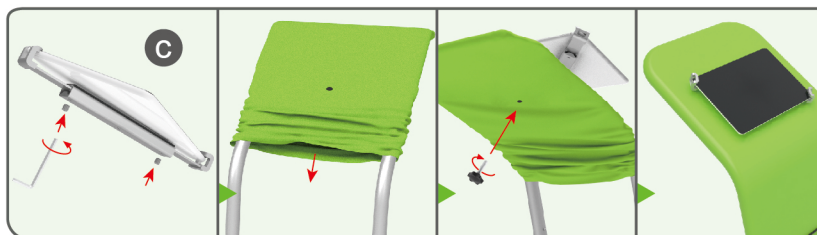

STEPS

STEP 05

To pull the fabric banner to bottom and zip up.



STEP 06

To Install 2 racks by screws in position

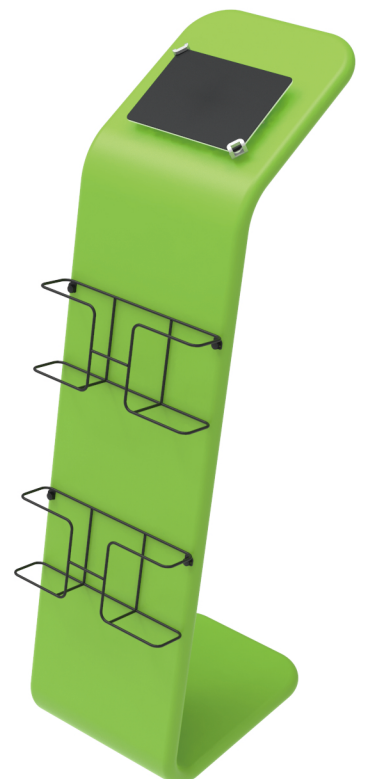
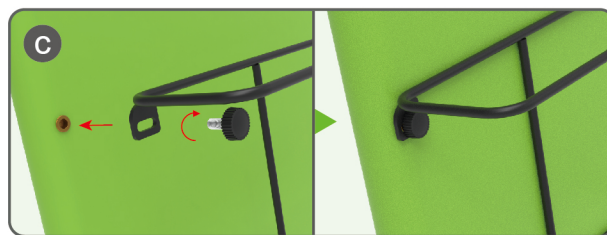
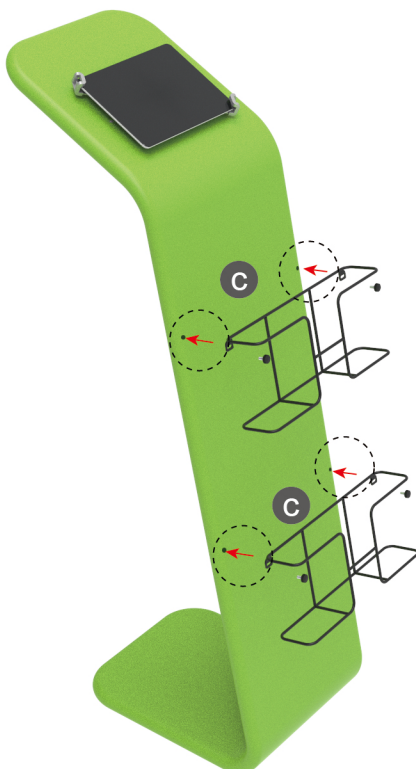

STEPS

(1) Durable Plastic Hard Case, Aluminum Support Poles



(2) Printed Graphic Fabric Banner



STEP 01

Put hard case's top into fabric banner.

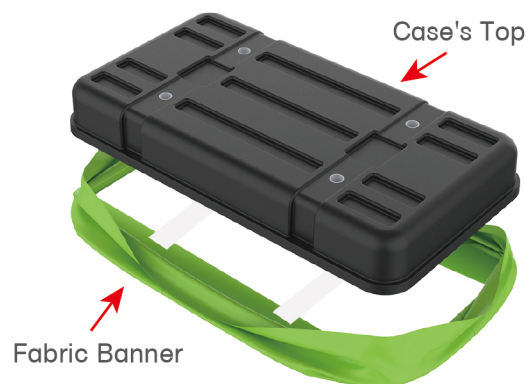

STEP 02

Insert support poles into hard case's top & bottom.

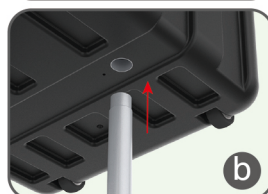
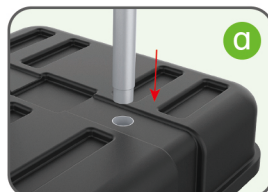
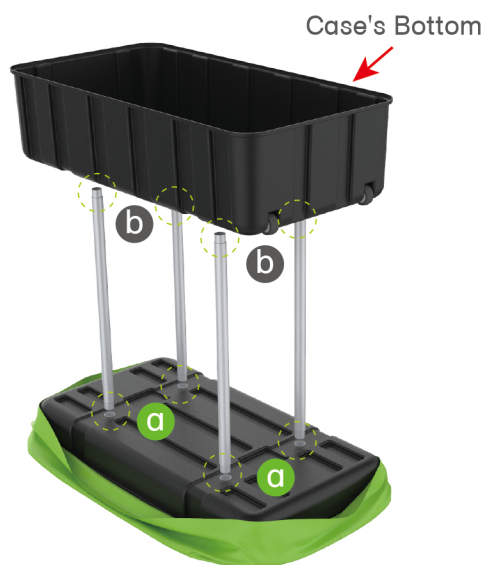

STEPS

STEP 04

Wrap fabric banner from bottom to top & twist it to be smooth, lay hard case's intermediate panel on podium's top.

