

INSTRUCTION



TF-SB-10X20-57

STEPS

(1) Hardware

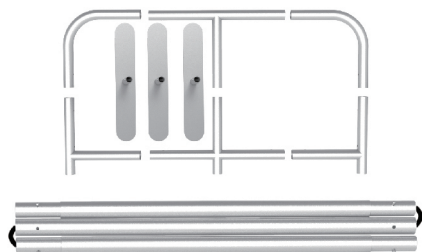

X7

(2) Fabric banner

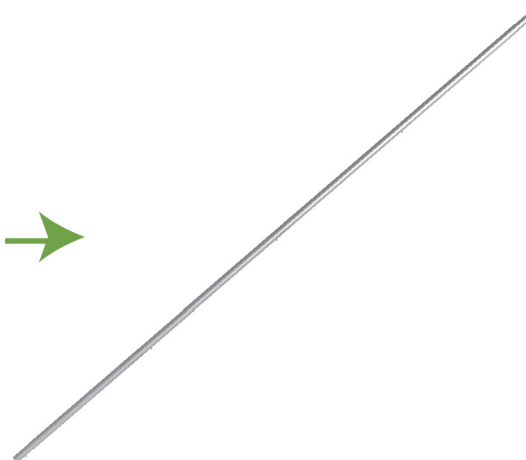
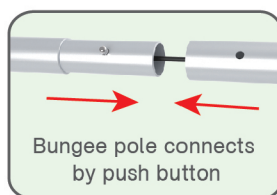
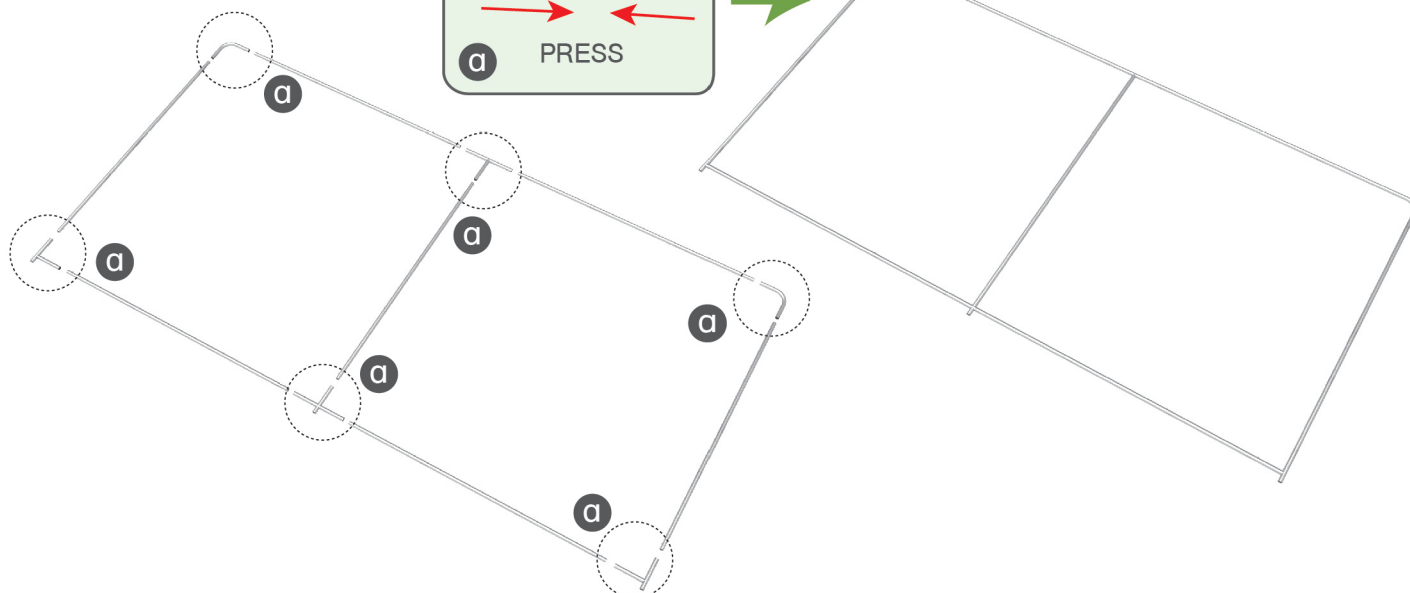
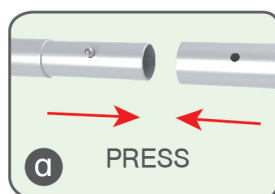

(3) Light Clips

**STEP 01** To connect the poles according to the labellings**STEP 02** To connect the long poles by corner pieces according to labellings and assemble middle upright pole in position.

STEPS

STEP 03 To slide the fabric banner on the frame from top and zip up at bottom

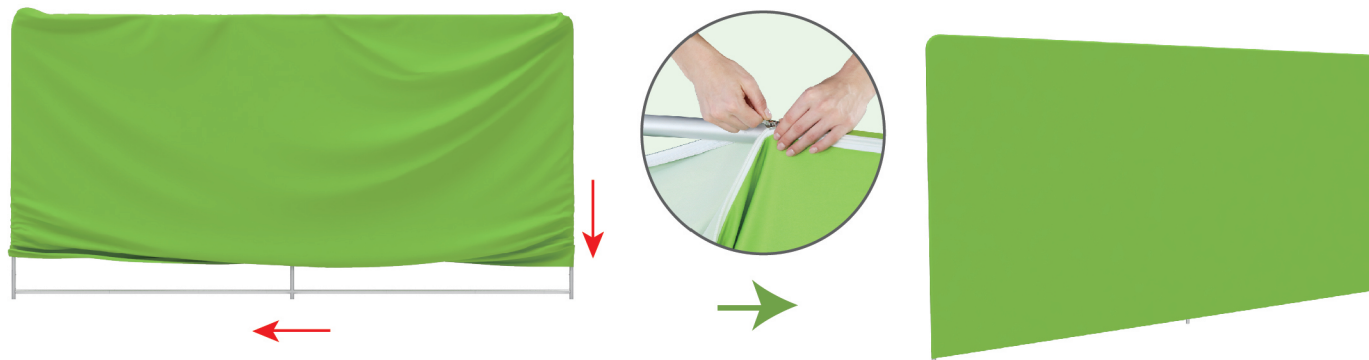

STEP 04 To assemble the stand feet in position

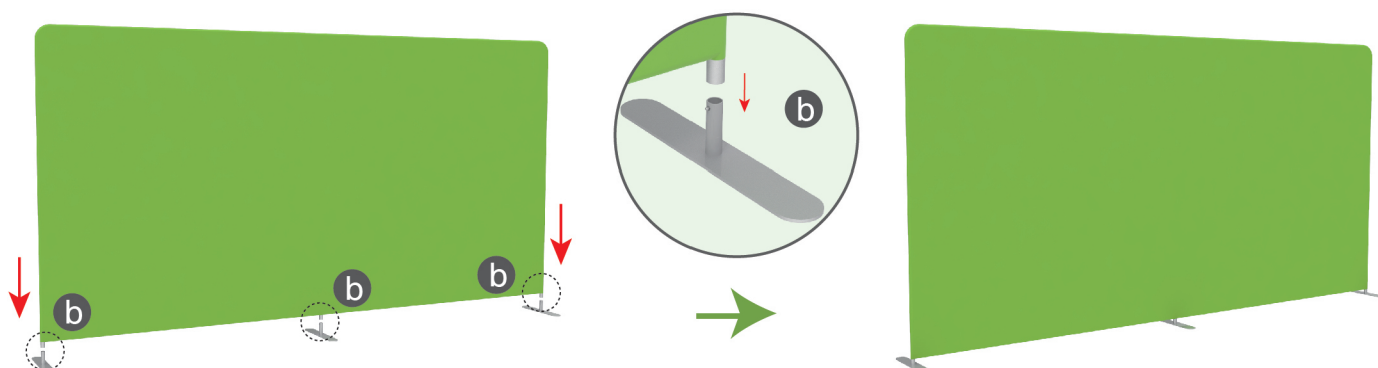

STEP 05 To install the light clip at top of the banner stand and slide the light in position then adjust the light angle. ***LED Lights are optional***

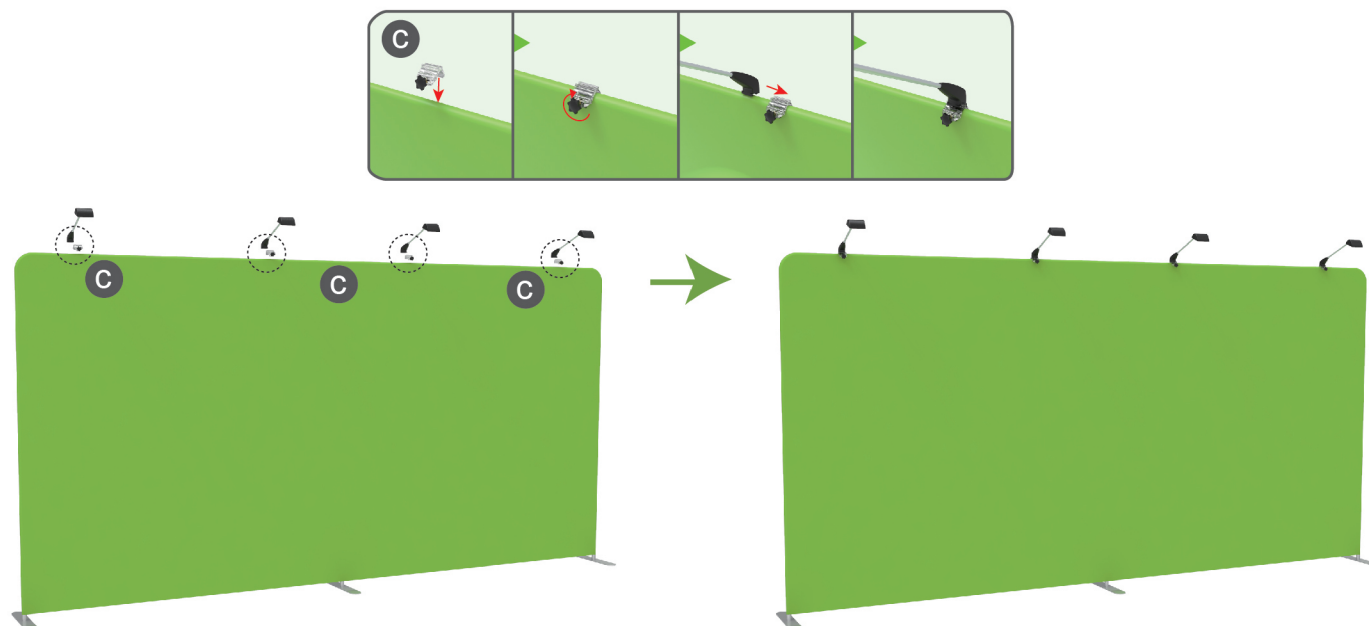

STEPS

(1) Hardware



(2) Graphic printing fabric banner



STEP 01

To connect the poles according to the labellings

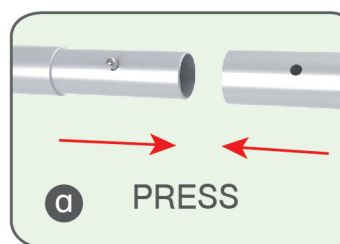
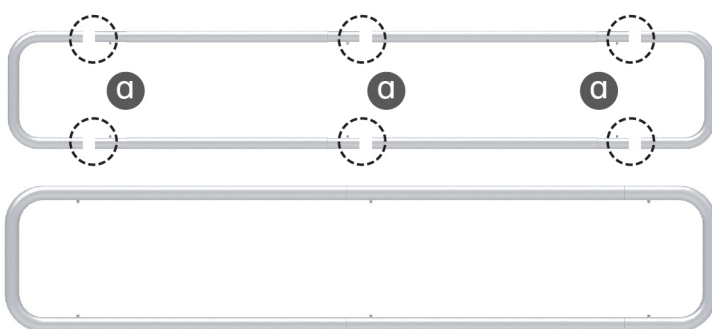

STEP 02

To wrap up the fabric banner from side to side and zip up



STEP 03 Interconnect display stands with C-shaped clips.

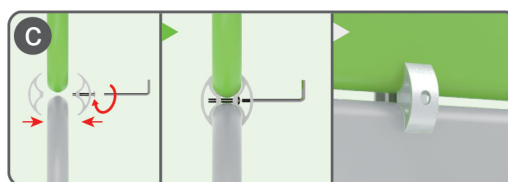
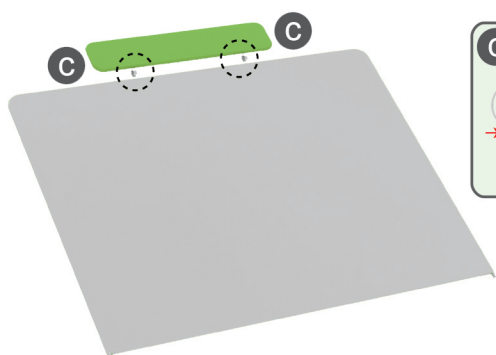

★ One Tool (Hex Wrench) **STEPS**

(1) Hardware



(2) Printed Graphic Fabric Banner (Optional)



(3) Shelf & Bracket

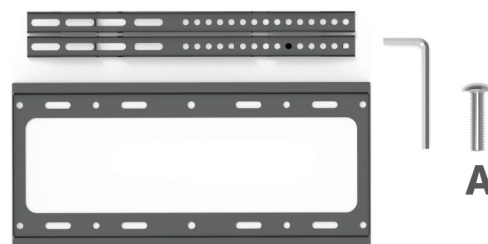

(4) TV Mount & Screw

**STEP 01**

Connect to make long poles according to labelings.

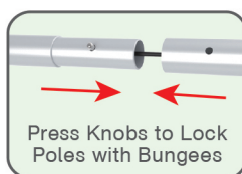
**STEP 02**

Connect long poles with corner poles according to labelings, install cross bars in position.

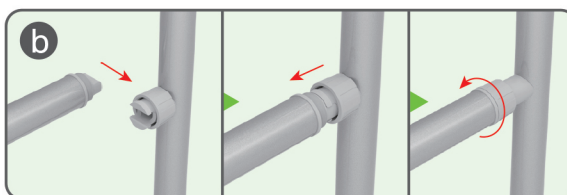
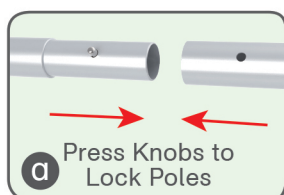

STEPS

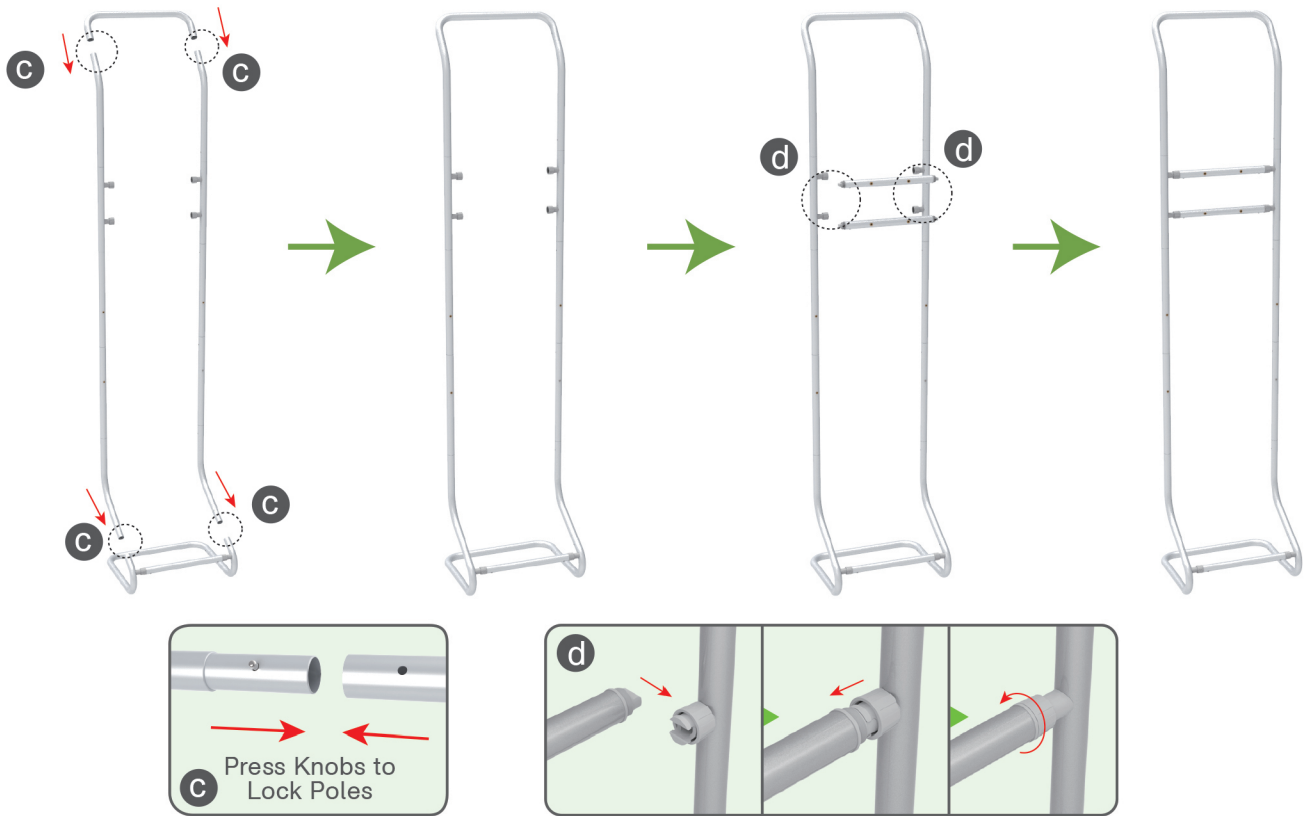

STEP 03

Slide fabric banner on frame from top and zip up at bottom, interconnect display stands with C-shaped clips.

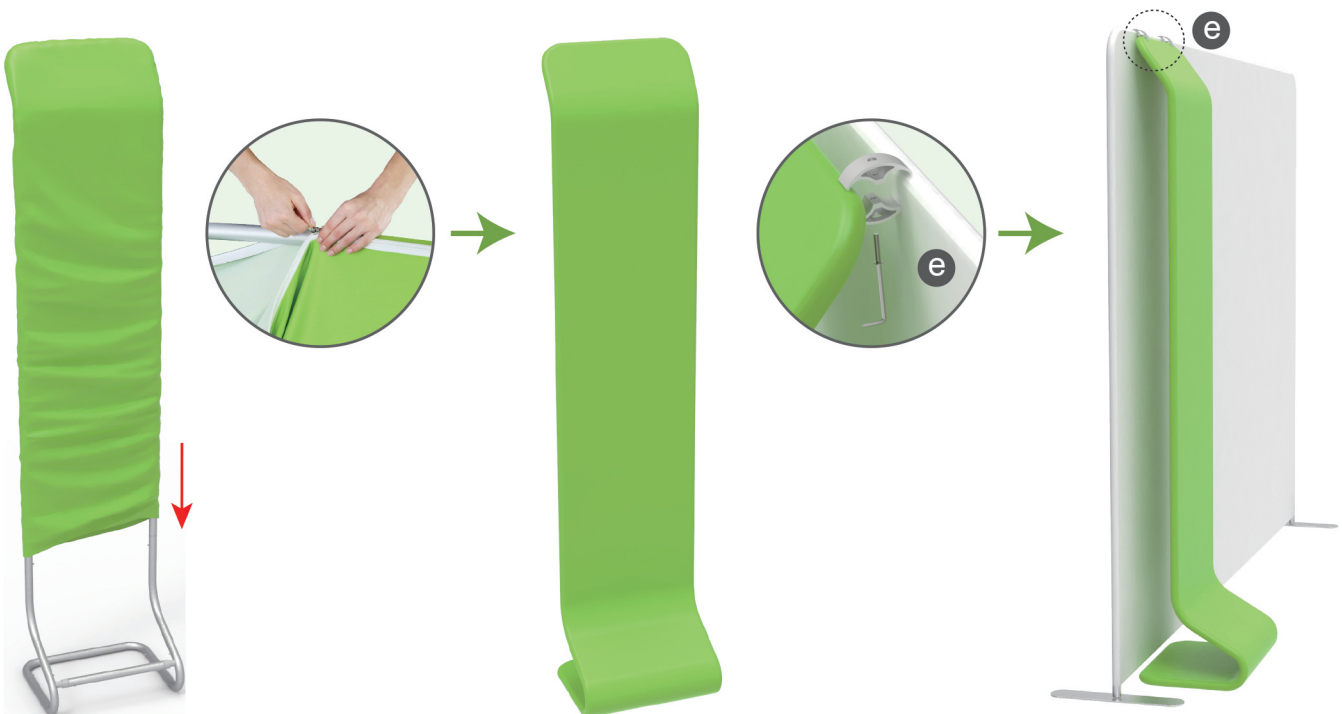

STEPS

STEP 04

Screw TV mount onto display stand & support brackets onto TV's back with hex wrench, hang TV onto mount & screw.

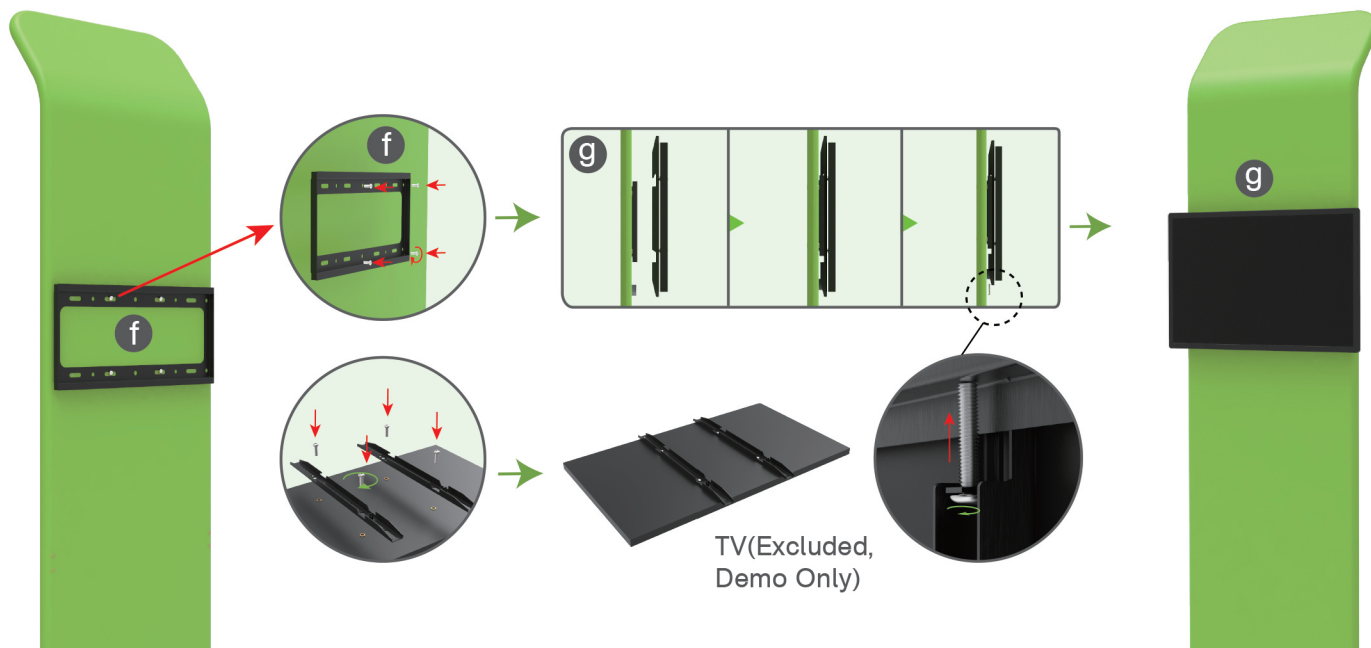

STEP 05

Screw brackets onto display stand with hex wrench, insert shelves into slots.

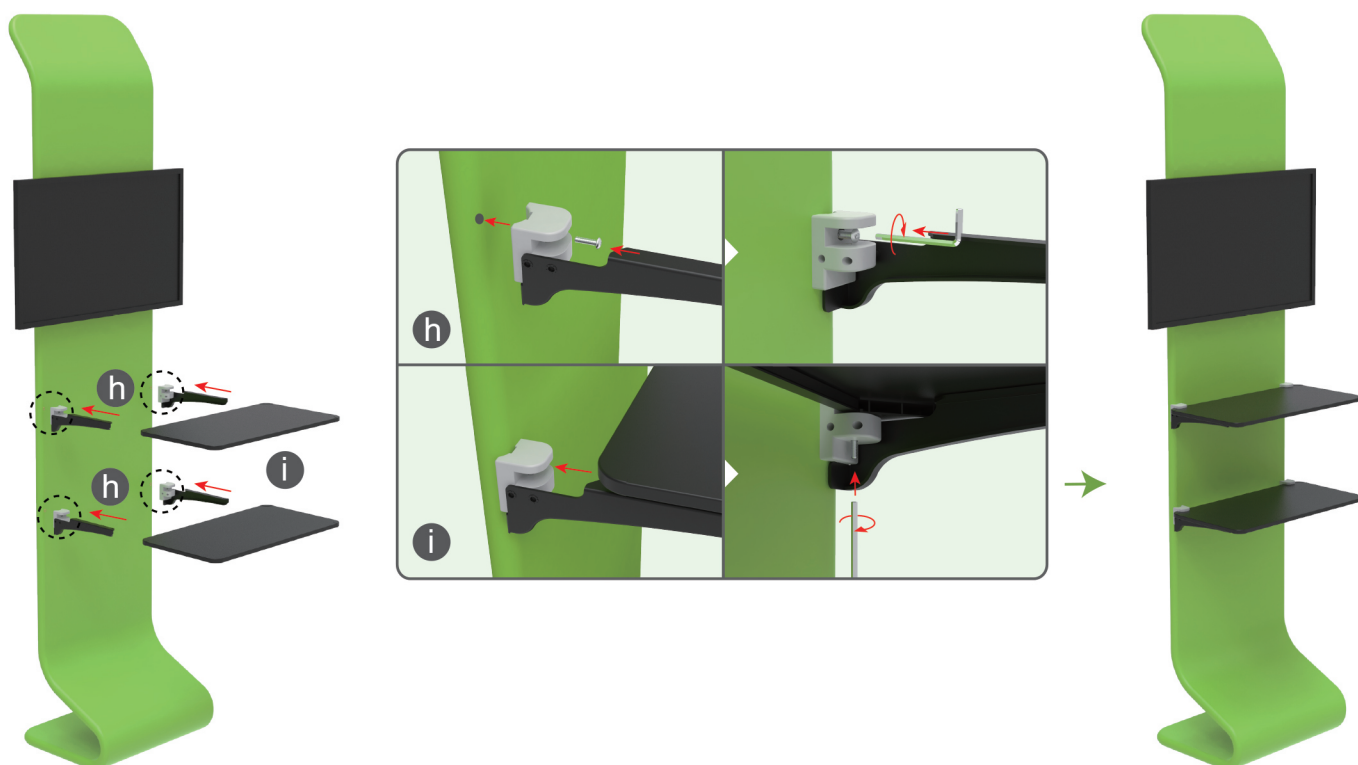

STEPS

(1) Durable Plastic Hard Case, Aluminum Support Poles



(2) Printed Graphic Fabric Banner



STEP 01

Put hard case's top into fabric banner.

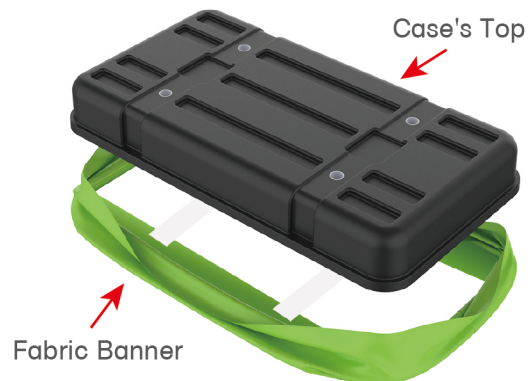

STEP 02

Insert support poles into hard case's top & bottom.

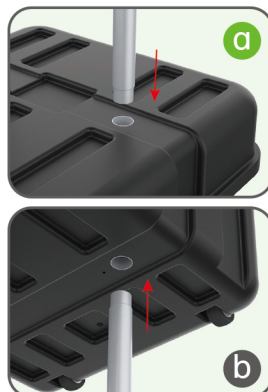
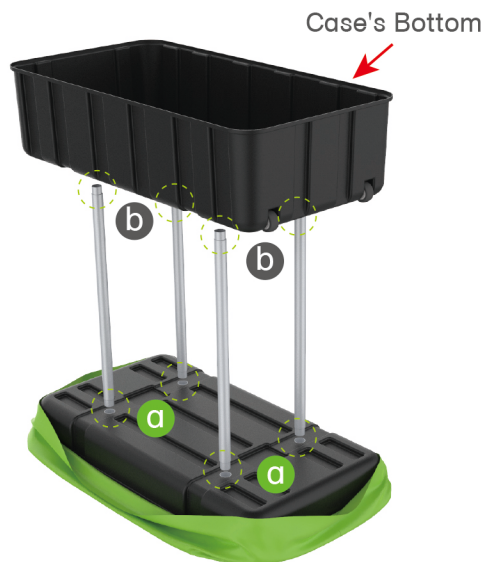

STEPS

STEP 04

Wrap fabric banner from bottom to top & twist it to be smooth, lay hard case's intermediate panel on podium's top.

